

Specializing in LIGHT BIRTHWEIGHTS *with* GREAT PERFORMANCE *plus* REMARKABLE COWS

12TH ANNUAL
ULRICH
HEREFORDS
Bull Sale



FEBRUARY 20
2018

TUESDAY
1:00PM MST
BALOG AUCTION
LETHBRIDGE

48
12

REGISTERED 2 YEAR OLD
& LONG YEARLING BULLS
REPLACEMENT HEIFERS

ULRICH HEREFORD RANCH INC.

Peter Ulrich 403-625-1036 Hans & Annette Ulrich 403-625-2237 Email peter@ulrichherefords.com

www.ulrichherefords.com



12th Annual
ULRICH HEREFORDS
BULL SALE

48 HEAD ON OFFER!

48 Coming Two & Long Yearling Hereford Bulls

FEBRUARY
20

BALOG AUCTION • LETHBRIDGE, ALBERTA

Sale Time: 1:00 pm (MST) Join us for Lunch: 11:30 a.m.

SALE DAY PHONES:

Balog Auction - 403-320-1980

Peter's Cell - 403-625-1036

SALE STAFF:

Bob Balog..... Auctioneer..... 403-320-1980

Louis Balog..... Ring Staff..... 403-320-1980

Lander Nicodemus..... Ring Staff..... 307-421-8141

ACCOMMODATIONS:

Ramada Inn..... 403-380-5050

2375 Mayor Magrath Drive S. - mention Balog Auction for special room rate

VIEWING THE BULLS:

We welcome you to stop by the ranch any time prior to Sale Day to view our operation and see the bulls.

PLEASE JOIN US EARLY SALE DAY:

For presale viewing followed by lunch at 11:30 a.m.

Can't make it to the sale?
Internet Bidding Available.

To view this sale visit www.dlms.ca, Fill out the registration form located under registration and sign-up for your free user account and select a username and password.

BIDDERS - To be approved as a bidder, Log in to dlms.ca and click BUYER APPROVAL tab, select the sale you are interested in bidding at and click sign up.

For more information

Call DLMS Reps:

Whitney Bosovich 780.991-3025

Mark Shologan 780.699.5082

DLMS
www.dlms.ca

SPECIAL POINTS TO NOTE:

- **No bulls sell at Calgary or Medicine Hat** - *All of our best are in this sale!*
- All bulls are semen tested before sale
- **Credit of \$150** per bull to purchasers who take bulls from the sale.
- **Delivery:** Delivery to central points in Alberta at seller's convenience. Out of province purchases delivered by commercial hauler at shared cost.
- We strongly recommend that bulls be insured - an insurance agent will be available at the sale.
- **Flying In?** If flying into the Lethbridge Airport, call Balog Auction for pick-up: 1-403-320-1980.
- **Ultrasound Information** has been collected on most of these bulls as yearlings and will be available sale day or can be obtained prior to the sale by calling Peter at 403-625-1036. *Complete EPDs* (beyond those shown in this catalogue) are also available.

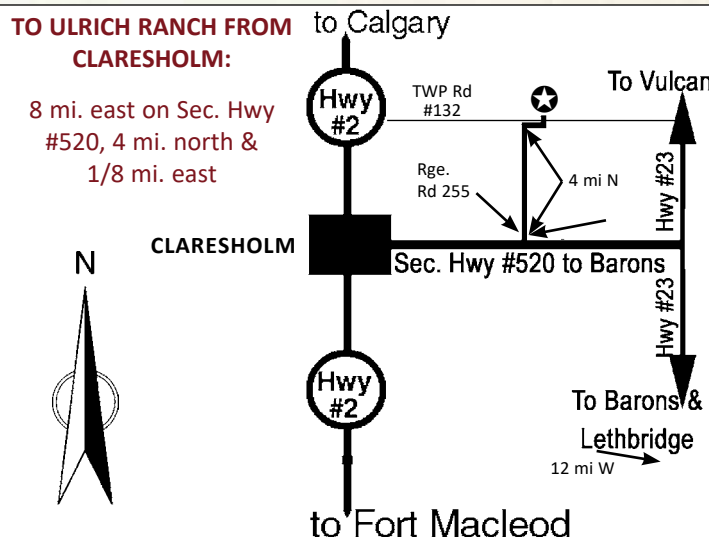

ULRICH HEREFORD RANCH INC.

Box 843, Claresholm, AB T0L 0T0

Peter Ulrich: 403-625-1036

Email: peter@ulrichherefords.com

Hans & Annette Ulrich - Ph: 403-625-2237

★ ★ ★
Sight Unseen Purchase Plan:

If you are unable to attend the sale, please contact us or any of the sale staff with instructions to purchase on your behalf.



UHRi

WELCOME to

ULRICH HEREFORD RANCH

12TH ANNUAL BULL SALE



Peter Ulrich
Cell: 403-625-1036



Hans & Annette Ulrich
PH: 403-625-2237

We're really pleased to be able to present this functional set of 42 coming two-year-old bulls & 6 long yearlings for you this year!

It was a super challenging year in 2017 with near-drought-like conditions. We had so little rain this summer that the grass turned a sickly white and rummaging up enough pasture/hay/silage to keep everyone fed took the fun out of watching the youngsters grow!

Back in 2016, we changed our tattoo letters from the originally assigned "ALNK" to simply "U" for Ulrich! It's a lot less ink to work in at tattooing time, plus it makes web searches a breeze. For any of our sale animals simply search by tattoo U, space, then number & year letter. i.e. U 4D on the Animal Inquiries at hereford.ca.

While we didn't put as many bulls of the 2016 calf crop into the RFI test at Olds last year as we have in the past, we did send 20, and were pleased when 14 of them performed above average for Residual Feed Intake (feed efficiency) ...

The CHA has now moved to weekly EPD runs, so any differences between numbers referred to here at cataloguing time may differ slightly on the live results on the CHA website.

We'll keep this short as we are pleased to add 12 bred heifers to the sale and space is limited here in the catalogue! Once again, we are grateful for another year in the biz and look forward to seeing you all on sale day!

Sincerely,

Peter Ulrich and Hans & Annette Ulrich

• BALOG AUCTION SERVICES INC. •

PO Box 786, Lethbridge, Alberta, T1J 3Z6
Phone (403) 320-1980 Fax (403) 320-2660

Fellow Cattlemen,

Welcome to the Peter Ulrich 12th Annual Hereford Bull Sale!

Once again a powerful offering of high performance uniform bulls.

The Ulrich Herd is one of the leading performance & EPD herds in the breed.

Strong emphasis on maternal traits & ease of calving.

Great people who believe in the breed and their cattle.

Respectfully

R.C. (Bob) Balog

PLEASE NOTE

Pictures of the dams of many of the sale bulls, as well as updated sale information and a downloadable version of this catalogue is available at our website:

www.ulrichherefords.com

TERMS & CONDITIONS

TERMS - The terms of the sale are cash or cheque payable at Lethbridge, AB, on Sale Day. The right of property shall not pass until settlement is made. All settlements must be made with the clerks of the sale before any cattle will be released. For US export, USDA and individual state rules will apply.

BIDS - Every animal entering the sale ring will be sold to the highest bidder. A floor price will apply to each animal consigned.

DISPUTES - In case of disputes, bidding will be reopened between the parties involved. If no further bid is made, the buyer will be the person from whom the auctioneer accepted the last bid. The auctioneer's decision in such matters will be final.

PURCHASER'S RISK - Each animal becomes the risk of the purchaser as soon as sold.

ANNOUNCEMENTS - Errors discovered in the catalogue will be corrected by announcements from the Auction Stand at sale time and such corrections will take precedence over the printed matter in the catalogue.

CERTIFICATE OF REGISTRY - A certificate of registry duly transferred will be furnished to the buyer for each animal after settlement is made.

SHIPPING - Assistance will be given in making shipment after the sale, but no risk is assumed by Balog Auction, or the seller. **Delivery to central points in Alberta will be made at seller's convenience.** Out-of-province purchases will be delivered by commercial hauler at shared cost. Any additional expenses are the responsibility of the buyer, including duty, brokerage fees, etc.

BREEDER'S GUARANTEE - The consignors have done everything possible to assure you, the buyer, that every bull in this sale will be a breeder. A certified veterinarian has semen tested and physically evaluated every bull. However, should a problem arise, please inform the seller so further arrangements may be made.

ACCIDENTS - Although every precaution will be taken to protect the safety and comfort of buyers, neither the sales manager, auctioneer nor any owner assumes any responsibility in this matter and disclaims any liability, legal or otherwise, in the event of accident or loss of property.

LIABILITY - Balog Auction is acting as agent only and assumes no responsibility for representations made by the seller. Purchasers must look to the seller for fulfillment of all guarantees and representations made hereunder.

SPECIAL POINTS to REMEMBER:

- No creep feed
- No hormones or medicated feed!
- Backgrounded, not pushed!

KEY TO PERFORMANCE TERMS USED HEREIN:

BW: Actual Birth Weight in Pounds
205: Weaning Weight in lbs adjusted to 205 Days
365: Yearling Weight in lbs adjusted to 365 days
RFI: Residual Feed Intake (feed efficiency)
PWG: Post Weaning Gain (difference between WN & YR)
LMY: Lean Meat Yield

Pictured on front cover: U 86D & 120D

ULRICH HEREFORD RANCH REFERENCE SIREs

A

AGA 20J STANMORE 21M

C02805799 ALNK 21M FEBRUARY 12 2002

BW:	85
205:	674
365:	1095
'18 EPDs	
CE:	+5.3
BW:	+2
WW:	+48.9
YW:	+72.9
MCE:	+10.5
Milk:	+34.9
TM:	+59.4

AGA 4016D STANMORE 121G
AGA 121G STANMORE 20J
AGA 40E MISS STANMORE 80G

XTC 15Z ENERLAD STAN 5C
AGA 5C MISS ENERLAD 68K
AGA 154F MISS BRITISHER 159H

CTY K STANMORE 4016D
AGA 99B CENTENNIAL 51D
AGA 9012 STANMORE 40E
AGA 16B MISS GENERATOR 20E
XTC ENERLAD SELKIRK 15Z
XTC 37Y STAN LASS 82A
AGA 37B BRITISHER 154F
AGA 22B BRIGADER 83F

Top % Of Breed For: CE 25%, BW 25%, MILK 5%, TM 10%, MCE 1%, New SCF (Sustained Cow Fertility) 1%, MARB 5%
21M ranks in the top % of the Hereford breed (see above) in many traits, including 2 in the top 1%!! He produces offspring with lots of vigor at birth & excellent performance that we & others are very proud of (like 8D, selling in this sale, who performed great in WW & YW and daughters like 45B, who produced 73D in this sale). In the recent Corbiell dispersal, the 21M progeny sold very well for both cows & bull calves. Lot 8D



SIRE A

B

AGA 114L GENERAL WILEY 24W

C02931573 ALNK 24W MARCH 11 2009

BW:	70
205:	714
365:	1081
'18 EPDs	
CE:	+8.5
BW:	+1.9
WW:	+29.4
YW:	+53.4
MCE:	+2.9
Milk:	+26.2
TM:	+40.9

GEM GENERAL 13G
AGA 13G GENERAL 114L
AGA 656U MISS STANDARD ET 17H

AGA 85J STANDARD 118L
AGA 118L MISS STANDARD 2R
AGA 97J MISS RED EXTRA 203N

GENERATOR STANDARD 10A
AD 75N LASS 31W
STANDRD LAD 656 4ET
AGA MISS 80S VOLTAGE ET 14X
AGA 191G STANDARD 85J
AGA 40Y MISS BRITISHER 168F
AGA 22B BRIGADER 97J
AGA 15H MISS BRITISHER 106L

Top % of Breed for: CE 10%, BW 25%, MILK 30%, MARB 5%
Wiley has excellent CE & light BW genetics! Offspring are vigorous at birth, thick, compact & well-marked with excellent pigment. A strong maternal factor is evidenced by his own fantastic feminine mother's (2R) super, flat, tight udder & small teats on each corner. Her consistent calves' avg'd 76 lb BW yet above avg WN. Don't miss 24W's MARB EPD of 0.33, (2016 progeny avg'd 138 MARB index), Lot 116D & 129D



SIRE B

C

AGA 26R WHAM HAMMER 87W

C02933144 ALNK 87W APRIL 06 2009

BW:	86
205:	671
365:	1077
'18 EPDs	
CE:	+4
BW:	+1.8
WW:	+24.6
YW:	+47.3
MCE:	+3.3
Milk:	+11.8
TM:	+24.1

DIAMOND-T 25J LAD 5L
LFF 5L JACK HAMMER 26R
LFF 3B HI LITE EXTRA LASS 11E

AGA 1S OLD DOMINO 44K
AGA 44K MISS OLD DOMINO 252M
AGA 102E MISS EXTRA 190K

DIAMOND-T 127C LAD 25J
DIAMOND-T DOM BRIT 5E
SJSJL HI LITE SUPER LAD 3B
LFF 16Z EXTRA LASS 3C
HU WETMORE DOMINO 1S
AGA 656U MISS STANDARD ET 17H
FE 27A EXTRA 102E
AGA 189C MISS DOMINO 22F

Top % of Breed for: BW 25%, RFI 20%, MARB 25%
What can he do? Produce thick meaty bulls with pants & wide tops and moderate-sized heifers, deep, sound & easy keeping with great udders. Why? 87W himself has a moderate birthweight, outstanding natural thickness, depth and length, good feet, quarters, & pants, performance, RibEye, Marbling and can pass it on! He multiplies the best attributes of his sire Jack Hammer 26R and his Old Domino 252M dam to produce beef-makers on both sides of a pedigree! Lots 41D, 55D, & 81D



SIRE C

ULRICH HEREFORD RANCH REFERENCE SIRES



SIRE D

D

GCC PETE 203Y ET

C02978686 203Y FEBRUARY 03 2011

BW:	205:	365:	'18 EPDs	CE:	BW:	WW:	YW:	MCE:	Milk:	TM:
				+12.2	+2.2	+39.8	+70.7	+7	+32.8	+52.7

CL 1 DOMINO 9126J 1ET
UPS DOMINO 3027
UPS MISS DIAMOND 1353
96 STANDARD 6A 25E
LPG STANDARD 44B LASS 50H
LPG COMMANDER 8080 LASS 59D
HH ADVANCE 767G 1ET
CL 1 DOMINETTE 490
SH DIAMOND 881
UPS MS MILEHIGH 8330
BP BRIGADIER 42B
96 SANDY ET 6A
LPG COMMANDER 44B
LPG 8080 LASS 21A

Top % of Breed for: CE 5%, BW 1%, MILK 5%, TM 30%, MCE 5%, MARB 25%

Stout, stout & stout stacked on top of Calving Ease - see Pete's top EPDs above, plus plenty of marbling thrown in for good measure (+0.18 MARB EPD). A look at Birth Averages over his lifetime shows 70 males born averaging 78 lbs, and 81 females born averaging 72 lbs. All these youngsters display that vigour that Pete stamps on newborn calves! Lots 4D, 6D, 12D, 46D, 53D, 62D, 64D, 65D, 73D, 76D, 85D, 101D, 108D, 603D, 605D, 607D, 609D, & 613D.



SIRE E

E

AGA 18Y ZOOM STANDARD 18Z

C02969377 ALNK 18Z MARCH 13 2012

BW:	205:	365:	'18 EPDs	CE:	BW:	WW:	YW:	MCE:	Milk:	TM:
94	758	1112		+1.8	+5.4	+51	+75.5	+1.6	+13.5	+39

SILVER STANDARD 55C
AGA 55C STANDARD 18Y
MISS 46E BRITISHER AGA 22L
AGA 20J STANMORE 21M
AGA 21M MISS STANMORE 76S
AGA 101J MISS STANDARD 140P
STANDARD INTENSE 36T
VERN LADY 4X
DP BRITISHER AGA 46E
PINE COULEE MISCHIEF LADY 397
AGA 121G STANMORE 20J
AGA 5C MISS ENERLAD 68K
AGA 656U STANDARD ET 101J
AGA 22B MISS BRIGADER 511E

Top % of Breed for: SCR 20%, RFI 30%

Zoom 18Z exudes performance, eye-appeal, growth, length, depth & great markings. He exhibits the thickness & capacity of the old, along with the femininity, udders & feet of the new! 94 lb BW, 758 lbs 205-day wt (116 indx), 1112 365-day wt (110 indx), REA 1.09/100 lbs. Dam 76S's pedigree is backed by great cattle. BW: 4 sons avg'd 88 lbs, 4 dtrs avg'd 83 lbs; WN: 4 sons avg'd 108.5 indx, 4 dtrs avg'd 113.8 indx; Lots 60D, 87D, 100D, 105D, 125D, 127D, & 604D

F

AGA 60W BANNER SPORT ZEAL 28Z

C02971712 ALNK 28Z MARCH 16 2012

BW:	205:	365:	'18 EPDs	CE:	BW:	WW:	YW:	MCE:	Milk:	TM:
86	717	950		+5.2	+2	+35.6	+61.2	+1.7	+17.9	+35.7

BBSF 6P SPORT 232S
BANNERLANE 232 EXTRA GEN 60W
BANNERLANE GENSTAR LASS 27R
CTY EASY 705T
AGA 705 MISS EASYGOING 905W
AGA 114L MISS STAR GENERAL 47S
HAWKEYE 75K SKY LAD 6P
BBSF 18H EXTRA LASS 237M
C 80G L SARGENT 78K
BANNERLANE STAN LASS 39M
AGA 10S STANDARD 137Y
COURTNEY LASS J921
AGA 13G GENERAL 114L
AGA 22B MISS BRIGADER 511E

Top % of Breed for: CE 25%, BW 25%

Which is more striking? 28Z's two hooded, goggle eyes, red neck, red testicles & red legs down to red hooves, or his eye-appeal, length, thickness & extra-wide top & sound solid feet never trimmed!? All of these, traits he passes on to progeny. Check out his 86 lb BW, 109 WN index, REA 1.21/100 lbs, & LMY 66.3! Dam 905W is tremendous with nice even teats on a tight udder. Yes, 28Z has certainly added some Zeal to our herd! Lots 29D, 61D, 69D, 86D, 89D, 94D 110D, & 120D.

G

KGA 125R LAD 48A

C02989464 KGA 48A MAY 13 2013

BW:	205:	365:	'18 EPDs	CE:	BW:	WW:	YW:	MCE:	Milk:	TM:
80	548	911		+11.4	+0.9	+24.2	+39.5	+7.9	+7.1	+19.2

F-R 8020 LAD 33H
KGA 33H LAD 125R
KGA GOLD MEDAL LASS 46D
AD A33H STANDARD LAD 50N
KGA 50N LASS 7S
KGA F33H LASS 130N
OXH MARK DOMINO 8020
DMF MISS BRITISHER STANDARD 3T
WABASH GOLD MEDAL 39X
KGA 29Z STANDARD LASS 20B
AD HIGH STANDARD LAD 33H
AD 33Z VOLTAGE LASS 43C
F-R 8020 LAD 33H
KGA 83D STANDARD LASS 47J

Top % of the breed: CE 5%, BW 5%, MCE 5%, MARB 30%

We are really pleased how many of KGA 48A's offspring have arrived! Nice performance, light birthweights (bull calves have averaged 78 lbs BW and 7 heifer calves have averaged 67 lbs at birth) and, of course, all of them unassisted! We purchased an interest in 48A from Doerksen's at Gem, AB - he was smooth & correct - promising to deliver calving ease plus performance and we received all those results! (currently owned with Doerksen's) Lots 14D & 106D



SIRE F

Catalogue Available Online

www.ulrichherefords.com

[or www.coyotepub.com](http://www.coyotepub.com)

ULRICH HEREFORD RANCH REFERENCE SIREs

H

AGA 2Y MO LE DOMINO 137A

C02989654 ALNK 137A MAY 10 2013

BW:	78
205:	470
365:	1055
'18 EPDs	
CE:	+7.3
BW:	-0.5
WW:	+29.7
YW:	+56.3
MCE:	-0.7
Milk:	+18.5
TM:	+33.4

MR MO LE 47F
AGA 47F DOMINO ET 2Y
AGA 22B MISS BRIGADER 511E

AGA 46E BRITISHER ET 2U
AGA 2U MISS BRITISHER 123Y
AGA 21M MISS STANMORE 100R

DOUBLE MO LE 12B
D STANDARD LASS 88B
CTY BRIGADER 22B
AGA MISS 42X STANMORE 94Z
DP BRITISHER AGA 46E
AGA 22B MISS BRIGADER 511E
AGA 20J STANMORE 21M
AGA 13G MISS GENERAL 249N

Top % of the breed: CE15%, BW 5%, MARB 30%
The few Domino 137A progeny, born full of vigour, then powerful, with thickness & muscle behind their growth & performance! Proven BWs: 79 lb avg for sons; 73 lbs avg for dtrs. Bonus: Sons' avg WN indx 105.5; 106 at YR; dtrs avg'd 103 WN indx & 103.5 YR indx. We're thrilled with 3-1/2 sib sisters producing 80 lb BWs, yet > avg WW & growth - superb udders, bone & feet. We anticipate an incredible future for this line: calving ease, good performance, & superb females soon to calve! Lot 90D



SIRE J

I

96 ANDY 72S

C02887424 CHB 72S APRIL 16 2006

BW:	96
205:	865
365:	
'18 EPDs	
CE:	+1.2
BW:	+3.8
WW:	+54.2
YW:	+70.4
MCE:	+3.5
Milk:	+15.1
TM:	+42.2

96 ANDY 81F
96 ANDY 7L
96 HANNA 9J

DUNN'S 02C LAD 14E
96 EVE 18N
96 LADY 56E

96 STANDARD ADVANCE 81N
96 LADY 48D
HH HOME BUILDER 603
96 STANDARD LASS 24E
DUNN'S 10Y LAD 02C
DUNN'S SPARTAN LADY 28C
96 LANDMARK 50A
96 PRISCILLA ET 10B

Top % of Breed for: MCE 30%
We purchased some 96 ANDY 72S semen from Bert Anderson of Sceptre, SK but unfortunately the bull died before we could picture him. His offspring certainly have really nice heads, length, good feet, legs and good heels - important for longevity in any herd. His progeny are born with moderate birthweights - all unassisted! Both males & females make a real uniform bunch of 72S progeny. Lots 57D

J

WH 9A RUST TEMPEST 372A

C03014506 372 FEBRUARY 09 2013

BW:	
205:	
365:	
'18 EPDs	
CE:	-1.1
BW:	+5.9
WW:	+55
YW:	+88.8
MCE:	+0.2
Milk:	+13.6
TM:	+41.1

FE 32P RUSTANDARD 6T
XTD 6T RUST TEMPEST ET 9A
JT 19P LADY 95U

CHURCHILL DOMINO 6101S
WICHMAN LADY 06
CHURCHILL LADY 04107

K 6J RUSTANDARD 32P
FE 59J DOM STD 82P
ILK STD 43K LAD 19P
JT STANWAY LADY 60S
CHURCHILL DOMINO 484
CHURCHILL LADY 401 ET
CHURCHILL BLAZE 1135
CHURCHILL LADY 030

Top % of Breed for: RFI 20%
We saw "Rusty" as a calf at Justin Wichman's (Montana), on his dam, 06, & really liked the pair! He gained really well (1 of the top YR calves at Justin's). Discovering the sire was XTD 6T RUST TEMPEST ET 9A, we were hooked! 9A was our pick of the Calgary Bull Sale, where XTC showed him as a 2-yr-old (1993). Now was our chance to have a 9A son & soon Rusty was breeding our young cows! He's deep & thick, easy-keepin' with good feet. See 4 sons here: Lots 31D, 43D, 103D, & 109D



78A - Dam of 41D



99B - Dam of 76D



118A - Dam of 12D



126W - Dam of 89D

ULRICH HEREFORD RANCH COMING 2'S



4

AGA 203Y GREGORY PETE DISCO 4D

C03028947 U 4D MARCH 21 2016

BW:	94
205:	718
'18 EPDs	
CE:	+2.6
BW:	+2.5
WW:	41.9
YW:	+70.9
MCE:	-3.8
Milk:	+25.9
TM:	+46.9

UPS DOMINO 3027
GCC PETE 203Y ET
LPG STANDARD 44B LASS 50H

AGA 46E BRITISHER ET 2U
AGA 2U MISS BRITISHER 94Z
AGA 114L MISS GENERAL 35U

CL 1 DOMINO 9126J 1ET
UPS MISS DIAMOND 1353
96 STANDARD 6A 25E
LPG COMMANDER 8080 LASS 59D

DP BRITISHER AGA 46E
AGA 22B MISS BRIGADER 511E
AGA 13G GENERAL 114L
AGA 53A MISS STANDARD ET 152M

Let's get the party started! Stout, deep, extra wide top, extremely thick, meaty and pants galore come from both Dad (203Y) and Mom (94Z). This son, with full pigment and red testicles, unlocks the potential to improve females' capacity and udder structure. 4D's Milk EPD is in the top 30% of the population, no doubt from dam 94Z's outstanding pedigree (see 2U, 114L & 152M sparkle there) and history of well-fleshing calves. Two of her bred daughters were purchased 2 years in a row by purebred breeder Greg Barber.

6

AGA 203Y GREGORY PETE DINO 6D

C03028949 U 6D MARCH 21 2016

BW:	88
205:	761
'18 EPDs	
CE:	-0.9
BW:	+3.1
WW:	+51.7
YW:	+87.7
MCE:	-0.6
Milk:	+27.2
TM:	+53.1

UPS DOMINO 3027
GCC PETE 203Y ET
LPG STANDARD 44B LASS 50H

BANNERLANE 232 EXTRA GEN 60W
AGA 60W MISS BANNER SPORT 2A
AGA 114L MISS GENERAL 141X

CL 1 DOMINO 9126J 1ET
UPS MISS DIAMOND 1353
96 STANDARD 6A 25E
LPG COMMANDER 8080 LASS 59D

BBSF 6P SPORT 232S
BANNERLANE GENSTAR LASS 27R
AGA 13G GENERAL 114L
AGA 53L MISS RED DOMINO 116R

EPDs - Milk top 25%, Tot Mat top 30%, Scrotal Top 15%, PWG top 25%, Marbling Top 15% of the breed! Dam 2A brings the extra frame & length, with muscling & performance to her calves (3 sons avg BW 87 lbs, yet indexed 106.7 at WN) - they're born good & grow good. She weaned this 203Y's red-testicled calf at 761 lbs, (highest index), above avg YR (104 index), & above avg RFI (the EPDs concur)! The pairing of 2A & 203Y (Dino) is sure to produce great females with square udders & small teats, along with tender beef. **Recommended for heifers or cows.**

8

AGA 21M DETECTIVE STANMORE 8D

C03028951 U 8D MARCH 22 2016

BW:	86
205:	774
'18 EPDs	
CE:	+5.8
BW:	+2.2
WW:	+47.6
YW:	+72.2
MCE:	+7.2
Milk:	+29.8
TM:	+53.6

AGA 121G STANMORE 20J
AGA 20J STANMORE 21M
AGA 5C MISS ENERLAD 68K

AGA 77J SUPER URANIUM 47U
AGA 47U MISS URANIUM 306A
AGA 118L MISS STANDARD 2R

AGA 4016D STANMORE 121G
AGA 40E MISS STANMORE 80G
XTC 15Z ENERLAD STAN 5C
AGA 154F MISS BRITISHER 159H

CC 129D SUPERMAN 77J
AGA 44K MISS OLD DOMINO 252M
AGA 85J STANDARD 118L
AGA 97J MISS RED EXTRA 203N

EPDs: CE top 20%, BW top 30%, Milk top 15%, Tot Mat top 30%, MCE, top 5%, SCF top 5% & Marb top 10% of the breed! 100 / 0 eye pigment, red neck & testicles, & an 86 lb BW mark this 21M son, 8D who uncovered plenty of performance (110 indx) & power after WN (107 indx) & Marb 109 indx. Add 21M long-lasting beautiful cows with exceptional CE & BW, outstanding udder suspension & small teats & we detect 8D **can be used on heifers**. See 21M's EPDs (pg 3) & dam 306A's EPDs: CE+9.9, BW+0.7(63 lbs act), Milk 24.5, TM 43.0, MCE 5.5 & Marb 0.25

12

AGA 203Y GREGORY PETE DYKE 12D

C03028955 U 12D MARCH 23 2016

BW:	78
205:	716
'18 EPDs	
CE:	+8.7
BW:	-0.6
WW:	+38.5
YW:	+57.9
MCE:	+5
Milk:	+29
TM:	+48.3

UPS DOMINO 3027
GCC PETE 203Y ET
LPG STANDARD 44B LASS 50H

BANNERLANE 232 EXTRA GEN 60W
AGA 60W MISS BANNER SPORT 118A
AGA 705 MISS EASYGOING 905W

CL 1 DOMINO 9126J 1ET
UPS MISS DIAMOND 1353
96 STANDARD 6A 25E
LPG COMMANDER 8080 LASS 59D

BBSF 6P SPORT 232S
BANNERLANE GENSTAR LASS 27R
CTY EASY 705T
AGA 114L MISS STAR GENERAL 47S

Heifer bull for easy unassisted birthdays - here's a 78 lb BW from dam 118A whose 3 bull calves avg'd 89lbs BW, yet weaned 107.3 indx! Looking for red? Dyke is a red boy with one goggle eye & 90% pigment in the other, red testicles, red neck, thick & meaty, red to the ground! He's designed to build cows/heifers by Pete 203Y who is making great young cows that last with great udders. Add some REA (112 indx), MARB (105 index) & Yield (65.4). Not convinced? 12D's EPDs: CE top 10%, BW top 5%, Milk top 15% MCE top 15%, MARB top 30% of the breed.



ULRICH HEREFORD RANCH COMING 2'S



14

AGA 48A DEPENDABLE LAD 14D

C03028957 U 14D MARCH 26 2016

BW:	70
205:	730
'18 EPDs	
CE:	+8.8
BW:	-1.3
WW:	+30.2
YW:	+46
MCE:	+4.8
Milk:	+17.9
TM:	+33

KGA 33H LAD 125R
KGA 125R LAD 48A
KGA 50N LASS 7S

F-R 8020 LAD 33H
KGA GOLD MEDAL LASS 46D
AD A33H STANDARD LAD 50N
KGA F33H LASS 130N

GCC PETE 203Y ET
AGA 203Y MISS GREGORY PETE 5B
AGA 2U MISS YANCEY BRIT 172Y

UPS DOMINO 3027
LPG STANDARD 44B LASS 50H
AGA 46E BRITISHER ET 2U
AGA 114L MISS STAR GENERAL 47S

Here's dependability! Born 70 lbs to a daughter of **heifer bull** Pete 203Y, sired by a top pedigree Doerksen bull bought for heifers, the numbers back 14D: Top 10% of the breed for CE, top 5% BW, top 20% MCE. Under the hide, REA scanned at 110 Indx & Marb 116 Indx (EPD is top 15% of the breed) & Yield 65.9, plus he was above avg at WN & the RFI Trial. The dam was a great yellow cow with +8.4 CE EPD, BW -1.2, MCE 2.8, & TM 45.9. Overall, 14D is built on a moderate red frame in a nice package: red eyes, red testicles and red neck.



29

AGA 28Z SPORT DISPATCHER 29D

C03028970 U 29D MARCH 30 2016

BW:	77
205:	715
'18 EPDs	
CE:	+8.3
BW:	+1.9
WW:	+43.2
YW:	+73.5
MCE:	+6
Milk:	+17.2
TM:	+38.8

BANNERLANE 232 EXTRA GEN 60W
AGA 60W BANNER SPORT ZEAL 28Z
AGA 705 MISS EASYGOING 905W

BBSF 6P SPORT 232S
BANNERLANE GENSTAR LASS 27R
CTY EASY 705T
AGA 114L MISS STAR GENERAL 47S

C 326N YES I CAN 127Y
AGA 127Y MISS YES MAAM 320A
AGA 26T MISS JARROD 65X

BCD 140L DOM LAD 326N
LONE-PINE ICE QUEEN 55T
CC 77J JARROD 26T
AGA 26R MISS STANMORE 108T

CE top 10%, BW top 25%, MCE top 10% of the breed - Not just easy calving, this fella is dispatching RED! A goggle eye, red testicles, red neck, red right to the toes, he's sired by the goggle-eyed red bull 28Z. Despite his thick and meaty build, wide & lean - yet moderately sized - this 29D **can be used on heifers** (check out that 77 lbs BW)! The dam, 320A, has produced back-to-back 28Z performance sons. Over 28Z's lifetime, his 32 bull calves have averaged 84 lbs at birth and 78 lbs for 36 heifer calves. "Do you copy?"



31

AGA 372A RUSTY DIMENSION 31D

C03028972 U 31D MARCH 30 2016

BW:	104
205:	740
'18 EPDs	
CE:	-4.9
BW:	+8.3
WW:	52.9
YW:	+75
MCE:	+1.1
Milk:	+16.7
TM:	+43.2

XTD 6T RUST TEMPEST ET 9A
WH 9A RUST TEMPEST 372A
WICHMAN LADY 06

FE 32P RUSTANDARD 6T
JT 19P LADY 95U
CHURCHILL DOMINO 6101S
CHURCHILL LADY 04107

CC 129D SUPERMAN 77J
AGA 77J MISS YELLO SUPERMAN 5Y
AGA 101J MISS STANDARD 140P

FE 07Y SUPER 129D
CC 42W JULIANA 66Z
AGA 656U STANDARD ET 101J
AGA 22B MISS BRIGADER 511E

Here's an impressive individual, long as a train with a top as wide as a table. He enters another Dimension as one of our thickest, most heavily muscled bulls, with great pants, all while boasting a 117 RFI EPD (top 5% of the breed) and a 0.48 REA EPD (top 25% of the breed, and REA index 127) and a whopping 66.0 Lean Meat Yield. Top this with a great disposition, curly haircoat, and 100/80 eye pigment. Mother 5Y contributes her tremendous depth of body with length and capacity and sports a lovely flat udder. **Retaining semen interest**



39

AGA 67A BANNER BRIT 39D

C03040663 U 39D APRIL 02 2016

BW:	91
205:	682
'18 EPDs	
CE:	+1.1
BW:	+4.9
WW:	+42.9
YW:	+71.9
MCE:	+1.5
Milk:	+15.3
TM:	+36.8

MVF 161R STD BRIT LAD 108U
BANNERLANE 108U STD BRIT 67A
BANNERLANE 251N STD LASS 32T

MN 532H BRIT VALLEY 161R
MVF 238K STD DOM LASS 112R
BBSF 114L NUMAN 251N
BANNERLANE HI STD LASS 24K

AGA 55C STANDARD 18Y
AGA 18Y MISS STANDARD YULE 14Y
AGA 21M MISS STANMORE 19R

SILVER STANDARD 55C
MISS 46E BRITISHER AGA 22L
AGA 20J STANMORE 21M
AGA 53L MISS RED DOMINO 218N

Banner Brit is the only son of BANNERLANE 108U STD BRIT 67A in the sale, but he's an extra long individual with a wide, straight top, thick quarters, & great pants. He's got a little extra chrome on the front legs, but where it counts there's 100/80 eye pigmentation and red testicles. We ultrasounded him with the home bunch, and he rang in the highest index (130) in REA, 2nd in both Rump Fat & Ribfat, yielded 65.6 lbs of LMY! Don't overlook the MARB EPD (top 20% of the breed). 39D comes from a great cow family - roomy with great feet and neat udders. **Retaining interest.**

ULRICH HEREFORD RANCH COMING 2'S



41

AGA 87W DOUBLEWIDE HAMMER 41D

C03028978 U 41D APRIL 03 2016

BW:	84
205:	744
'18 EPDs	
CE:	+0.6
BW:	+2.7
WW:	+21.6
YW:	+40.5
MCE:	-2.7
Milk:	+19.2
TM:	+30

LFF 5L JACK HAMMER 26R
AGA 26R WHAM HAMMER 87W
AGA 44K MISS OLD DOMINO 252M

DIAMOND-T 25J LAD 5L
LFF 3B HI LITE EXTRA LASS 11E
AGA 1S OLD DOMINO 44K
AGA 102E MISS EXTRA 190K

CTY EASY 705T
AGA 21M MISS STANMORE 22T
AGA 13G GENERAL 114L
AGA 41F MISS HI STANDARD 90P

87W sired this thick, deep-bodied, well-muscled attractive long son, with the desired 100/20 eye pigment with red testicles. As expected 41D performed well, even as the first calf from the dam, 78A - a roomy red cow who's passed the red eyes on to the son. She comes from a generation of great cows with great udders and her own sire was the Express 67X who has left excellent bulls and superb females with moderate birthweights plus performance.



43

AGA 372A RUSTY DYNAMITE 43D

C03028980 U 43D APRIL 04 2016

BW:	107
205:	721
'18 EPDs	
CE:	-6.6
BW:	+7.3
WW:	+48.1
YW:	+73.2
MCE:	-0.4
Milk:	+16.4
TM:	+40.5

XTD 6T RUST TEMPEST ET 9A
WH 9A RUST TEMPEST 372A
WICHMAN LADY 06

CC 129D SUPERMAN 77J
AGA 77J MISS SUPERMAN 17W
AGA 22B MISS BRIGADER ET 11L

FE 32P RUSTANDARD 6T
JT 19P LADY 95U
CHURCHILL DOMINO 6101S
CHURCHILL LADY 04107

FE 07Y SUPER 129D
CC 42W JULIANA 66Z
CTY BRIGADER 22B
AGA MISS 80S VOLTAGE ET 14X

Dynamite indeed - well-coloured with length, great muscle and soundness - this son of 372A was grandsired by Templeton's old 9A, who still blasts through 2 generations to produce yet another great son. Check out 372A's top 20% RFI EPD 109 plus growth (+34 PWG) and 43D's own top 15% RFI EPD of 111, along with ultrasound MARB index of 121! 43D's thick dam, 17W, comes from the Superman 77J bull and her feet & superb udder comes from a generation of special ET females! 3 of her bull calves avg'd 107.3 index and 3 heifer calves indexed 103.3.



46

AGA 203Y GREGORY PETE DUTY 46D

C03028983 U 46D APRIL 04 2016

BW:	86
205:	759
'18 EPDs	
CE:	+3.8
BW:	+2
WW:	+41.6
YW:	+70
MCE:	+2.8
Milk:	+26.3
TM:	+47.1

UPS DOMINO 3027
GCC PETE 203Y ET
LPG STANDARD 44B LASS 50H

CL 1 DOMINO 9126J 1ET
UPS MISS DIAMOND 1353
96 STANDARD 6A 25E
LPG COMMANDER 8080 LASS 59D

AGA 77J SUPER URANIUM 47U
AGA 47U LADY OF GRACE 304A
AGA 656U MISS STANDARD ET 92P

CC 129D SUPERMAN 77J
AGA 44K MISS OLD DOMINO 252M
STANDRD LAD 656 4ET
AGA 852 MISS STANMORE 22C

Reporting for duty, this **heifer bull's** BW EPD is top 20% of the breed! Born 86 lbs, he's a stout, big-bodied Pete 203Y son with extra performance (WN indx 108, YR indx 107), deep & thick (capacity proven by scan - 117 REA indx & LMY 65.7) Dam 304A is a young, easy-keeper with tremendous depth of body & capacity from a generation of excellent cows going back to the Misty Valley 656 4ET bull who gave us many excellent seedstock. 304A's two sons avg'd 112 WN Indx, & her Milk EPD is top 30%. White Lake Colony bought her sire (47U) in 2010.



53

AGA 203Y GREGORY PETE 53D

C03028988 U 53D APRIL 07 2016

BW:	84
205:	732
'18 EPDs	
CE:	+6.4
BW:	+1.3
WW:	+45.6
YW:	+72.4
MCE:	+4.5
Milk:	+26.2
TM:	+49

UPS DOMINO 3027
GCC PETE 203Y ET
LPG STANDARD 44B LASS 50H

CL 1 DOMINO 9126J 1ET
UPS MISS DIAMOND 1353
96 STANDARD 6A 25E
LPG COMMANDER 8080 LASS 59D

96 ANDY 72S
AGA 72S MISS BERT ANDY 15B
AGA 2U MISS BRITISHER 64Y

96 ANDY 7L
96 EVE 18N
AGA 46E BRITISHER ET 2U
AGA 72R MISS LADDIE 105U

Top 15% of the breed for CE, top 15% BW, top 30% Milk, and top 20% MCE, yes, these numbers belong to 53D, the son of BW trait-leading Pete 203Y. Born with a moderate birthweight of 84 lbs, he muscled quickly and grew stout with good natural thickness and ample performance. He weighed well at both weaning & yearling. We recommend using 53D on heifers also.

ULRICH HEREFORD RANCH COMING 2'S

55

AGA 87W DROPPED HAMMER 55D

C03028989 U 55D APRIL 07 2016



BW:	106
205:	753
'18 EPDs	
CE:	-6.5
BW:	+6.6
WW:	+43.9
YW:	+79.7
MCE:	-4.7
Milk:	+18.8
TM:	+40.8

LFF 5L JACK HAMMER 26R	DIAMOND-T 25J LAD 5L
AGA 26R WHAM HAMMER 87W	LFF 3B HI LITE EXTRA LASS 11E
AGA 44K MISS OLD DOMINO 252M	AGA 1S OLD DOMINO 44K
	AGA 102E MISS EXTRA 190K
AGA 20J STANMORE 21M	AGA 121G STANMORE 20J
AGA 21M MISS STANMORE 110S	AGA 5C MISS ENERLAD 68K
AGA 41F MISS HI STANDARD 90P	BANNERLANE HI STANDARD 41F
	AGA 22B MISS BRIGADER 23L

You'll want the hammer to drop on your bid, with this yellow, well-marked eye-appealing fella with red eyes, great structure & muscle-pattern with top performance (107 WN indx & 110 YR indx) and a super quiet temperament to boot! Dam 110S is an awesome cow from a wonderful pedigree, a nice tight udder with small, evenly placed teats & rich milk which consistently produces above avg WN & YR performance - a real producer! 55D hits it right on, with excellent conversion of top 30% Post Weaning Gain, along with a \$\$ saving top 30% RFI EPD (107).

57

AGA 72S BERT'S ANDY DEACON 57D

C03028991 U 57D APRIL 08 2016



BW:	102
205:	730
'18 EPDs	
CE:	-2.8
BW:	+6.5
WW:	+52.2
YW:	+72.1
MCE:	+3.1
Milk:	+15.8
TM:	+41.9

96 ANDY 7L	96 ANDY 81F
96 ANDY 72S	96 HANNA 9J
96 EVE 18N	DUNN'S 02C LAD 14E
	96 LADY 56E
CC 77J JARROD 26T	CC 129D SUPERMAN 77J
AGA 26T MISS JARROD 85X	CC 14N JOCELYN 33R
AGA 101J MISS STANDARD 97R	AGA 656U STANDARD ET 101J
	AGA 303Y MISS STANDARD 141E

This Deacon is looking for an honest day's work - the only son of the old Bert Anderson bull, 96 Andy 72S, in this sale. He's sound as a rock and well-marked with red neck and red testicles, medium coloured and a great haircoat covering his great length. His mother, 85X, is hard to fault: beautiful, feminine, great-uddered, with rich milk and backgrounded by excellent maternal generations. 57D's got nothing to hide under the hide either, sporting the 2nd highest 164 Marbling index from the ultrasound scanner! You'll do right by this guy!

60

AGA 18Z ZOOM STAN DRUMROLL 60D

C03028994 U 60D APRIL 08 2016



BW:	103
205:	792
'18 EPDs	
CE:	+0.5
BW:	+6.7
WW:	+56.9
YW:	+88.8
MCE:	+4.6
Milk:	+18.2
TM:	+46.7

AGA 55C STANDARD 18Y	SILVER STANDARD 55C
AGA 18Y ZOOM STANDARD 18Z	MISS 46E BRITISHER AGA 22L
AGA 21M MISS STANMORE 76S	AGA 20J STANMORE 21M
	AGA 101J MISS STANDARD 140P
LCI 68R RED STANDARD 109U	JNHR RED STANDARD 68R
AGA 109U MISS RIB STAN 117Z	LCI KD CRYSTAL 7N
AGA 21M MISS STANMORE 126T	AGA 20J STANMORE 21M
	AGA 656U MISS STANDARD 135J

Drumroll... Highest performing bull of the bunch, (113 WN indx, 107 YR indx), this powerful 18Z son with a woolly medium-coloured haircoat has excellent scrotal shape & size, with very hooded eyes & pigment. He's thick, long & quiet with tremendous maternal strength (excellent udder placement & good feet from generations behind dam 117Z, daughter of a Doenz bull. Her 3 heifers avg'd 105 WN indx). 60D ran as a yearling with 30 young cows & didn't miss a beat - kept his flesh just like the other bulls. Top 25% WN, Top 20% MCE, & top 5% Scrotal EPDs.

61

AGA 28Z DIVERSIFIED SPORT 61D

C03028995 U 61D APRIL 08 2016



BW:	86
205:	673
'18 EPDs	
CE:	-0.5
BW:	+3.8
WW:	+37.4
YW:	+64.3
MCE:	-1.5
Milk:	+16.2
TM:	+34.9

BANNERLANE 232 EXTRA GEN 60W	BBSF 6P SPORT 232S
AGA 60W BANNER SPORT ZEAL 28Z	BANNERLANE GENSTAR LASS 27R
AGA 705 MISS EASYGOING 905W	CTY EASY 705T
	AGA 114L MISS STAR GENERAL 47S
AGA 26R WHAM HAMMER 87W	LFF 5L JACK HAMMER 26R
AGA 87W MISS DIA WHAM 89B	AGA 44K MISS OLD DOMINO 252M
AGA 5T MISS STANMORE DOM 3W	AGA 26R STANMORE 5T
	AGA 40Y MISS BRITISHER 88F

If red is what you're looking for, AGA 28Z DIVERSIFIED SPORT 61D fits the bill! He's got red eyes, red testicles, and even a red neck. And if you're looking for red meat, the ultrasound scanner measured a Lean Meat Yield of 65.1. Even the Marbling scored a healthy 118 index along with a well above average Ribeye Area. This son of 28Z should certainly pass the red and the meat on to his progeny.

ULRICH HEREFORD RANCH COMING 2'S

62

AGA 203Y GREGORY PETE DOC 62D

C03028996 U 62D APRIL 08 2016



BW:	63
205:	716
'18 EPDs	
CE:	+13.4
BW:	+1.3
WW:	+36.5
YW:	+64.1
MCE:	+6.7
Milk:	+26.2
TM:	+44.5

UPS DOMINO 3027
GCC PETE 203Y ET
 LPG STANDARD 44B LASS 50H
 AGA 114L GENERAL WILEY 24W
AGA 24W MISS GEN WILEY 101B
 AGA 87W MISS DIA WHAM 97Z

CL 1 DOMINO 9126J 1ET
 UPS MISS DIAMOND 1353
 96 STANDARD 6A 25E
 LPG COMMANDER 8080 LASS 59D
 AGA 13G GENERAL 114L
 AGA 118L MISS STANDARD 2R
 AGA 26R WHAM HAMMER 87W
 AGA 21M MISS STANMORE 17T

Is there a Doc in the sale? Yes, there is - He's another light BW, stout son of Pete 203Y, born with vigour & performed above avg at WN & YR. His dam, 101B, is a moderate-sized feminine mother, well put together with good hair, nice udder & sound feet (like Doc!). Ultrasound scored him #1 in our herd for Marb, backed by the EPDs: Top 1% of the breed for both CE & MARB, top 5% BW, top 30% Milk, & top 10% MCE. Not only a **heifer bull**, 62D delivers the structure & milk from the Pete/101B combo. If you use this Doc, you won't need the cow doc at calving time!

64

AGA 203Y GREGORY PETE DRUM 64D

C03028998 U 64D APRIL 08 2016



BW:	77
205:	682
'18 EPDs	
CE:	+6.3
BW:	+1
WW:	+40.3
YW:	+65.9
MCE:	+3.8
Milk:	+24.8
TM:	+45

UPS DOMINO 3027
GCC PETE 203Y ET
 LPG STANDARD 44B LASS 50H
 MR MO LE 56 DOMINO LAD 60H
AGA 60H MISS MO DOMINO BIZ 56B
 AGA 21M MISS STANMORE 84T

CL 1 DOMINO 9126J 1ET
 UPS MISS DIAMOND 1353
 96 STANDARD 6A 25E
 LPG COMMANDER 8080 LASS 59D
 DOMINO STANDARD LAD 56B
 MISS MO LE 68D
 AGA 20J STANMORE 21M
 AGA 53L MISS RED DOMINO 116R

Our BW & CE Trait Leader bull, Pete 203Y, has drummed up yet another great **heifer bull**, 64D, who is stout, wide-bodied, deep with red testicles and same pigmentation on both eyes. He was born to 56B, a deep, thick, feminine cow sired by the old AI bull, 60H (from an alphabet ago). She's an easy fleshing cow with a woolly haircoat which will do her well over many many winters with her expected longevity! 64D rattles out top 20% CE, top 15% BW & top MCE EPDs too!

65

AGA 203Y GREGORY PETE DART 65D

C03028999 U 65D APRIL 09 2016



BW:	65
205:	699
'18 EPDs	
CE:	+12.7
BW:	-1.9
WW:	+35.9
YW:	+65.7
MCE:	+6.1
Milk:	+26.5
TM:	+44.5

UPS DOMINO 3027
GCC PETE 203Y ET
 LPG STANDARD 44B LASS 50H
 AGA 705 EASYGOING EXPRESS 67X
AGA LADY ELIANDRA 7B
 AGA 114L MISS GENERAL 25Z

CL 1 DOMINO 9126J 1ET
 UPS MISS DIAMOND 1353
 96 STANDARD 6A 25E
 LPG COMMANDER 8080 LASS 59D
 CTY EASY 705T
 AGA 21M MISS STANMORE 22T
 AGA 13G GENERAL 114L
 AGA 97J MISS RED EXTRA 258P

Recommended for heifers, 65D darted out at birth a mere 65 lbs - sired by Pete 203Y, who specializes in these light calves that start growing once they hit the ground. 65D's now stout, short marked & curly with red neck & testicles - a very attractive bull. The excellent dam was a moderate size with a superb shapely udder, & wears a red woolly haircoat. Ultrasound pointed to a 123 index for MARB - see also top 5% Marb EPD, along with the expected top 1% CE, top 1% BW, top 20% Milk, & top 10% MCE. Don't let him dart out that door without your bid!

69

AGA 28Z SPORT ZEAL DRUMMER 69D

C03029003 U 69D APRIL 09 2016



BW:	72
205:	737
'18 EPDs	
CE:	+9.5
BW:	+0.3
WW:	+37.7
YW:	+62.7
MCE:	+4.8
Milk:	+21
TM:	+39.9

BANNERLANE 232 EXTRA GEN 60W
AGA 60W BANNER SPORT ZEAL 28Z
 AGA 705 MISS EASYGOING 905W
 GCC PETE 203Y ET
AGA 203Y MISS GREGORY PETE 93B
 AGA 174S MISS ROYAL AMIGO 59Y

BBSF 6P SPORT 232S
 BANNERLANE GENSTAR LASS 27R
 CTY EASY 705T
 AGA 114L MISS STAR GENERAL 47S
 UPS DOMINO 3027
 LPG STANDARD 44B LASS 50H
 SGC 76P ROYAL AMIGO 174S
 AGA 124J MISS STANDARD 9L

A grandson of Pete 203Y, this fella's got a lot to drum about! He's a **heifer bull** indeed, with his Pete 203Y top and quarters, and the red factor from sire 28Z - red eyes, red neck, red testicles, correct, sound, even some red in the hooves. 69D performed well at weaning & yearling. His dam, 93B, has a top udder and comes from a great family background. His rhythm is confirmed by top 5% of the breed for CE, top 10% for BW, and top 20% for MCE.

ULRICH HEREFORD RANCH COMING 2'S



73

AGA 203Y GREGORY PETE DASH 73D

C03029006 U 73D APRIL 10 2016

BW:	73
205:	758
'18 EPDs	
CE:	+7.8
BW:	+1.3
WW:	+48.4
YW:	+81.9
MCE:	+5.7
Milk:	+27.6
TM:	+51.8

UPS DOMINO 3027
GCC PETE 203Y ET
LPG STANDARD 44B LASS 50H

CL 1 DOMINO 9126J 1ET
UPS MISS DIAMOND 1353
96 STANDARD 6A 25E
LPG COMMANDER 8080 LASS 59D

AGA 20J STANMORE 21M
AGA 21M MISS BETH STANMORE 45B
AGA 93D MISS STANDARD ET 41R

AGA 121G STANMORE 20J
AGA 5C MISS ENERLAD 68K
LLL 85A STANDARD 93D
AGA MISS 80S VOLTAGE ET 14X

73 lbs BW, 108 WN indx & our top-ranked YW summarizes this stout, deep, wide bull with lean meaty quarters. Add a dash of 100/50 eye pigment, & red neck & testicles; sprinkle with top 10% CE, top 15% BW, top 20% Milk, top 30% Sustained Cow Fertility, & top 10% MCE EPDs to produce 73D **suited for heifers & cows!** His maternal granddam 41R had twins at 12 yrs old, yet udder is still flat with small well-placed teats. His maternal grandsire, 21M, is a trait leader for Milk (35) & TM (59.6) & passes on performance & tight udders - a great recipe for success!



76

AGA 203Y GREGORY PETE DEEP 76D

C03029009 U 76D APRIL 10 2016

BW:	68
205:	751
'18 EPDs	
CE:	+14.4
BW:	+0.3
WW:	+42.8
YW:	+80.7
MCE:	+6.7
Milk:	+28
TM:	+49.4

UPS DOMINO 3027
GCC PETE 203Y ET
LPG STANDARD 44B LASS 50H

CL 1 DOMINO 9126J 1ET
UPS MISS DIAMOND 1353
96 STANDARD 6A 25E
LPG COMMANDER 8080 LASS 59D

AGA 114L GENERAL WILEY 24W
AGA 24W MS GEN WILEY BONNY 99B
AGA 47R MISS BRITISHER 1T

AGA 13G GENERAL 114L
AGA 118L MISS STANDARD 2R
AGA 46E BRITISHER 47R
AGA 21M MISS STANMORE 19R

Aptly named, this extra deep son of Pete 203Y, out of 99B, an incredible young cow, reaches down to pull out lots of performance (WN 107 index, YR 106 index) after born only 68 lbs! Now, he's stout, stout, stout, with a table-topped loin, correct, with one goggle eye, great feet and a perfect set of testicles and red to boot! Look at the depth of those numbers: Top 1% CE, top 5% BW, top 20% Milk, top 10% MCE, top 20% PWG, top 15% MARB. We used 76D on 17 heifers this past summer - proving an excellent breeder and **ideal for both cows and heifers.**



81

AGA 87W HAMMER DIPLOMAT 81D

C03029014 U 81D APRIL 13 2016

BW:	84
205:	725
'18 EPDs	
CE:	+4.7
BW:	+2.1
WW:	+32.1
YW:	+61.8
MCE:	+1.1
Milk:	+15.9
TM:	+32

LFF 5L JACK HAMMER 26R
AGA 26R WHAM HAMMER 87W
AGA 44K MISS OLD DOMINO 252M

DIAMOND-T 25J LAD 5L
LFF 3B HI LITE EXTRA LASS 11E
AGA 1S OLD DOMINO 44K
AGA 102E MISS EXTRA 190K

AGA 22B BRIGADER 97J
AGA 97J MISS RED EXTRA 258P
AGA 141J MISS STANDARD 191M

CTY BRIGADER 22B
AGA 335C MISS EXTRA 8G
AGA 191G STANDARD 141J
AGA MISS CENTENNIAL 62C

81D is a red-eyed, red-testicled, correctly-made Wham Hammer son out of a great milking 97J daughter, 258P. She is blessed with outstanding feet, a great udder & wonderful longevity (after producing 12 calves already, she's in calf again for 2018)! Her 2016 project, 81D, started with a great BW & managed his way to a top 30% of the breed for CE EPD, top 30% BW, top 25% RFI & top 5% for Marb EPDs, while negotiating the RFI Trial to score well above avg for RFI, & # 1 MARB of our group & LMY of 65.6. Let this Diplomat settle **both your heifers & cows!**



85

AGA 28Z SPORT DISCOVER 85D

C03029019 U 85D APRIL 15 2016

BW:	73
205:	649
'18 EPDs	
CE:	+6.5
BW:	+1.2
WW:	+32.7
YW:	+59.1
MCE:	+1.8
Milk:	+16.9
TM:	+33.3

BANNERLANE 232 EXTRA GEN 60W
AGA 60W BANNER SPORT ZEAL 28Z
AGA 705 MISS EASYGOING 905W

BBSF 6P SPORT 232S
BANNERLANE GENSTAR LASS 27R
CTY EASY 705T
AGA 114L MISS STAR GENERAL 47S

LLL 85A STANDARD 93D
AGA 93D MISS STANDARD 86R
AGA 15H MISS BRITISHER 106L

LLL FE STD BRIT 85A
LLL 81R STD BRIT LASS 77W
46E BRITISHER AGA 15H
AGA 121G MISS STANMORE 134J

Our goggle-eyed 28Z sire with lots of red over a lot of rib has passed along one red eye & red testicles to this heifer bull, 85D, so some progeny could come goggled eyed too! The dam, 86R, has her own volume, great udder and solid feet along with longevity. Her dam summary uncovers 8 sons avg'd 86 lbs BW and 105.6 WN index, and 6 sons, 105 YW index, while 3 daughters avg'd 92 lbs BW, 113 WN index, and 2 daughters 104 YW indx. Therefore, the top 15% of the breed for CE & BW, and top 10% for MCE EPDs, come as no surprise.

ULRICH HEREFORD RANCH COMING 2'S



86

AGA 203Y PETE'S DYNAMO 86D

C03029018 U 86D APRIL 15 2016

BW:	73
205:	701
'18 EPDs	
CE:	+6.4
BW:	+0.9
WW:	+42.1
YW:	+63.5
MCE:	+5.9
Milk:	+24.2
TM:	+45.3

UPS DOMINO 3027	CL 1 DOMINO 9126J 1ET
GCC PETE 203Y ET	UPS MISS DIAMOND 1353
LPG STANDARD 44B LASS 50H	96 STANDARD 6A 25E
	LPG COMMANDER 8080 LASS 59D
YV 915W MR RISING STAR 94Y	YV STAR STRUCK 915W
AGA 94Y MS BLUESTAR RISING 55B	SNS 67F SILVER SKY LADY 107H
AGA 77J MISS XENON STAR 11X	CC 129D SUPERMAN 77J
	AGA 656 MISS STANDARD 69M

We hand-bred some heifers to this Dynamo 86D, who was sired by Pete 203Y, our specialist for CE & BW. The dam, 55B, brings forth the genetics of Rising Star 94Y purchased in Medicine Hat from Nels & Terri Nixdorff. The result - a great bull, great pedigree, great future. **Retaining In-Herd Interest** and **recommended for heifers** (top 15% for CE & BW EPDs) Born 73 lbs, red eyed, with red testicles, this eye-appealing calf grew efficiently (110 RFI Index - 68 penmates) becoming an energized breeder - always on the hunt for another cow - he sure was eager!



87

AGA 18Z ZOOM STAN DIVIDEND 87D

C03029020 U 87D APRIL 15 2016

BW:	83
205:	696
'18 EPDs	
CE:	+6.4
BW:	+3.9
WW:	+41.3
YW:	+61.8
MCE:	+3.3
Milk:	+17.8
TM:	+38.5

AGA 55C STANDARD 18Y	SILVER STANDARD 55C
AGA 18Y ZOOM STANDARD 18Z	MISS 46E BRITISHER AGA 22L
AGA 21M MISS STANMORE 76S	AGA 20J STANMORE 21M
	AGA 101J MISS STANDARD 140P
CTY EASY 705T	AGA 10S STANDARD 137Y
AGA 705 MISS EASYGOING 129X	COURTNEY LASS J921
AGA 21M MISS STANMORE 151P	AGA 20J STANMORE 21M
	AGA 97J MISS RED EXTRA 145M

One goggle eye and the other with 30% pigment mark this son of Zoom 18Z with excellent shaped red testicles! He too, was in the CHA's RFI Trial last spring and indexed very high against his penmates. Check out his top 15% of the breed EPD for RFI, along with top 15% CE and top 30% MARB. The rich milk from the level udder of the 129X dam paid out through his full brother who sold in last year's sale to MN Herefords and Austin Nixdorff. Likewise, this fella is **recommended for use on heifers!** Who will collect the Dividend this year?



89

AGA 28Z SPORT DIGNITARY 89D

C03029022 U 89D APRIL 15 2016

BW:	83
205:	724
'18 EPDs	
CE:	+6.8
BW:	+3.3
WW:	+46.3
YW:	+78.4
MCE:	+3.4
Milk:	+20.7
TM:	+43.9

BANNERLANE 232 EXTRA GEN 60W	BBSF 6P SPORT 232S
AGA 60W BANNER SPORT ZEAL 28Z	BANNERLANE GENSTAR LASS 27R
AGA 705 MISS EASYGOING 905W	CTY EASY 705T
	AGA 114L MISS STAR GENERAL 47S
AGA 4P RIBSTONE 81S	LCI 157K RIBSTONE 4P
AGA 81S MISS RIBSTONE 126W	AGA 44K MISS OLD DOMINO 252M
AGA 21M MISS STANMORE 76S	AGA 20J STANMORE 21M
	AGA 101J MISS STANDARD 140P

Originating with a moderate BW, this SPORT 28Z son performed well, suited up in deep ribs, well-marked with red testicles. His CE EPD is top 15% of the breed, & MCE top 30%, sealed with Marb top 25%. His dam, 126W, has volume plus level, well-placed teats & great solid feet like 89D! Check out her consistency: sons avg'd 89 lbs BW, 106 WN indx, & 104.7 YR indx; dtrs avg'd 81 lbs BW, 112.3 WN index, & 118 YR indx! Her 69A son went to C Oscar Johnsons Ranch, 135B dtr is a powerful young replacement here & 40C works at Diamond H Ranch, WY.



90

AGA 137A MO LE BRIT DIESEL 90D

C03029023 U 90D APRIL 15 2016

BW:	80
205:	749
'18 EPDs	
CE:	+1.6
BW:	+2.6
WW:	+43.2
YW:	+77.6
MCE:	-2.9
Milk:	+16.1
TM:	+37.7

AGA 47F DOMINO ET 2Y	MR MO LE 47F
AGA 2Y MO LE DOMINO 137A	AGA 22B MISS BRIGADER 511E
AGA 2U MISS BRITISHER 123Y	AGA 46E BRITISHER ET 2U
	AGA 21M MISS STANMORE 100R
AGA 55C STANDARD 18Y	SILVER STANDARD 55C
AGA 18Y MISS STANDARD 32B	MISS 46E BRITISHER AGA 22L
AGA 114L MISS GENERAL 31U	AGA 13G GENERAL 114L
	AGA 4K MISS STANMORE 103M

90D is a very correct, attractive individual with a great coat, red eyes and is the only son of 137A in the sale. His great performance is no doubt fueled by 137A's wide-topped frame with extreme quarters, heavy bone, and excellent feet. The maternal side can't be ignored either, with superb, moderately-sized females with volume and lovely udders. We want to take advantage of this power-producing 90D also, and are **retaining an In-Herd interest. Recommended for heifers.**

ULRICH HEREFORD RANCH COMING 2'S



94

AGA 28Z SPORT DECKHAND 94D

C03029026 U 94D APRIL 16 2016

BW:	75
205:	674
'18 EPDs	
CE:	+4.5
BW:	+1.6
WW:	+32.2
YW:	+57.9
MCE:	+1.3
Milk:	+17.1
TM:	+33.2

BANNERLANE 232 EXTRA GEN 60W	BBSF 6P SPORT 232S
AGA 60W BANNER SPORT ZEAL 28Z	BANNERLANE GENSTAR LASS 27R
AGA 705 MISS EASYGOING 905W	CTY EASY 705T
	AGA 114L MISS STAR GENERAL 47S
AGA 22B BRIGADER 53L	CTY BRIGADER 22B
AGA 53L MISS RED DOMINO 57S	AGA 189C MISS DOMINO 4E
AGA 79H MISS BRIT DOM 29N	FE 135D BRIT DOM 79H
	AGA 13G MISS GENERAL 9K

This Deckhand is ready to work - he's built for the job - really correct, thick, extra-long with a wide straight top - and bred for working by the deep and easy keeping 28Z. The dam, 57S, is an excellent cow with the volume, longevity and outstanding haircoat that we demand. While not particularly bred for the lightest birthweights, we certainly wouldn't hesitate to try him on a few heifers, (EPDs would tend to agree, as the CE EPD is in the top 30% of the breed and BW EPD in the top 20%), but he'd certainly be great maintenance for the cow herd.



100

AGA 18Z ZOOM STAN DECKER 100D

C03029031 U 100D APRIL 20 2016

BW:	91
205:	677
'18 EPDs	
CE:	+2.1
BW:	+4
WW:	+41
YW:	+59.9
MCE:	-4
Milk:	+15.5
TM:	+36

AGA 55C STANDARD 18Y	SILVER STANDARD 55C
AGA 18Y ZOOM STANDARD 18Z	MISS 46E BRITISHER AGA 22L
AGA 21M MISS STANMORE 76S	AGA 20J STANMORE 21M
	AGA 101J MISS STANDARD 140P
BANNERLANE 232 EXTRA GEN 60W	BBSF 6P SPORT 232S
AGA 60W MISS BANNER SPORT 91A	BANNERLANE GENSTAR LASS 27R
AGA 41F MISS HI STANDARD 87R	BANNERLANE HI STANDARD 41F
	AGA 44K MISS OLD DOMINO 252M

No, this isn't Double Decker, not Black & Decker, it's Zoom Stan Decker! And yes, he's an attractive, short-marked, moderately-sized son of 18Z, sporting goggle eyes and red testicles. A peek under the deck puts 100D in the top 20% of the breed for his Scrotal EPD. The young dam, 91A, has volume and capacity built right in along with maternal strength!



101

AGA 203Y GREGORY PETE DON 101D

C03029032 U 101D APRIL 20 2016

BW:	74
205:	685
'18 EPDs	
CE:	+10.7
BW:	-0.5
WW:	+40.7
YW:	+62.4
MCE:	+6.7
Milk:	+24.7
TM:	+45.1

UPS DOMINO 3027	CL 1 DOMINO 9126J 1ET
GCC PETE 203Y ET	UPS MISS DIAMOND 1353
LPG STANDARD 44B LASS 50H	96 STANDARD 6A 25E
	LPG COMMANDER 8080 LASS 59D
96 ANDY 72S	96 ANDY 7L
AGA 72S MISS BETH BERT ANDY 4B	96 EVE 18N
AGA 114L MISS GENERAL 51T	AGA 13G GENERAL 114L
	AGA 20J MISS STANMORE 253M

"Easy Calving 101" - Don is another light birth weight bull suitable for heifers. Pete 203Y sired this fella with the typical 74 lb birthweight, now stout & sound with red testicles. The dam, 4B, hails from a strong maternal background, so once again, a Pete progeny dons the top 5% of the breed for both CE EPD and BW EPD, along with the top 10% MCE EPD and capped off by a top 30% Marb EPD.



103

AGA 372A RUSTY DEFENCEMAN 103D

C03029034 U 103D APRIL 22 2016

BW:	94
205:	815
'18 EPDs	
CE:	-2.1
BW:	+4.8
WW:	+46.2
YW:	+86.6
MCE:	-1.8
Milk:	+13
TM:	+36.1

XTD 6T RUST TEMPEST ET 9A	FE 32P RUSTANDARD 6T
WH 9A RUST TEMPEST 372A	JT 19P LADY 95U
WICHMAN LADY 06	CHURCHILL DOMINO 6101S
	CHURCHILL LADY 04107
AGA 70N BRIT DOM 65R	AGA 79H BRIT DOM ET 70N
AGA 65R MISS BRIT DOM 24T	AGA 97G MISS HOT SHOT 82J
AGA 10B MISS BEAR 49M	HLAH 90Z MARK DONALD 10B
	AGA 189C MISS DOMINO 22F

If you're looking to add a Defenceman to your team, this fella is ready to play! He is built with an extra long & wide top, curly haircoat & sired by Rusty 372A. 103D exhibited top performance during his growing up years - all while eating less groceries than most of his competitors (above avg RFI), yet still scoring top 10% of the breed for growth between WN & YR (PWG). The dam was very supportive with her own thickness, lots of capacity & wears a woolly curly haircoat while cheering on this son - the one with the 40/0 eye pigment and red testicles...

ULRICH HEREFORD RANCH COMING 2'S



105

AGA 18Z ZOOM STAN DEPUTY 105D

C03029036 U 105D APRIL 23 2016

BW:	100
205:	681
'18 EPDs	
CE:	-3.4
BW:	+5.4
WW:	+45.3
YW:	+67.1
MCE:	+1.4
Milk:	+17.8
TM:	+40.5

AGA 55C STANDARD 18Y	SILVER STANDARD 55C
AGA 18Y ZOOM STANDARD 18Z	MISS 46E BRITISHER AGA 22L
AGA 21M MISS STANMORE 76S	AGA 20J STANMORE 21M
	AGA 101J MISS STANDARD 140P
CC 129D SUPERMAN 77J	FE 07Y SUPER 129D
AGA 77J MISS SUPERMAN 25U	CC 42W JULIANA 66Z
AGA 335C MISS EXTRA 8G	CTY EXTRA 335C
	AGA 67Z MISS CENTENNIAL 81D

You won't need to call the Sheriff if this Deputy is on duty! He shows up for work in a well marked uniform, with the eye-appeal we all appreciate - well marked, 100% pigmentation on one eye, red testicles and lots of length. His mother was the very productive cow, 25U, also long, but feminine with a super level udder. Her mother, 8G, was a Dam of Great Distinction, an honour bestowed on nominated cows that have had 10 or more progeny and meet the highest standards for maternal ability within herd.



106

AGA 48A DEPENDABLE LAD 106D

C03029037 U 106D APRIL 23 2016

BW:	86
205:	780
'18 EPDs	
CE:	+6.7
BW:	+2.6
WW:	+43.7
YW:	+73.1
MCE:	+6.6
Milk:	+14.4
TM:	+36.3

KGA 33H LAD 125R	F-R 8020 LAD 33H
KGA 125R LAD 48A	KGA GOLD MEDAL LASS 46D
KGA 50N LASS 7S	AD A33H STANDARD LAD 50N
	KGA F33H LASS 130N
96 ANDY 72S	96 ANDY 7L
AGA 72S MISS BERT ANDY BIRD 8B	96 EVE 18N
AGA 72R MISS LADDIE 105U	KGA 33H LAD 72R
	AGA 21M MISS STANMORE 110S

Look no further for dependability! Born at 86 lbs, 106D was a top performance calf (also scanned with 3rd highest REA), long & sound, from the Doerksen 48A bull, who is siring calving ease. We used 106D on heifers here, & two of the heifers in this sale are preg-checked to him (21D & 113D). 106D was his dam, 8B's, first calf & her 2nd calf was great too. She comes from a great maternal cow line. With this background & a top 15% CE EPD and a top 10% MCE EPD of the breed, Dependable 106D is recommended for heifers. Retaining in-herd interest



108

AGA 203Y GREGORY PETE DAN 108D

C03029039 U 108D APRIL 23 2016

BW:	81
205:	694
'18 EPDs	
CE:	+3.4
BW:	+2.7
WW:	+44.8
YW:	+79.2
MCE:	+1.8
Milk:	+24.1
TM:	+46.5

UPS DOMINO 3027	CL 1 DOMINO 9126J 1ET
GCC PETE 203Y ET	UPS MISS DIAMOND 1353
LPG STANDARD 44B LASS 50H	96 STANDARD 6A 25E
	LPG COMMANDER 8080 LASS 59D
AGA 18Y ZOOM STANDARD 18Z	AGA 55C STANDARD 18Y
AGA 18Z MS ZOOM STAN BERRY 92B	AGA 21M MISS STANMORE 76S
AGA 114L MISS GENERAL 104W	AGA 13G GENERAL 114L
	AGA 41F MISS HI STANDARD 90P

If you're looking for a great heifer bull that can be used on cows too, Dan's your man! Sired by the BW Trait Leader Pete 203Y, 108D is stout, thick & sound. Born at only 81 lbs, he never looked back and has continued to perform well to this day. He's solid marked, with the coveted red neck and red testicles (note - Scrotal EPD is in the top 30% of the breed). The dam, 92B was marked solid, even exhibiting pigmentation in the feet, and is pleased to pass on maternal strength and tidy udders from many generations back!



109

AGA 372A RUSTY DOMINATOR 109D

C03029040 U 109D APRIL 23 2016

BW:	89
205:	691
'18 EPDs	
CE:	+6.7
BW:	+2.1
WW:	+37.3
YW:	+63.1
MCE:	+2.6
Milk:	+15.6
TM:	+34.3

XTD 6T RUST TEMPEST ET 9A	FE 32P RUSTANDARD 6T
WH 9A RUST TEMPEST 372A	JT 19P LADY 95U
WICHMAN LADY 06	CHURCHILL DOMINO 6101S
	CHURCHILL LADY 04107
AGA 46E BRITISHER 47R	DP BRITISHER AGA 46E
AGA 47R MISS BRITISHER 1T	AGA 167L MISS SILVER 125N
AGA 21M MISS STANMORE 19R	AGA 20J STANMORE 21M
	AGA 53L MISS RED DOMINO 218N

"The Dominator" is deep and thick, with red testicles and partial pigmentation in both eyes, sired by the "Meat Machine" Rusty 372A. The dam, 1T, was a solid-marked, easy keeping cow, with a lot o' volume. She had a tight udder like her mother, 19R, and grandmother, 218N - great ancestors, excellent cows. When the counts come up, the Dominator finds himself with a Marb Index of 121, and lands in the top 15% of the breed for CE, top 30% for BW and top 20% for RFI EPD (& 121 index at the RFI Trial itself) - an efficiency pro!



110

AGA 28Z DIGNIFIED SPORT 110D

C03029041 U 110D APRIL 25 2016

BW:	96
205:	663
'18 EPDs	
CE:	+2.1
BW:	+4.6
WW:	+37.8
YW:	+69.8
MCE:	-0.2
Milk:	+13.3
TM:	+32.2

BANNERLANE 232 EXTRA GEN 60W BBSF 6P SPORT 232S
AGA 60W BANNER SPORT ZEAL 28Z BANNERLANE GENSTAR LASS 27R
 AGA 705 MISS EASYGOING 905W CTY EASY 705T
 AGA 114L MISS STAR GENERAL 47S

C 82F MICKS KAPTAIN 82K STANDARD 85A DOMINO 82F
AGA 82K MISS KAPTAIN ET 25T AC MISS 359 ROBINSON 63F
 AGA 85A MISS BRITISHER 74J LLL FE STD BRIT 85A
 AGA 852 MISS STANMORE ET 12C

What's not to like? 110D is a deep, wide-bodied, long son of 28Z with a very pleasant disposition. And you can't argue his red testicles and the 60/100 eye pigmentation... He was born to a beautiful, feminine, top-uddered daughter of the Corbiell bull, Micks Kaptain 82D. This heritage will pass on a level of dimension and scale to his progeny, so 110D will be a Dignified Sport indeed!



116

AGA 24W GEN WILEY'S DEPOT 116D

C03029046 U 116D APRIL 29 2016

BW:	82
205:	727
'18 EPDs	
CE:	+7.3
BW:	+2.4
WW:	+38.3
YW:	+61
MCE:	+2.5
Milk:	+24.1
TM:	+43.3

AGA 13G GENERAL 114L GEM GENERAL 13G
AGA 114L GENERAL WILEY 24W AGA 656U MISS STANDARD ET 17H
 AGA 118L MISS STANDARD 2R AGA 85J STANDARD 118L
 AGA 97J MISS RED EXTRA 203N

AGA 705 EASYGOING EXPRESS 67X CTY EASY 705T
AGA 67X MISS EXPRESS ET 13B AGA 21M MISS STANMORE 22T
 AGA 46E MISS BRITISHER 40T DP BRITISHER AGA 46E
 AGA 124J MISS STANDARD ET 32R

Stout, red, correct, this 24W son rolls out solid performance beneath a long curly haircoat. 13B is his very beautiful dam - extra deep, thick, easy-keeping, mossy, curly-coated with flat, well-placed quarters - special delivery from her dam, 40T. We sold a full flush brother of 13B to purebred breeder Matt Berry of Vita MT & he's working well for him. This younger protégé, 116D, scanned Marb 128 index & Yield 65.1. A top 15% of the breed for CE & top 10% for MARB EPD has this Depot looking for a new destination with either **heifers** or cows!



120

AGA 28Z SPORT DESIGNER 120D

C03029049 U 120D MAY 03 2016

BW:	81
205:	663
'18 EPDs	
CE:	+2.8
BW:	+4.5
WW:	+44.8
YW:	+74.9
MCE:	+0.2
Milk:	+13.3
TM:	+35.7

BANNERLANE 232 EXTRA GEN 60W BBSF 6P SPORT 232S
AGA 60W BANNER SPORT ZEAL 28Z BANNERLANE GENSTAR LASS 27R
 AGA 705 MISS EASYGOING 905W CTY EASY 705T
 AGA 114L MISS STAR GENERAL 47S

AGA 55C STANDARD 18Y SILVER STANDARD 55C
AGA 18Y MS BRIGHT STANDARD 94B MISS 46E BRITISHER AGA 22L
 AGA 114L MISS GENERAL 94T AGA 13G GENERAL 114L
 AGA 53A MISS STANDARD ET 152M

The pictures don't really do this fellow justice! He's loaded with eye-appeal, super red with red testicles, and extra deep! It's no surprise that he is a son of our goggle-eyed 28Z. The ultrasound scanner ranked him 2nd highest for Marbling in his group and his MARB EPD agrees with a top 15% of the breed EPD (also top 15% for Scrotal). He was born to a young dam, 94B, who fashioned him with the maternal strength and history of small teats on level udders of many generations back!



125

AGA 18Z ZOOM STAN DEEJAY 125D

C03029054 U 125D MAY 15 2016

BW:	86
205:	601
'18 EPDs	
CE:	-2.2
BW:	+4.1
WW:	+34
YW:	+52.2
MCE:	-1.1
Milk:	+17.1
TM:	+34.1

AGA 55C STANDARD 18Y SILVER STANDARD 55C
AGA 18Y ZOOM STANDARD 18Z MISS 46E BRITISHER AGA 22L
 AGA 21M MISS STANMORE 76S AGA 20J STANMORE 21M
 AGA 101J MISS STANDARD 140P

STANDRD LAD 656 4ET HI STANDARD LAD 20P
AGA 656 MISS STANDARD ET 106M BELL L 60H DOMINO LASS 82K
 AGA 22B MISS BRIGADER 511E CTY BRIGADER 22B
 AGA MISS 42X STANMORE 94Z

Introducing DeeJay 125D, a wide-topped and deep son of a favourite 18Z out of a beautiful dam, 106M, with a fantastic udder - even at the wonderful age of 16! Substance, mass, and awesome feet to boot - it's all here! Note the top 30% of the breed for Scrotal EPD, then tune in to the ultrasound scanning of Lean Meat Yield 64.9 for a good job done!

ULRICH HEREFORD RANCH COMING 2'S



127

AGA 18Z ZOOM STAN DIGITAL 127D

C03029056 U 127D MAY 16 2016

BW:	99
205:	622
'18 EPDs	
CE:	-4.2
BW:	+7.3
WW:	+46.5
YW:	+82.6
MCE:	-2.6
Milk:	+14.4
TM:	+37.7

AGA 55C STANDARD 18Y
AGA 18Y ZOOM STANDARD 18Z
AGA 21M MISS STANMORE 76S

AGA 13G GENERAL 114L
AGA 114L GEN'S X'S AND O'S 27X
AGA 97J MISS RED EXTRA 258P

SILVER STANDARD 55C
MISS 46E BRITISHER AGA 22L
AGA 20J STANMORE 21M
AGA 101J MISS STANDARD 140P
GEM GENERAL 13G
AGA 656U MISS STANDARD ET 17H
AGA 22B BRIGADER 97J
AGA 141J MISS STANDARD 191M

This fella has a little extra chrome splashed on his coat, but half of his testicles are red. Where it counts, he punches out that extra length and size along with correctness. He was born the middle of May to a big deep-bodied, big hipped 114L daughter, X'S AND O'S 27X. We all know how important 114L has been to our herd over many, many years... Now in the digital age, Residual Feed Intake looks even deeper and assigns 127D a great +106 RFI EPD for significant feed savings while still growing (top 25% PWG) and a top 30% Scrotal EPD to boot! :)



129

AGA 24W GEN WILEY'S DECOY 129D

C03029057 U 129D MAY 29 2016

BW:	75
205:	591
'18 EPDs	
CE:	+8.5
BW:	+1.2
WW:	+32
YW:	+51.6
MCE:	+2.2
Milk:	+24
TM:	+40

AGA 13G GENERAL 114L
AGA 114L GENERAL WILEY 24W
AGA 118L MISS STANDARD 2R

AGA 47F DOMINO ET 2Y
AGA 2Y MISS MO LE DOMINO 96B
AGA 60W MISS BANNER SPORT 14Z

GEM GENERAL 13G
AGA 656U MISS STANDARD ET 17H
AGA 85J STANDARD 118L
AGA 97J MISS RED EXTRA 203N
MR MO LE 47F
AGA 22B MISS BRIGADER 511E
BANNERLANE 232 EXTRA GEN 60W
AGA 114L MISS GENERAL 20X

129D will make a great heifer bull - don't miss that 75 lb BW! Although he's got light birthweights built in through both top & bottom of the pedigree, he's an attractive fella, featuring red testicles and hooded eyes (one with 100% pigmentation) while built on a stout structure with excellent feet & legs. You can't accuse 129D's good looks as being just a decoy - the EPDs rank his CE in the top 10% of the breed, BW top 15% and Marbling top 5%, while the ultrasound scanner scored him a 64.9 Lean Meat Yield. **Retaining in-herd interest.**



117Z - Dam of 60D



106M - Dam of 125D



25U - Dam of 105D



17W - Dam of 43D

ULRICH HEREFORD RANCH LONG YEARLINGS



603

AGA 203Y DR GREGORY PETE 603D

C03038554 U 603D SEPTEMBER 17 2016

BW:	63
205:	832
'18 EPDs	
CE:	+9.7
BW:	+0
WW:	+50.6
YW:	+80.2
MCE:	+7.9
Milk:	+27.2
TM:	+52.5

UPS DOMINO 3027
GCC PETE 203Y ET
LPG STANDARD 44B LASS 50H

CL 1 DOMINO 9126J 1ET
UPS MISS DIAMOND 1353
96 STANDARD 6A 25E
LPG COMMANDER 8080 LASS 59D

C 326N YES I CAN 127Y
AGA 127Y MS YES MAAM BEST 405B
AGA 21M MISS STANMORE 76S

BCD 140L DOM LAD 326N
LONE-PINE ICE QUEEN 55T
AGA 20J STANMORE 21M
AGA 101J MISS STANDARD 140P

Looking for a **heifer bull**? Call Dr 603D to do excellent work! His own birthweight was a remarkable 63 lb, yet was the top performing Fall bull at both weaning and yearling. He's built with lots of length and lots of frame, and has superb maternal strength and pedigrees both top & bottom. Want red? He's red - 100/80 eye pigmentation, red neck and red testicles. Want numbers? His credentials include top 5% of the breed for CE, top 5% BW, top 25% Milk, top 5% MCE & top 30% for Scrotal.



604

AGA 18Z ZOOM STAN DEVOUT 604D

C03038555 U 604D SEPTEMBER 17 2016

BW:	101
205:	648
'18 EPDs	
CE:	-6.5
BW:	+7.9
WW:	+55.4
YW:	+89.5
MCE:	-1.9
Milk:	+16.7
TM:	+44.4

AGA 55C STANDARD 18Y
AGA 18Y ZOOM STANDARD 18Z
AGA 21M MISS STANMORE 76S

SILVER STANDARD 55C
MISS 46E BRITISHER AGA 22L
AGA 20J STANMORE 21M
AGA 101J MISS STANDARD 140P

CTY BRIGADIER 22B
AGA 22B MISS RED DOMINO 22R
AGA 10K MISS STANDARD 230M

BAR PIPE BRIGADIER 19Y
LADY 66J B DOM 509
AGA 34Z STANDARD ET 10K
AGA 277D MISS STANDARD 830H

One goggle eye & red testicles outline this attractive, super-quiet & powerful 18Z son. He was orphaned at 2.5 months of age & left to fend for himself. He certainly missed out on his dam's outstanding milk throughout her superb lifetime. 8 of her sons avg'd 113 WN index & 7 sons avg'd 113.2 at YR; 2 dtrs avg'd 104.5 WN & 106.5 YR index. Even EPDs expect great things from 604D, with a top 30% of the breed for WW & top 30% for YW, plus above avg RFI EPD (+106) & PWG (+34). Devout 604D is an excellent survivor, committed to a great future!



605

AGA 203Y GREGORY PETE DEL 605D

C03038577 U 605D SEPTEMBER 18 2016

BW:	76
205:	789
'18 EPDs	
CE:	+8.3
BW:	+1.1
WW:	+42.8
YW:	+71.4
MCE:	+5.9
Milk:	+27.4
TM:	+48.8

UPS DOMINO 3027
GCC PETE 203Y ET
LPG STANDARD 44B LASS 50H

CL 1 DOMINO 9126J 1ET
UPS MISS DIAMOND 1353
96 STANDARD 6A 25E
LPG COMMANDER 8080 LASS 59D

BANNERLANE 232 EXTRA GEN 60W
AGA 60W MISS BANNER SPORT 420B
AGA 91L MISS STANDARD 148N

BBSF 6P SPORT 232S
BANNERLANE GENSTAR LASS 27R
AGA 191G STANDARD ET 91L
AGA 44C MISS SILVER 61G

Top 10% CE, top 15% BW, top 25% Milk, top 10% MCE, & top 25% MARB EPDs - 605D **can be used on heifers also** - says his own 76 lb BW & sire Pete 203Y, a light BW leader. 605D is impressive, not just with great performance, but he's attractive, short-marked with 1 goggle eye, the other pigmented 100%, & red testicles. He's really thick, with wide top, deep-body, with muscle in the pants, all supported by excellent feet. Dam 420B is tremendous, super easy-fleshing, feminine, & leaves incredible calves, starting with this whopper in Del!



607

AGA 203Y GREGORY PETE 607D

C03038578 U 607D SEPTEMBER 24 2016

BW:	71
205:	759
'18 EPDs	
CE:	+10.2
BW:	+0.9
WW:	+45.2
YW:	+73.3
MCE:	+7.2
Milk:	+25.9
TM:	+48.5

UPS DOMINO 3027
GCC PETE 203Y ET
LPG STANDARD 44B LASS 50H

CL 1 DOMINO 9126J 1ET
UPS MISS DIAMOND 1353
96 STANDARD 6A 25E
LPG COMMANDER 8080 LASS 59D

C 326N YES I CAN 127Y
AGA 127Y MS BEAN YES MAAM 408B
AGA 118L MISS STANDARD 2R

BCD 140L DOM LAD 326N
LONE-PINE ICE QUEEN 55T
AGA 85J STANDARD 118L
AGA 97J MISS RED EXTRA 203N

Recommended for heifers - no doubt! The foolproof 71 lb BW, son of Pete 203Y, & EPDs concur: Top 5% of the breed for CE, top 15% BW, top 30% Milk, top 5% MCE & top 20% for Marb! 607D is a correct, deep bodied, stout fella with red eyes, red testicles & soundness. Dam 408B is very nice, feminine cow with a thick hair coat & flawless udder from maternal generations including granddam 2R, who gave us Wiley 24W, who worked for many years in our herd producing beautiful females with gorgeous udders (see 24W herd sire photo & footnote).

ULRICH HEREFORD RANCH LONG YEARLINGS

609

AGA 203Y GREGORY PETE DUO 609D

C03038757 U 609D OCTOBER 01 2016

BW:	78
205:	694
'18 EPDs	
CE:	+4.5
BW:	+2.9
WW:	+42.9
YW:	+71.6
MCE:	+3.5
Milk:	+24.7
TM:	+46.2

UPS DOMINO 3027
GCC PETE 203Y ET
LPG STANDARD 44B LASS 50H

CL 1 DOMINO 9126J 1ET
UPS MISS DIAMOND 1353
96 STANDARD 6A 25E
LPG COMMANDER 8080 LASS 59D

AGA 18Y ZOOM STANDARD 18Z
AGA 18Z MS ZOOM STAN BETTY 60B
AGA 24W MISS GEN WILEY 144Y

AGA 55C STANDARD 18Y
AGA 21M MISS STANMORE 76S
AGA 114L GENERAL WILEY 24W
AGA 70N MISS BRIT DOM 33U

The 78 lb BW is surely compliments of the BW Trait Leader sire Pete 203Y! He's an attractive son, deep-bodied, wide-topped with thick quarters, soundness & red testicles. Couple the calving ease with the great volume and maternal traits, superb udders and sound feet on the dam's side too, and you've got Duo 609D, who's sure to pass these traits on... **Recommended for use on heifers** also (top 30% of the breed for CE EPD and top 30% for MCE)!



613

AGA 203Y GREGORY PETE 613D

C03039869 U 613D OCTOBER 13 2016

BW:	83
205:	741
'18 EPDs	
CE:	+5.1
BW:	+2.5
WW:	+42.7
YW:	+71.7
MCE:	+2.5
Milk:	+27.4
TM:	+48.8

UPS DOMINO 3027
GCC PETE 203Y ET
LPG STANDARD 44B LASS 50H

CL 1 DOMINO 9126J 1ET
UPS MISS DIAMOND 1353
96 STANDARD 6A 25E
LPG COMMANDER 8080 LASS 59D

AGA 114L GENERAL WILEY 24W
AGA 24W MS GEN WILEY BEEP 88B
AGA 60W MISS BANNER SPORT 44Z

AGA 13G GENERAL 114L
AGA 118L MISS STANDARD 2R
BANNERLANE 232 EXTRA GEN 60W
AGA 82K MISS KAPTAIN ET 1X

Here's a great **heifer bull**, born 83 lbs, sired by Pete 203Y, who has certainly accomplished a lot! 613D's got great muscle pattern, red testicles & 80/0 eye pigment; he's stout, short-marked and wears a great pant! The dam is a nice Wiley 24W female with a real tidy udder, so 613D has a nice blend of genetics with emphasis on maternal as we really prize those results. His CE and Milk EPDs are in the top 25% of the breed, and Marb top 15%!



22R - Dam of 604D



96B - Dam of 129D



2A - Dam of 6D



1T and Son 109D

ULRICH HEREFORD RANCH HEIFERS

5

AGA 203Y MS GREGORY PETE DI 5D

C03028948 U 5D MARCH 21 2016

BW:	58	UPS DOMINO 3027	CL 1 DOMINO 9126J 1ET
205:	632	GCC PETE 203Y ET	UPS MISS DIAMOND 1353
'18 EPDs		LPG STANDARD 44B LASS 50H	96 STANDARD 6A 25E
CE:	+11.9	MR MO LE 56 DOMINO LAD 60H	DOMINO STANDARD LAD 56B
BW:	-2.5	AGA 60H MS BOBBI MO DOMINO 38B	MISS MO LE 68D
WW:	+34.1	AGA 6N MISS STANDARD 50R	AGA 656 STANDARD ET 6N
YW:	+54.2		AGA 97J MISS RED EXTRA 9N
MCE:	+4.2	Hand-bred: June 19 - AGA 203Y PETE'S DYNAMO 86D	
Milk:	+27.5	Exposed: July 8 to Aug 21 - AGA 15H BRIT CANDIDATE ET 97C	
TM:	+44.6		

15

AGA 72S MISS BERT ANDY 15D

C03028958 U 15D MARCH 26 2016

BW:	81	96 ANDY 7L	96 ANDY 81F
205:	600	96 ANDY 72S	96 HANNA 9J
'18 EPDs		96 EVE 18N	DUNN'S 02C LAD 14E
CE:	+2.9		96 LADY 56E
BW:	+3	BANNERLANE 232 EXTRA GEN 60W	BBSF 6P SPORT 232S
WW:	+45.2	AGA 60W MISS BANNER SPORT 43Z	BANNERLANE GENSTAR LASS 27R
YW:	+68.2	AGA 114L MISS GENERAL 54U	AGA 13G GENERAL 114L
MCE:	+2.5		AGA 154F MISS BRITISHER 159H
Milk:	+15.1	Exposed: June 15 to Aug 21 - AGA 203Y GREGORY PETE DEEP 76D	
TM:	+37.7		

21

AGA 87W MS DIA WHAM DAPHNE 21D

C03028964 U 21D MARCH 27 2016

BW:	71	LFF 5L JACK HAMMER 26R	DIAMOND-T 25J LAD 5L
205:	629	AGA 26R WHAM HAMMER 87W	LFF 3B HI LITE EXTRA LASS 11E
'18 EPDs		AGA 44K MISS OLD DOMINO 252M	AGA 1S OLD DOMINO 44K
CE:	+4.3		AGA 102E MISS EXTRA 190K
BW:	+2	C 326N YES I CAN 127Y	BCD 140L DOM LAD 326N
WW:	+36	AGA 127Y MISS YES MAAM 319A	LONE-PINE ICE QUEEN 55T
YW:	+60.8	AGA 81S MISS RIBSTONE 61U	AGA 4P RIBSTONE 81S
MCE:	+0		AGA 97J MISS RED EXTRA 258P
Milk:	+13.2	Exposed: June 29 to Aug 21 - AGA 48A DEPENDABLE LAD 106D	
TM:	+31.2		

28

AGA 203Y MISS GREGORY PETE 28D

C03028969 U 28D MARCH 30 2016

BW:	76	UPS DOMINO 3027	CL 1 DOMINO 9126J 1ET
205:	595	GCC PETE 203Y ET	UPS MISS DIAMOND 1353
'18 EPDs		LPG STANDARD 44B LASS 50H	96 STANDARD 6A 25E
CE:	+6		LPG COMMANDER 8080 LASS 59D
BW:	+2	CTY EASY 705T	AGA 10S STANDARD 137Y
WW:	+40.8	AGA 705 MS EASYGOING BIRDY 62B	COURTNEY LASS J921
YW:	+66.9	AGA 21M MISS STANMORE 19R	AGA 20J STANMORE 21M
MCE:	+4.1		AGA 53L MISS RED DOMINO 218N
Milk:	+26.3	Al'd: June 15 - AGA 47F DOMINO ET 2Y	
TM:	+46.7	Exposed: July 4 to Aug 21 - AGA 15H BRIT CANDIDATE ET 97C	

40

AGA 20Y MISS BRIT STAN 40D

C03042863 U 40D APRIL 03 2016

BW:	108	LCI 68R RED STANDARD 109U	JNHR RED STANDARD 68R
205:	694	AGA 109U RIB STANDARD 20Y	LCI KD CRYSTAL 7N
'18 EPDs		AGA 70N MISS BRIT DOM 62S	AGA 79H BRIT DOM ET 70N
CE:	+3.9		AGA 44C MISS SILVER 61G
BW:	+7.8	AGA 26R STANMORE 5T	AGA 21M STANMORE 26R
WW:	+52.7	AGA 5T MISS STANMORE DOM 3W	AGA 53L MISS RED DOMINO 122R
YW:	+82.3	AGA 40Y MISS BRITISHER 88F	AGA 6U BRITISHER ET 40Y
MCE:	+0.3		AGA 303Y MISS STANDARD 67C
Milk:	+16.6	Al'd: June 23 - AGA 20J STANMORE 21M	
TM:	+43	Exposed: July 13 to Aug 21 - AGA 137A MO LE BRIT CHUCK 110C	

44

AGA 67X MS EXPRESS DAYSTAR 44D

C03028981 U 44D APRIL 04 2016

BW:	87	CTY EASY 705T	AGA 10S STANDARD 137Y
205:	609	AGA 705 EASYGOING EXPRESS 67X	COURTNEY LASS J921
'18 EPDs		AGA 21M MISS STANMORE 22T	AGA 20J STANMORE 21M
CE:	+0.9		AGA 207N MISS SILVER 9R
BW:	+4.8	AGA 13G GENERAL 114L	GEM GENERAL 13G
WW:	+41.1	AGA 114L MISS GENERAL 141X	AGA 656U MISS STANDARD ET 17H
YW:	+69.2	AGA 53L MISS RED DOMINO 116R	AGA 22B BRIGADER 53L
MCE:	+0.9		AGA 10B MISS BEAR 170M
Milk:	+20.4	Al'd: June 24 - AGA 47F DOMINO ET 2Y	
TM:	+41	Exposed: July 13 to Aug 21 - AGA 137A MO LE BRIT CHUCK 110C	

52

AGA 28X MISS SPORT ZEAL 52D

C03028987 U 52D APRIL 07 2016

BW:	83	BANNERLANE 232 EXTRA GEN 60W	BBSF 6P SPORT 232S
205:	596	AGA 60W BANNER SPORT ZEAL 28Z	BANNERLANE GENSTAR LASS 27R
'18 EPDs		AGA 705 MISS EASYGOING 905W	CTY EASY 705T
CE:	+1		AGA 114L MISS STAR GENERAL 47S
BW:	+4.2	C 326N YES I CAN 127Y	BCD 140L DOM LAD 326N
WW:	+42.1	AGA 127Y MISS YES MAAM 310A	LONE-PINE ICE QUEEN 55T
YW:	+70.5	AGA 65R MISS BRIT DOM 129T	AGA 70N BRIT DOM 65R
MCE:	+1.7		AGA 22B MISS BRIGADER ET 4L
Milk:	+15.5	Al'd: June 26 - AGA 20J STANMORE 21M	
TM:	+36.6	Exposed: : July 15 to Aug 21 - AGA 15H BRIT CANDIDATE ET 97C	

58

AGA 203Y MISS GREGORY PETE 58D

C03028992 U 58D APRIL 08 2016

BW:	69	UPS DOMINO 3027	CL 1 DOMINO 9126J 1ET
205:	627	GCC PETE 203Y ET	UPS MISS DIAMOND 1353
'18 EPDs		LPG STANDARD 44B LASS 50H	96 STANDARD 6A 25E
CE:	+6.2		LPG COMMANDER 8080 LASS 59D
BW:	+1.2	96 ANDY 72S	96 ANDY 7L
WW:	+46.4	AGA 72S MISS BERT ANDY BUN 18B	96 EVE 18N
YW:	+72	AGA 70N MISS BRIT DOM 62S	AGA 79H BRIT DOM ET 70N
MCE:	+3.3		AGA 44C MISS SILVER 61G
Milk:	+24.1	Al'd: June 22 - AGA 47F DOMINO ET 2Y	
TM:	+47.3	Exposed: July 10 to Aug 21 - AGA 15H BRIT CANDIDATE ET 97C	

HERD HEALTH

CLARESHOLM VETERINARY SERVICES, LTD.

Box 2350, Claresholm AB T0L 0T0 (403) 625-3677

K. WRIGHT, DVM C. FANCY, DVM K. VANDERVALK, DVM K. MATTERS, DVM

January 2018

Claresholm Veterinary Services Ltd. has been providing veterinary service and consultation for over 30 years to the Ulrich Hereford Ranch. The majority of the service consists of breeding soundness evaluations of the bulls and herd health consultation.

Health problems are minimized with a good vaccination program and excellent management. Calves are vaccinated with the Zoetis SelectVac Gold Plus vaccine program (the comprehensive program to protect against respiratory disease

and BVD) in the spring and fall. The replacement heifers and bulls receive Bovi-Shield Gold FP5-VL5 in the spring before breeding. The cow herd receives Bovi-Shield Gold FP5-VL5 prior to calving. Cows and heifers also receive a scour prevention vaccine annually.

Claresholm Veterinary Services Ltd. is proud to be associated with the Ulrich Hereford Ranch and their cattle operation.

Thank You TO OUR SPONSORS!

BUYER'S DRAW SPONSOR:



FOR ANIMALS. FOR HEALTH. FOR YOU.

16740 Trans-Canada Highway
Kirkland, QC, H9M 4M7
403.462.9972
1.800.999.2857 Ext 2836
steve.brander@zoetis.com
Visit Us: zoetis.com

Steve Brander
Senior Territory manager



Co-operative Limited

4424 - 2 Street E.
P.O. Box 8
Claresholm, Alberta T0L 0T0
www..net

SHELLEY O'NEIL

Agent
Claresholm / Nanton Agency
Skyline Petroleum Ltd.

Claresholm: (403) 625-3593
Nanton: (403) 646-2424
Cell: (403) 625-8952
Fax: (403) 625-4791
Home: (403) 625-3059



420 - 43rd Ave E, Box 667
Claresholm, AB
Canada T0L 0T0

Gord Lane CCA
Crop Production Advisor

Office: 403-625-3329
Toll Free: 1-800-661-5172
Cell: 403-489-0407
Fax: 403-625-4145
E-mail: gord.lane@cpsagu.ca

Dave Thorlakson

Business Development Manager
Dairy/Beef



Landmark Feeds Inc

Phone : (403) 329-3192
Cellular : (403) 308-3820
Fax : (403) 329-8046
Toll Free : (877) 750-2474

e-mail: dave.thorlakson@nutreco.ca

3102 - 12th Ave. N.
Lethbridge, AB
Canada T1H 5V1

ALL-STAR BREEDER

We at Ulrich Herefords are pleased to have been awarded the status of Five-Star Breeder, the highest possible, and 1 of only 37 operations across Canada to do so! This simply means that we have completely & accurately reported 5 traits: Calving Ease, Birthweights, Weaning Weights, Yearling Weights and Ultrasound on our entire calf crop.





86R - Dam of 85D



129X - Dam of 87D

WHAT IS AN EPD?

Expected Progeny Differences (EPDs) are genetic predictions producers can use when making selection decisions. These values are available on performance animals from breed associations. ***It is important to understand you cannot compare EPDs between breeds, only within a breed.*** A buyer is always advised to use more than just the EPDs regardless of accuracy when making purchase decisions.

An Expected Progeny Difference (EPD) is a measure of the genetic merit of an animal using relevant performance and pedigree information. EPDs are expressed in the units of measure. For example, birth weight is expressed in pounds, and rib-eye area is expressed in square inches.

EPDs come from performance data. Producers submit data on their cattle. From this data, researchers look at the differences between animals raised in the same environment (contemporary groups) and ascertain the portion of that difference that is due to genetics (heritability). Also included in this is how the different traits relate to each other and interact together (correlations). They can then directly compare genetic differences among animals using the pedigree information contained in the CHA and AHA registries. The result is a value that can be directly compared between animals and across environments, an EPD.



Catalogue Design by
Coyote Publishing
Ph: 403.394.4481
www.coyotepub.com

EPD'S USED IN THIS CATALOGUE

Calving Ease EPD (CE) - calculated using birth weight and calving ease score information. Calving ease EPDs represent the ease with which progeny of an animal are born to first calf heifers. The EPD is expressed as a percent probability, with a higher value representing calves with a higher probability of being born unassisted.

Birth Weight EPD (BW) - is an indicator of calving ease. Higher birth weight EPDs usually indicates more calving difficulty.

Weaning Weight EPD (WW) - reflects progeny growth differences up to 205-days.

Yearling Weight EPD (YW) - reflects progeny growth differences through to 365-days.

Milk EPD (Milk) - indicates the ability of a sire's daughters to provide their calves with an environment that encourages growth from birth to weaning, through mothering ability and milk production. This EPD is expressed in the expected difference in pounds of calf at weaning.

Total Maternal EPD (TM) - also known as Milk + Growth, this EPD combines the milk EPD plus 1/2 the Weaning Weight EPD. It is expressed in pounds of calf weaned at 205-Days and combines the genetics for pre-weaning growth and the influence of the maternal environment on the weaning weight of the daughter's progeny.

Maternal Calving Ease EPD (MCE) - represents the ease with which a sire's daughters will calve as first calf heifers, when compared to daughters of other sires. The EPD is expressed as a percent probability, with a higher value representing daughters with a higher probability of unassisted calving.

COMPARABILITY OF EPD'S

EPDs from Hereford animals are directly comparable to other Herefords in North America and parts of South America, due to the inclusion of data from Canada, United States, Uruguay & Argentina. As well, **it is important to remember that Hereford EPDs are NOT directly comparable to EPDs produced by different breeds, such as Angus or Simmental.**



ULRICH HEREFORD RANCH INC.

Box 843, Claresholm, AB T0L 0T0

CANADA

POSTES

POST

CANADA



Postage paid

Personalized
Mail

Port payé

Courrier
personnalisé

8412225



WWW.ULRICHHEREFORDS.COM

PRINTED IN CANADA / FOR FREE DISTRIBUTION