

*Specializing in* **LIGHT BIRTHWEIGHTS** *with* **GREAT PERFORMANCE** *plus* **REMARKABLE COWS**

11TH ANNUAL  
**ULRICH**  
**HEREFORDS**  
*Bull Sale*



**48** REGISTERED 2 YEAR OLD  
& LONG YEARLING BULLS

**FEBRUARY 21** **TUESDAY**  
**2017** **1:00PM MST**  
**BALOG AUCTION**  
**LETHBRIDGE**

**ULRICH HEREFORD RANCH INC.**

Peter Ulrich 403-625-1036 Hans & Annette Ulrich 403-625-2237 Email [peter@ulrichherefords.com](mailto:peter@ulrichherefords.com)

[www.ulrichherefords.com](http://www.ulrichherefords.com)



11th Annual  
**ULRICH HEREFORDS**  
BULL SALE

**48 HEAD ON OFFER!**

48 Coming Two & Long Yearling Hereford Bulls

FEBRUARY  
**21**

**BALOG AUCTION • LETHBRIDGE, ALBERTA**

Sale Time: 1:00 pm (MST) Join us for Lunch: 11:30 a.m.

**SALE DAY PHONES:**  
Balog Auction - 403-320-1980  
Peter's Cell - 403-625-1036

**SALE STAFF:**

Bob Balog..... Auctioneer..... 403-320-1980  
Louis Balog..... Ring Staff..... 403-320-1980  
Lander Nicodemus..... Ring Staff..... 307-421-8141

**ACCOMMODATIONS:**

Ramada Inn..... 403-380-5050  
2375 Mayor Magrath Drive S. - mention Balog Auction for special room rate

**VIEWING THE BULLS:**

We welcome you to stop by the ranch any time prior to Sale Day to view our operation and see the bulls.

**PLEASE JOIN US EARLY SALE DAY:**

For presale viewing followed by lunch at 11:30 a.m.

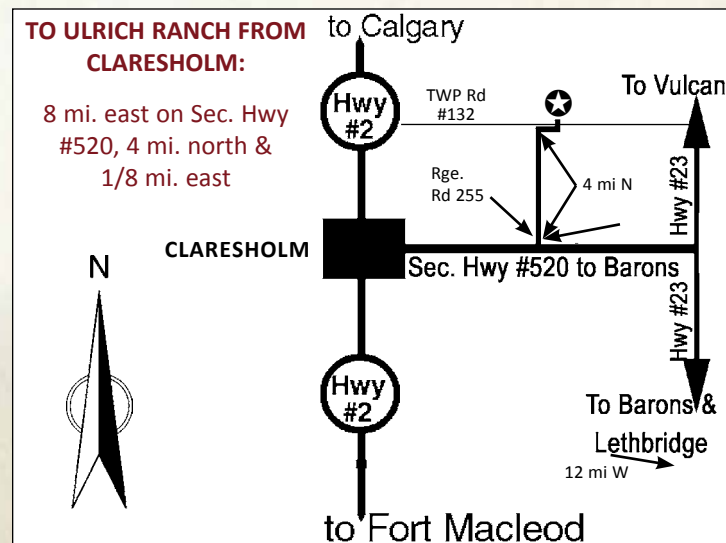

**ULRICH HEREFORD RANCH INC.**

Box 843, Claresholm, AB T0L 0T0  
Peter Ulrich: 403-625-1036  
Email: peter@ulrichherefords.com  
Hans & Annette Ulrich - Ph: 403-625-2237

**Can't make it to the sale?**  
**Internet Bidding Available.**

To view this sale visit [www.dlms.ca](http://www.dlms.ca), Fill out the registration form located under registration and sign-up for your free user account and select a username and password.

**BIDDERS** - To be approved as a bidder, Log in to [dlms.ca](http://dlms.ca) and click BUYER APPROVAL tab, select the sale you are interested in bidding at and click sign up.

For more information  
Call DLMS Reps:

Whitney Bosovich 780.991-3025

Mark Shologan 780.699.5082

**DLMS**  
[www.dlms.ca](http://www.dlms.ca)

**SPECIAL POINTS TO NOTE:**

- **No bulls sell at Calgary or Medicine Hat - All of our best are in this sale!**
- All bulls are semen tested before sale
- **Credit of \$100** per bull to purchasers who take bulls from the sale.
- **Delivery:** Delivery to central points in Alberta at seller's convenience. Out of province purchases delivered by commercial hauler at shared cost.
- We strongly recommend that bulls be insured - an insurance agent will be available at the sale.
- **Flying In?** If flying into the Lethbridge Airport, call Balog Auction for pick-up: 1-403-320-1980.
- **Ultrasound Information** has been collected on most of these bulls as yearlings and will be available sale day or can be obtained prior to the sale by calling Peter at 403-625-1036. **Complete EPDs** (beyond those shown in this catalogue) are also available.

★ ★ ★  
**Sight Unseen Purchase Plan:**

If you are unable to attend the sale, please contact us or any of the sale staff with instructions to purchase on your behalf.



**U  
H  
Ri**



# WELCOME to

# ULRICH HEREFORD RANCH

## 11TH ANNUAL BULL SALE



**Peter Ulrich**  
Cell: 403-625-1036



**Hans & Annette  
Ulrich**  
PH: 403-625-2237

Another year has come & gone and it's hard to believe it's time for yet another Annual Bull Sale - the 11th! Each year brings new challenges, whether it's the weather or operational expenses of ranching in southern Alberta.

Calving was exceptionally good last year, thanks to a very mild spring with very little moisture. Unfortunately, the dryness continued into the summer. The rain clouds seemed to consistently skirt our ranch and a few neighbors so it was a tough year for grass. When a little rain did come, so did the hail! As a surprise blessing, the hail shelled many of the kernels before we silaged the barley, so some late rain germinated the seeds and produced some great fall grazing for the cows! This also meant rounding up a fencing crew to enclose a 1/2 section, but the hard work and camaraderie served to provide secure grazing (& friendships) for many years to come...

We were pleased to again enter some yearling bulls in the CHA's RFI Trial at Olds and Cattleland (Strathmore). Besides measuring Residual Feed Intake (RFI), it also served to provide a respite for the lack of feed at home. In fact, we ended up leaving 20 head at the feedlot after the trial on silage & hay, due to the grass shortage. When they came home, we had to run them on some 2nd cut oat pasture after baling the green feed. Regardless, we now have a really good set of bulls to offer on Feb 21st!

You'll see us refer to the new RFI EPDs on some of our sale bulls. We've been pleased that the vast majority of our bulls have tested above average! RFI identifies animals with lower maintenance

requirements. Keeping an eye on the PWG (Post Weaning Gain) ensures we can select for efficient cattle along with the ability to gain - enabling all cattlemen to reduce feed costs.

Ulrich calves are raised on milk & grass - no creep feed here. Now over the winter, these 48 comin' 2-yr-olds, and long yearlings have been getting hay, barley silage and Landmark Feed's "Bull's Eye" backgrounding pellets, designed for growing animals. We have chosen to follow a non-medicated program, to grow out, not push these youngsters - preparing them for their real work in the spring.

We are again 5-Star status breeders at the CHA this year, by faithfully reporting performance data. Unfortunately, the number crunchers aren't very gracious to the old predictable workin' bulls that we like to cross with the newer genetics. Even though this gives some of the EPDs a beating, we believe this old/new breeding makes even better animals with more capacity, longevity, hardiness & femininity.

Please note that the EPDs here are the most current available at time of printing. The CHA is doing 6 EPD runs again in 2017, so this means that new EPDs will be released mid-Feb and could differ slightly from those published in this catalogue. Semen testing results along with scrotal measurements and new weights will be available on sale day.

This winter, we've had more snow & cold than usual, so it looks promising for next spring! Again, we thank God for the blessings of the past year and the health & strength to continue in this ranching lifestyle - how wonderful to have the original generation still involved... (Thank you, Mom & Dad!) We're also extremely grateful to you, our buyers & bidders - Thank you all for your support! We look forward to seeing you on Feb 21st!

Sincerely,

*Peter Ulrich and Hans & Annette Ulrich*

### PLEASE NOTE

Pictures of the dams of many of the sale bulls, as well as updated sale information and a downloadable version of this catalogue is available at our website:

**www.ulrichherefords.com**

### TERMS & CONDITIONS

**TERMS** - The terms of the sale are cash or cheque payable at Lethbridge, AB, on Sale Day. The right of property shall not pass until settlement is made. All settlements must be made with the clerks of the sale before any cattle will be released. For US export, USDA and individual state rules will apply.

**BIDS** - Every animal entering the sale ring will be sold to the highest bidder. A floor price will apply to each animal consigned.

**DISPUTES** - In case of disputes, bidding will be reopened between the parties involved. If no further bid is made, the buyer will be the person from whom the auctioneer accepted the last bid. The auctioneer's decision in such matters will be final.

**PURCHASER'S RISK** - Each animal becomes the risk of the purchaser as soon as sold.

**ANNOUNCEMENTS** - Errors discovered in the catalogue will be corrected by announcements from the Auction Stand at sale time and such corrections will take precedence over the printed matter in the catalogue.

**CERTIFICATE OF REGISTRY** - A certificate of registry duly transferred will be furnished to the buyer for each animal after settlement is made.

**SHIPPING** - Assistance will be given in making shipment after the sale, but no risk is assumed by Balog Auction, or the seller. **Delivery to central points in Alberta will be made at seller's convenience. Out-of-province purchases will be delivered by commercial hauler at shared cost.** Any additional expenses are the responsibility of the buyer, including duty, brokerage fees, etc.

**BREEDER'S GUARANTEE** - The consignors have done everything possible to assure you, the buyer, that every bull in this sale will be a breeder. A certified veterinarian has semen tested and physically evaluated every bull. However, should a problem arise, please inform the seller so further arrangements may be made.

**ACCIDENTS** - Although every precaution will be taken to protect the safety and comfort of buyers, neither the sales manager, auctioneer nor any owner assumes any responsibility in this matter and disclaims any liability, legal or otherwise, in the event of accident or loss of property.

**LIABILITY** - Balog Auction is acting as agent only and assumes no responsibility for representations made by the seller. Purchasers must look to the seller for fulfillment of all guarantees and representations made hereunder.

### SPECIAL POINTS to REMEMBER:

- No creep feed
- No hormones or medicated feed!
- Backgrounded, not pushed!

### KEY TO PERFORMANCE TERMS USED HEREIN:

**BW:** Actual Birth Weight in Pounds  
**205:** Weaning Weight in lbs adjusted to 205 Days  
**365:** Yearling Weight in lbs adjusted to 365 days  
**RFI:** Residual Feed Intake (feed efficiency)  
**PWG:** Post Weaning Gain (difference between WN & YR)  
**LMY:** Lean Meat Yield

# ULRICH HEREFORD RANCH REFERENCE SIREs

## A

### 46E BRITISHER AGA 15H

C01655485 XUB 15H MARCH 12 1976

BW:	
205:	771
365:	1150
'17 EPDs	
CE:	+5.2
BW:	-2.2
WW:	+19.8
YW:	+40.6
MCE:	-0.6
Milk:	+8
TM:	+17.9

DOMINO STANDARD DP LAD 45	RIBSTONE DOMINO LAD 1G
DP BRITISHER AGA 46E	STANDARD E DOMINO 33R
BRITISHER WETMORE LADY AGA 5A	JH REAL BRITISHER
	DOUBLE MISS WETMORE AGA 61W
DOMINO STANDARD DP LAD 45	RIBSTONE DOMINO LAD 1G
MISS DP AGA 121E	STANDARD E DOMINO 33R
LADY BRITISHER AGA 29U	BRITISHER MISCHIEF'S IMAGE 13P
	BRITISHER LADY 7P

Top % of Breed for: CE 5%, (BW 1% Stay 3% MPI 15% all **Trait Leaders**)  
Home raised in '76, 15H was a big red double-bred son of the popular 46E(136 WN indx, 125 YR indx). His progeny had volume & capacity, performance & muscling - great gains in the breed. His great females had tight, level udders, small, well-placed teats & better feet; his sons out-performed their peers. Hereford hardiness & doing ability with depth & muscling is trending again today - udders, legs & feet now compete with other breeds. 15H is still a great contributor! **Lot 107C**

## D

### 96 ANDY 72S

C02887424 CHB 72S APRIL 16 2006

BW:	96
205:	865
365:	
'17 EPDs	
CE:	-0.3
BW:	+3.7
WW:	+50.5
YW:	+68.5
MCE:	-1.7
Milk:	+14.1
TM:	+39.4

96 ANDY 81F	96 STANDARD ADVANCE 81N
96 ANDY 7L	96 LADY 48D
96 HANNA 9J	HH HOME BUILDER 603
	96 STANDARD LASS 24E
DUNN'S 02C LAD 14E	DUNN'S 10Y LAD 02C
96 EVE 18N	DUNN'S SPARTAN LADY 28C
96 LADY 56E	96 LANDMARK 50A
	96 PRISCILLA ET 10B

We purchased some 96 ANDY 72S semen from Bert Anderson of Sceptre, SK but unfortunately the bull died before we could picture him. His offspring certainly have really nice heads, good feet, legs and good heels - important for longevity in any herd. His progeny are born with moderate birthweights - all unassisted! Both males & females make a real uniform bunch of 72S progeny. **Lots 11C, 46C, & 64C**

## B

### AGA 22B BRIGADIER 53L

C02795500 ALNK 53L FEBRUARY 15 2001

BW:	108
205:	785
365:	1286
'17 EPDs	
CE:	-0.1
BW:	+5.2
WW:	+39.7
YW:	+74.8
MCE:	+0.7
Milk:	+18.1
TM:	+38

BAR PIPE BRIGADIER 19Y	BP RED STANDARD 137W
CTY BRIGADIER 22B	BP MISS EXTRA 205W
LADY 66J B DOM 509	BELL L 85B DOMINO 66J
	MISS ARDMORE 6209
AGA 28Z DOMINO 189C	LLL 30W DOM STANDARD 28Z
AGA 189C MISS DOMINO 4E	MISS 4S STANDARD AGA 9U
AGA 852 MISS STANMORE ET 5C	CTY K STANMORE X852
	MISS 51K BRITISHER AGA 61N

Top % of Breed for: FMI Top 30% RFI 20% (Residual Feed Intake) PWG 30%  
53L was Grand Champion at the 2003 Medicine Hat Bull Sale. He sold to Gary Hoffman in the States, but the border closing (BSE) granted us the wonderful opportunity to use him ourselves and draw some semen before he was sold to Hollywood Herefords in Regina, SK. His offspring have lots of pigment and good thickness. His daughters provide plenty of rich milk from excellent udders, and are easy keeping. **Lot 22C**



SIRE E: PICTURED AT COMING 2 YEARS OF AGE

## C

### PDHR 20J STANMORE 47R

C02867004 DALC 47R FEBRUARY 18 2005

BW:	98
205:	691
365:	1030
'17 EPDs	
CE:	+2.7
BW:	+2.2
WW:	+42.3
YW:	+68
MCE:	+1.3
Milk:	+29.9
TM:	+51.1

AGA 4016D STANMORE 121G	CTY K STANMORE 4016D
AGA 121G STANMORE 20J	AGA 99B CENTENNIAL 51D
AGA 40E MISS STANMORE 80G	AGA 9012 STANMORE 40E
	AGA 16B MISS GENERATOR 20E
C 18C GENERAL D LAD 80G	GENERATING STAR 18C
PDHR 80G GENERAL LASS 91K	AC MISS 10U STD COMMANDER 30Y
PDHR MISS 40B DIAMOND 92E	JNHR DIAMOND 40B
	PDHR MISS 18Y DOMINO LASS 53B

Top % of Breed for: CE 30%, Milk 15%, TM 30%, MPI 30% FMI 10% (**Trait Leader**)RFI 3%, REA 25% We got some PDHR 20J STANMORE 47R semen from Leachman's and used it to flush AGA 70N MISS BRIT DOM 62S. ALNK 37C & 38C here in this sale are the result! They are a very similar build to 47R - a moderate size, yet length plus depth, and lots of quarters, red testicles and well-made... 47R's sons look good - he did a good job! Come on by and take a look at them! **Lots 37C & 38C**

## E

### AGA 114L GENERAL 105T

C02903274 ALNK 105T MARCH 30 2007

BW:	104
205:	658
365:	997
'17 EPDs	
CE:	-4.6
BW:	+9.2
WW:	+51.8
YW:	+86.6
MCE:	+1
Milk:	+12.6
TM:	+38.5

GEM GENERAL 13G	GENERATOR STANDARD 10A
AGA 13G GENERAL 114L	AD 75N LASS 31W
AGA 656U MISS STANDARD ET 17H	STANDRD LAD 656 4ET
	AGA MISS 80S VOLTAGE ET 14X
AGA 4016D STANMORE 4K	CTY K STANMORE 4016D
AGA 4K MISS STANMORE 221N	AGA 67Z MISS CENTENNIAL 52D
AGA 44C MISS SILVER 85G	SNS SILVER PRINCE 44C
	AGA 67Z MISS CENTENNIAL ET 18D

Top % of Breed for: SC 30% PWG 30%  
A son of the great 114L, 105T is a handsome fellow, not just in his structure & muscling (lots of muscle and meat over the top, wide in the pins, muscle down the quarters & pants that bulge) but also holds a beautiful yet masculine head. Great length, yellow haircoat, deep ribs with extra eye-appeal and pigmentation all add up to make him really special. 105T comes from a beautiful mother of thick mossy long hair and a flat udder with teats small & set well apart & in every corner. **Lot 41C**



# ULRICH HEREFORD RANCH REFERENCE SIRES



**SIRE F**

**F**

## AGA 114L GENERAL WILEY 24W

C02931573 ALNK 24W MARCH 11 2009

<b>BW:</b>	<b>70</b>
<b>205:</b>	<b>714</b>
<b>365:</b>	<b>1081</b>
<b>'17 EPDs</b>	
<b>CE:</b>	<b>+0.8</b>
<b>BW:</b>	<b>+1.6</b>
<b>WW:</b>	<b>+29.6</b>
<b>YW:</b>	<b>+53.8</b>
<b>MCE:</b>	<b>+2.8</b>
<b>Milk:</b>	<b>+27.4</b>
<b>TM:</b>	<b>+42.2</b>

GEM GENERAL 13G  
**AGA 13G GENERAL 114L**  
AGA 656U MISS STANDARD ET 17H  
  
AGA 85J STANDARD 118L  
**AGA 118L MISS STANDARD 2R**  
AGA 97J MISS RED EXTRA 203N  
  
GENERATOR STANDARD 10A  
AD 75N LASS 31W  
STANDRD LAD 656 4ET  
AGA MISS 80S VOLTAGE ET 14X  
AGA 191G STANDARD 85J  
AGA 40Y MISS BRITISHER 168F  
AGA 22B BRIGADER 97J  
AGA 15H MISS BRITISHER 106L

Top % of Breed for: BW 15% (**Trait Leader**) Milk 20% , MCE 25% Top 1% (TL) MPI 5% (TL) MARB 5%

Wiley has excellent CE & light BW genetics! Offspring are vigorous at birth, thick, compact & well-marked with excellent pigment. A strong maternal factor is evidenced by his own fantastic feminine mother's (2R) super, flat, tight udder & small teats on each corner. Her consistent calves' avg'd 76 lb BW yet above avg WN. Don't miss 24W's MARB EPD of 0.32, (2014 progeny avg'd 139 MARB index), **Lot 112C**



**SIRE H: PICTURED AT COMING 2 YEARS OF AGE**

**H**

## AGA 705 EASYGOING EXPRESS 67X

C02945701 ALNK 67X MARCH 20 2010

<b>BW:</b>	<b>89</b>
<b>205:</b>	<b>706</b>
<b>365:</b>	<b>1032</b>
<b>'17 EPDs</b>	
<b>CE:</b>	<b>+1.9</b>
<b>BW:</b>	<b>+3.4</b>
<b>WW:</b>	<b>+40.7</b>
<b>YW:</b>	<b>+67.7</b>
<b>MCE:</b>	<b>+1.8</b>
<b>Milk:</b>	<b>+21.1</b>
<b>TM:</b>	<b>+41.5</b>

AGA 10S STANDARD 137Y  
**CTY EASY 705T**  
COURTNEY LASS J921

AGA 20J STANMORE 21M  
**AGA 21M MISS STANMORE 22T**  
AGA 207N MISS SILVER 9R

SJSL HI 20 STAND LAD 10S  
GU MISS 46E BRITISHER 10K  
SNS SUPER SILVER 35D  
COURTNEY LASS E522  
AGA 121G STANMORE 20J  
AGA 5C MISS ENERLAD 68K  
AGA 35J SILVER PRIDE 207N  
AGA 53A MISS STANDARD ET 152M

Top % of Breed for: RFI top 20% (Residual Feed Intake) , MARB 25% Goggle-eyed, & red to the toes with pigmented feet, this was a stout son of 705! Extra thick in his butt and over the top, he was an impressive bull. He held his head up, bright & alert but was calm as a house kitten. Great doing ability was evident, and great carcass numbers concurred (3rd in Ribeye, and 128 index Marb)! The dam brought 21M light birth-weight genetics and provided rich, rich milk from a great udder. 67X is also co-owned with Bert Anderson. **Lots 10C, 26C, & 70C**



**SIRE G**

**G**

## AGA 26R WHAM HAMMER 87W

C02933144 ALNK 87W APRIL 06 2009

<b>BW:</b>	<b>86</b>
<b>205:</b>	<b>671</b>
<b>365:</b>	<b>1077</b>
<b>'17 EPDs</b>	
<b>CE:</b>	<b>+1.2</b>
<b>BW:</b>	<b>+1.7</b>
<b>WW:</b>	<b>+22.5</b>
<b>YW:</b>	<b>+44.3</b>
<b>MCE:</b>	<b>+0</b>
<b>Milk:</b>	<b>+14.7</b>
<b>TM:</b>	<b>+26</b>

DIAMOND-T 25J LAD 5L  
**LFF 5L JACK HAMMER 26R**  
LFF 3B HI LITE EXTRA LASS 11E  
  
AGA 1S OLD DOMINO 44K  
**AGA 44K MISS OLD DOMINO 252M**  
AGA 102E MISS EXTRA 190K  
  
DIAMOND-T 127C LAD 25J  
DIAMOND-T DOM BRIT 5E  
SJSL HI LITE SUPER LAD 3B  
LFF 16Z EXTRA LASS 3C  
HU WETMORE DOMINO 1S  
AGA 656U MISS STANDARD ET 17H  
FE 27A EXTRA 102E  
AGA 189C MISS DOMINO 22F

Top % of Breed for: BW 20%, RFI 5% (Residual Feed Intake)  
What can he do? Produce thick meaty bulls with pants & wide tops and moderate-sized heifers, deep, sound & easy keeping with great udders. Why? 87W himself has a moderate birthweight, outstanding natural thickness, depth and length, good feet, quarters, & pants, performance, RibEye, Marbling and can pass it on! He multiplies the best attributes of his sire Jack Hammer 26R and his Old Domino 252M dam to produce beef-makers on both sides of a pedigree! **Lots 104C & 115C**



**ALNK 62S – dam of ALNK 39A, 37C, & 38C**

**Catalogue Available Online**

**[www.ulrichherefords.com](http://www.ulrichherefords.com)**

**[or www.coyotepub.com](http://www.coyotepub.com)**



# ULRICH HEREFORD RANCH REFERENCE SIRES



**SIRE J: PICTURED AT COMING 2 YEARS OF AGE**

**J**

## AGA 77J SUPERMAN 48Y

C02958839 ALNK 48Y MARCH 17 2011

<b>BW:</b>	<b>86</b>
<b>205:</b>	<b>701</b>
<b>365:</b>	<b>1018</b>
<b>'17 EPDs</b>	
<b>CE:</b>	<b>-0.1</b>
<b>BW:</b>	<b>+3.5</b>
<b>WW:</b>	<b>+53.2</b>
<b>YW:</b>	<b>+77.6</b>
<b>MCE:</b>	<b>+2.8</b>
<b>Milk:</b>	<b>+19.9</b>
<b>TM:</b>	<b>+46.5</b>

FE 07Y SUPER 129D  
**CC 129D SUPERMAN 77J**  
CC 42W JULIANA 66Z

JDA 15W SKYWALKER 07Y  
FE 412 DANDY 56X  
DMF 81N STANDARD 42W  
CC ARROW BRITISHER LASS 47T  
AGA 121G STANMORE 20J  
AGA 5C MISS ENERLAD 68K  
STANDRD LAD 656 4ET  
AGA 852 MISS STANMORE 22C

AGA 20J STANMORE 21M  
**AGA 21M MISS STANMORE 88S**  
AGA 656U MISS STANDARD ET 75P

Top % of Breed for: MCE 25%, STAY 15% MPI 15% MARB 10%  
86 lb BW, 112 WN indx, 110 YR indx, MARB #1, & 107 REA index, overlaid with well-marked depth of body, wide loin, thick quarters and smooth overall and you've got 48Y. "Mom" is a yellow 21M daughter, moderate sized, with a level bag & small well-placed teats. Superman 77J was a great AI sire, and a son, 26T, (used naturally), left us high performance sons with pigment & the heifers make great cows. Curverbender/Heifer bull **Lot 47C**



**SIRE L**

**L**

## GCC PETE 203Y ET

C02978686 203Y FEBRUARY 03 2011

<b>BW:</b>	
<b>205:</b>	
<b>365:</b>	
<b>'17 EPDs</b>	
<b>CE:</b>	<b>+7.1</b>
<b>BW:</b>	<b>-2.7</b>
<b>WW:</b>	<b>+40.5</b>
<b>YW:</b>	<b>+73.7</b>
<b>MCE:</b>	<b>+5.9</b>
<b>Milk:</b>	<b>+33.3</b>
<b>TM:</b>	<b>+53.6</b>

CL 1 DOMINO 9126J 1ET  
**UPS DOMINO 3027**  
UPS MISS DIAMOND 1353

96 STANDARD 6A 25E  
**LPG STANDARD 44B LASS 50H**  
LPG COMMANDER 8080 LASS 59D

HH ADVANCE 767G 1ET  
CL 1 DOMINETTE 490  
SH DIAMOND 881  
UPS MS MILEHIGH 8330  
BP BRIGADIER 42B  
96 SANDY ET 6A  
LPG COMMANDER 44B  
LPG 8080 LASS 21A

Top % of Breed for: CE 2%, BW 1% (TL), Milk 4%, TM 25%, MCE 1%, SC 20%, Stay 3% (TL), MPI 1% (TL) FMI 25%, MARB 25%  
Stout, stout & stout stacked on top of Calving Ease - see Pete's top EPDs above, plus plenty of marbling thrown in for good measure (+0.17 MARB EPD). A look at Birth Averages over his lifetime shows 51 males born averaging 78 lbs, and 58 females born averaging 71 lbs. All these youngsters display that vigour that Pete stamps on newborn calves! **Lots 40C, 56C, 58C, 86C, 87C, 100C, & 138C**



**SIRE K**

**K**

## CFH 2W HL LAD 131Y

C02960680 TLS 131Y MARCH 09 2011

<b>BW:</b>	<b>108</b>
<b>205:</b>	<b>790</b>
<b>365:</b>	<b>1047</b>
<b>'17 EPDs</b>	
<b>CE:</b>	<b>+1.5</b>
<b>BW:</b>	<b>+7</b>
<b>WW:</b>	<b>+49.4</b>
<b>YW:</b>	<b>+80.4</b>
<b>MCE:</b>	<b>+1.6</b>
<b>Milk:</b>	<b>+35.1</b>
<b>TM:</b>	<b>+59.8</b>

MHH 011H BRIT LAD 46R  
**LPG HERMAN LORD LAD 2W**  
LPG LANDLORD G44B LASS 50S

MN 26E SIL BRITISH 011H  
MHH 262B HI-VOLTAGE LASS 8G  
BCD 59J LANDLORD 114L  
LPG COMMANDER 8080 LASS 59D  
STANDARD 16E RIBSTONE 64H  
K 61Z SUPER LADY 41G  
BP GOVERNOR 33B  
CFH HIGH TECH BRIT LASS 027Z

K 64H RIBSTONE LAD 157K  
**CFH 157K MISS HI TECH 309N**  
CFH 33B MISS HIGH TECH 114L

Top % of Breed for: Milk 2% TM 10%, SC 20%, FMI, 25%, RFI 15%, MARB 20%  
We purchased this Conway bull as a calf at their dispersal sale. He's been breeding solid offspring with impressive EPDs in both Weaning and Yearling, as well as Milk and Total Maternal and Marbling (+0.18)

Floyd & Darryl Anderson now also co-own this bull.

**Lot 80C**



**SIRE M**

**M**

## AGA 18Y ZOOM STANDARD 18Z

C02969377 ALNK 18Z MARCH 13 2012

<b>BW:</b>	<b>94</b>
<b>205:</b>	<b>758</b>
<b>365:</b>	<b>1112</b>
<b>'17 EPDs</b>	
<b>CE:</b>	<b>-0.2</b>
<b>BW:</b>	<b>+4.9</b>
<b>WW:</b>	<b>+46.8</b>
<b>YW:</b>	<b>+69.7</b>
<b>MCE:</b>	<b>+1.6</b>
<b>Milk:</b>	<b>+19.1</b>
<b>TM:</b>	<b>+42.5</b>

SILVER STANDARD 55C  
**AGA 55C STANDARD 18Y**  
MISS 46E BRITISHER AGA 22L

AGA 20J STANMORE 21M  
**AGA 21M MISS STANMORE 76S**  
AGA 101J MISS STANDARD 140P

STANDARD INTENSE 36T  
VERN LADY 4X  
DP BRITISHER AGA 46E  
PINE COULEE MISCHIEF LADY 397  
AGA 121G STANMORE 20J  
AGA 5C MISS ENERLAD 68K  
AGA 656U STANDARD ET 101J  
AGA 22B MISS BRIGADIER 511E

Top % of Breed for: STAY 15% (Trait Leader), MPI 25%, RFI 4% (Residual Feed Intake) Zoom 18Z exudes performance, eye-appeal, growth, length, depth & great markings. He exhibits the thickness & capacity of the old, along with the femininity, udders & feet of the new! 94 lb BW, 758 lbs 205-day wt (116 indx), 1112 365-day wt (110 indx), REA 1.09/100 lbs. Dam 76S's pedigree is backed by great cattle. BW: 4 sons avg'd 88 lbs, 4 dtrs avg'd 83 lbs; WN: 4 sons avg'd 108.5 indx, 4 dtrs avg'd 113.8 indx; **Lots 6C, 28C, 63C, 69C, 77C, 109C, 122C, & 503C**



# ULRICH HEREFORD RANCH REFERENCE SIREs



SIRE N

## N AGA 60W BANNER SPORT ZEAL 28Z

C02971712 ALNK 28Z MARCH 16 2012

BW:	86
205:	717
365:	950
'17 EPDs	
CE:	+1.2
BW:	+1.9
WW:	+31.9
YW:	+58.9
MCE:	+0.6
Milk:	+19.2
TM:	+35.2

BBSF 6P SPORT 232S  
**BANNERLANE 232 EXTRA GEN 60W**  
 BANNERLANE GENSTAR LASS 27R  
 CTY EASY 705T  
**AGA 705 MISS EASYGOING 905W**  
 AGA 114L MISS STAR GENERAL 47S  
 HAWKEYE 75K SKY LAD 6P  
 BBSF 18H EXTRA LASS 237M  
 C 80G L SARGENT 78K  
 BANNERLANE STAN LASS 39M  
 AGA 10S STANDARD 137Y  
 COURTNEY LASS J921  
 AGA 13G GENERAL 114L  
 AGA 22B MISS BRIGADER 511E

Top % of Breed for: BW 25%, Stay 15% (**Trait Leader**) MPI 30%,

Which is more striking? 28Z's two hooded, goggle eyes, red neck, red testicles & red legs down to red hooves, or his eye-appeal, length, thickness & extra-wide top & sound solid feet never trimmed!? All of these traits he passes on to progeny. Check out his 86 lb BW, 109 WN index, REA 1.21/100 lbs, & LMY 66.3! Dam 905W is tremendous with nice even teats on a tight udder. Yes, 28Z has certainly added some Zeal to our herd! **Lots 7C, 73C, 103C, 114C, 137C, 501C, & 504C**



SIRE P: PICTURED AT COMING 2 YEARS OF AGE

## P AGA 72S BERT'S ANDY 39A

C02987660 ALNK 39A MARCH 25 2013

BW:	94
205:	694
365:	1218
'17 EPDs	
CE:	+0.5
BW:	+3.6
WW:	+51.2
YW:	+75.5
MCE:	+0.5
Milk:	+15.7
TM:	+41.3

96 ANDY 7L  
**96 ANDY 72S**  
 96 EVE 18N  
 AGA 79H BRIT DOM ET 70N  
**AGA 70N MISS BRIT DOM 62S**  
 AGA 44C MISS SILVER 61G  
 96 ANDY 81F  
 96 HANNA 9J  
 DUNN'S 02C LAD 14E  
 96 LADY 58E  
 FE 135D BRIT DOM 79H  
 AGA 656U MISS STANDARD ET 17H  
 SNS SILVER PRINCE 44C  
 AGA MISS CENTENNIAL 62C

This incredible son of 72S has excellent performance (#1 WN, #2 YR with the RFI group), and above avg RFI rounds out his balanced EPDs, plus above avg REA (1.09/100 lbs) & MARB scores. The dam, 62S, raised 5 males: avg 87 lbs BW, avg 120 WN indx (& avg 114.5 YR indx) & 6 hfrs: avg 80 lbs BW, avg 109.3 WN indx (& avg 107 YR indx). With great confirmation, solid feet and a great udder, she backs 39A 100%! We retained 1/2 interest & 1/2 possession when sold to Blaine Hudec, of Jenner AB. **Lots 24C, 54C, & 89C**



SIRE O: PICTURED AT COMING 2 YEARS OF AGE

## O AGA 72S BERT'S ANDY ANCHOR 19A

C02986651 ALNK 19A MARCH 21 2013

BW:	93
205:	634
365:	1117
'17 EPDs	
CE:	-1.8
BW:	+5
WW:	+47.6
YW:	+74.5
MCE:	-0.2
Milk:	+16
TM:	+39.8

96 ANDY 7L  
**96 ANDY 72S**  
 96 EVE 18N  
 AGA 26R STANMORE 5T  
**AGA 5T MISS STANMORE DOM 90W**  
 AGA 114L MISS GENERAL 62T  
 96 ANDY 81F  
 96 HANNA 9J  
 DUNN'S 02C LAD 14E  
 96 LADY 58E  
 AGA 21M STANMORE 26R  
 AGA 53L MISS RED DOMINO 122R  
 AGA 13G GENERAL 114L  
 AGA 20J MISS STANMORE 36L

96 ANDY 72S produced this great son with performance galore, plus length, plus thickness, excellent feet & legs, well-marked and correct. His excellent ultrasound of Ribeye 1.10/ 100 lbs and adj MARB of 4.11 rounds out his balanced EPDs. The cow is correct, feminine with a flat udder & well-placed teats and anchored by solid well-placed feet. She has been sold to Carzan Land & Livestock, doing well at his purebred place while 19A has moved on to White Lake Colony. **Lots 95C, 126C, 133C, & 136C**



SIRE Q

## Q WH 9A RUST TEMPEST 372A

C03014506 372 FEBRUARY 09 2013

BW:	
205:	
365:	
'17 EPDs	
CE:	-0.5
BW:	+5.8
WW:	+54.2
YW:	+92.1
MCE:	-2.7
Milk:	+19.3
TM:	+46.4

FE 32P RUSTANDARD 6T  
**XTD 6T RUST TEMPEST ET 9A**  
 JT 19P LADY 95U  
 K 6J RUSTANDARD 32P  
 FE 59J DOM STD 82P  
 ILK STD 43K LAD 19P  
 JT STANWAY LADY 60S  
 CHURCHILL DOMINO 484  
 CHURCHILL LADY 401 ET  
 CHURCHILL BLAZE 1135  
 CHURCHILL LADY 030

Top % of Breed for: YW 20%, FMI 15%, PWG 20%, REA 10%

We saw "Rusty" as a calf at Justin Wichman's (Montana), on his dam, 06, & really liked the pair! He gained really well (1 of the top YR calves at Justin's). Discovering the sire was XTD 6T RUST TEMPEST ET 9A, we were hooked! 9A was our pick of the Calgary Bull Sale, where XTC showed him as a 2-yr-old (1993). Now was our chance to have a 9A son & soon Rusty was breeding our young cows! He's deep & thick, easy-keep-in' with good feet. See 3 sons here today! **Lots 67C, 72C, & 135C**



# ULRICH HEREFORD RANCH COMING 2'S

6

## AGA 18Z CHOCOLATE ZOOM STAN 6C

C03012609 ALNK 6C MARCH 22 2015

BW:	86
205:	716
'17 EPDs	
CE:	+2.2
BW:	+3.2
WW:	+41.2
YW:	+62.1
MCE:	+0.9
Milk:	+17.3
TM:	+37.9

AGA 55C STANDARD 18Y	SILVER STANDARD 55C
<b>AGA 18Y ZOOM STANDARD 18Z</b>	MISS 46E BRITISHER AGA 22L
AGA 21M MISS STANMORE 76S	AGA 20J STANMORE 21M
	AGA 101J MISS STANDARD 140P
CTY EASY 705T	AGA 10S STANDARD 137Y
<b>AGA 705 MISS EASYGOING 129X</b>	COURTNEY LASS J921
AGA 21M MISS STANMORE 151P	AGA 20J STANMORE 21M
	AGA 97J MISS RED EXTRA 145M

Why not start with dessert? 6C is a chocolate brown delight, with a chocolate dipped mane and pigment smothered around eyes & testicles. The dam 129X's conformation is akin to most of her sisters (137Y daughters), with red coats, moderate size, and faultless feet & udders. And much like his sire, 6C has that eye-appealing frame, proud head, performance (especially 205-day) with a great top and thickness along with excellent bone, feet & sound legs. RFI EPD +108 (top 10% of the breed) 86 lb BW - a rich **Heifer bull!**

7

## AGA 28Z CARGO SPORT 7C

C03012604 ALNK 7C MARCH 22 2015

BW:	78
205:	647
'17 EPDs	
CE:	+3.8
BW:	+0.1
WW:	+35.1
YW:	+60.2
MCE:	+2.2
Milk:	+22
TM:	+39.6

BANNERLANE 232 EXTRA GEN 60W	BBSF 6P SPORT 232S
<b>AGA 60W BANNER SPORT ZEAL 28Z</b>	BANNERLANE GENSTAR LASS 27R
AGA 705 MISS EASYGOING 905W	CTY EASY 705T
	AGA 114L MISS STAR GENERAL 47S
AGA 46E BRITISHER ET 2U	DP BRITISHER AGA 46E
<b>AGA 2U MISS BRITISHER 210Z</b>	AGA 22B MISS BRIGADER 511E
AGA 656 MISS STANDARD 15M	STANDRD LAD 656 4ET
	AGA 335C MISS EXTRA 8G

7C is built like a brick, stout & broad, thick and long like his sire Sport Zeal 28Z! He inherits his curly red coat from his dam 210Z, a very deep, pretty cow with excellent feet and udder sublime. 7C was born only 78 lbs, but indexed above average at both weaning and yearling. Ultrasound gives him a Marbling index of 122! Don't miss out on this Cargo all wrapped up as **Heifer bull!** **Retaining semen interest**

10

## AGA 67X EXPRESS 10C

C03012937 ALNK 10C MARCH 24 2015

BW:	86
205:	569
'17 EPDs	
CE:	+1.1
BW:	+3.2
WW:	+34.9
YW:	+62.8
MCE:	+2.2
Milk:	+18.2
TM:	+35.7

CTY EASY 705T	AGA 10S STANDARD 137Y
<b>AGA 705 EASYGOING EXPRESS 67X</b>	COURTNEY LASS J921
AGA 21M MISS STANMORE 22T	AGA 20J STANMORE 21M
	AGA 207N MISS SILVER 9R
AGA 22B BRIGADER 53L	CTY BRIGADER 22B
<b>AGA 53L MISS RED DOMINO 116R</b>	AGA 189C MISS DOMINO 4E
AGA 10B MISS BEAR 170M	HLAH 90Z MARK DONALD 10B
	AGA 656U MISS STANDARD 135J

Express 67X sired this correct stout fella born at 86 lbs. 10C is red right to the toes (excellent feet they are, with really good heels) with a curly hair coat, and the typical pigment around the eyes and on testicles. The excellent dam, 116R, is a deep, meaty yet feminine cow, with longevity and curly thick hair that she passed on to her son. The yearling summary of 67X (sire of 10C) shows above average Yearling indexes for both male & female.

11

## AGA 72S BERT'S ANDY CAMPER 11C

C03012938 ALNK 11C MARCH 25 2015

BW:	76
205:	656
'17 EPDs	
CE:	+1.8
BW:	+1.5
WW:	+40.1
YW:	+54.7
MCE:	-1.6
Milk:	+12.7
TM:	+32.8

96 ANDY 7L	96 ANDY 81F
<b>96 ANDY 72S</b>	96 HANNA 9J
96 EVE 18N	DUNN'S 02C LAD 14E
	96 LADY 56E
AGA 53A STANDARD ET 4R	SGC 14X STANDARD LAD 53A
<b>AGA 4R MISS STANDARD 26T</b>	AGA 22B MISS BRIGADER 511E
AGA 124J MISS STANDARD 9L	AGA 656U STANDARD ET 124J
	AGA K58 MISS STANMORE 38R

Here's a complete easy-fleshing son of Andy 72S, with eye appeal! He's well-marked, and well pigmented on both eyes and testicles, with a frosty birthmark high on the hip! 26T is his moderate-sized dam, attractive, with great feet, a tucked up flat udder and well spaced little teats. Her son, 11C, has excellent feet & really good heels. A great Marbling score (4.41 Act, 4.35 Adj) anticipates the cutability & tenderness his offspring brings to the dinner plate. Let this Camper make you a happy camper this breeding season! **Heifer bull.**



# ULRICH HEREFORD RANCH COMING 2'S



22

## AGA 53L RED DOMINO CADMIUM 22C

C03013068 ALNK 22C MARCH 27 2015

BW:	98
205:	693
'17 EPDs	
CE:	-2.9
BW:	+6
WW:	+46.4
YW:	+79.8
MCE:	-0.8
Milk:	+14.9
TM:	+38.1

CTY BRIGADER 22B  
**AGA 22B BRIGADER 53L**  
AGA 189C MISS DOMINO 4E

BAR PIPE BRIGADIER 19Y  
LADY 66J B DOM 509  
AGA 28Z DOMINO 189C  
AGA 852 MISS STANMORE ET 5C

BANNERLANE 232 EXTRA GEN 60W  
**AGA 60W MISS BANNER SPORT 22Z**  
AGA 114L MISS GENERAL 57W

BBSF 6P SPORT 232S  
BANNERLANE GENSTAR LASS 27R  
AGA 13G GENERAL 114L  
AGA 102E MISS EXTRA 60K

Check out these numbers! 65.7 Lean Meat Yield, 149 FMI, +105 RFI (top 25% of the breed) along with above average PWG +33.4 (Post Weaning Gain), 1.14 REA/100 lbs (2/19), 12.60 Ribeye/sq in (check out that length of body), and good performance: 110 WN indx, and 105 YR indx. The AI sire, 53L, is still producing excellent easy-keeping offspring with great conformation, sound feet, flat udders and good haircoats like 22C - which will last and last, just like Cadmium!



24

## AGA 39A BERT ANDY'S CANNON 24C

C03013095 ALNK 24C MARCH 28 2015

BW:	98
205:	608
'17 EPDs	
CE:	+1.7
BW:	+3.4
WW:	+40
YW:	+53.7
MCE:	+0.9
Milk:	+14.1
TM:	+34.1

96 ANDY 72S  
**AGA 72S BERT'S ANDY 39A**  
AGA 70N MISS BRIT DOM 62S

96 ANDY 7L  
96 EVE 18N  
AGA 79H BRIT DOM ET 70N  
AGA 44C MISS SILVER 61G

AGA 55C STANDARD 18Y  
**AGA 18Y MISS STANDARD YULE 14Y**  
AGA 21M MISS STANMORE 19R

SILVER STANDARD 55C  
MISS 46E BRITISHER AGA 22L  
AGA 20J STANMORE 21M  
AGA 53L MISS RED DOMINO 218N

Take a shot of marbling from Cannon 24C! MARB indx of 129 is sure to produce beef that's tender! The sire, 39A, is a performance bull from an outstanding mother 62S. She's got excellent feet, flat udder, with evenly spaced cups and 4 teats no bigger than a little finger. On the maternal side, 24C's dam, 14Y, is from a great cow line with excellent conformation that has 3 generations still working on the ranch in 2017. (Grandmother 19R- 12 yrs old, and great-granddam 218N- 15 years, who last year raised a heifer calf with 700 lbs 205-day weight.)



26

## AGA 67X EXPRESS 26C

C03013168 ALNK 26C MARCH 29 2015

BW:	84
205:	584
'17 EPDs	
CE:	+3.9
BW:	+1.6
WW:	+36.5
YW:	+61
MCE:	+1.8
Milk:	+23.5
TM:	+41.8

CTY EASY 705T  
**AGA 705 EASYGOING EXPRESS 67X**  
AGA 21M MISS STANMORE 22T

AGA 10S STANDARD 137Y  
COURTNEY LASS J921  
AGA 20J STANMORE 21M  
AGA 207N MISS SILVER 9R

AGA 656 STANDARD ET 6N  
**AGA 6N MISS STANDARD 50R**  
AGA 97J MISS RED EXTRA 9N

STANDRD LAD 656 4ET  
AGA 335C MISS EXTRA 8G  
AGA 22B BRIGADER 97J  
AGA 13G MISS GENERAL 141L

Another attractive **Heifer Bull** son of 67X, 26C was born at 84 lbs. Check out those EPDs: CE, BW, Milk, & Marb +0.26 (top 10% of the breed). Dam 50R had 4 sons 80 lb BW, & 6 dtrs 85 lb BW - an excellent cow, with perfect udder, flat & cups evenly placed. We used her very first son on our own heifers before Doerksen's bought & used him for yrs. Arnold Kruger purchased 50R's sire & really admired his excellent females. He was out of a Dam of Great Distinction cow, 8G, (great all-around conformation, ideal udder great feet- just like 26C).



ALNK 129X - dam of Lot 6C



ALNK 27X - Dam of Lot 69C



# ULRICH HEREFORD RANCH COMING 2'S



## 37

### AGA 47R STANMORE BUDDY ET 37C

C03028172 ALNK 37C MARCH 30 2015

BW:	66
205:	684
'17 EPDs	
CE:	+1
BW:	+3
WW:	+41.7
YW:	+66.1
MCE:	+1.4
Milk:	+23.5
TM:	+44.4

AGA 121G STANMORE 20J  
**PDHR 20J STANMORE 47R**  
PDHR 80G GENERAL LASS 91K

AGA 79H BRIT DOM ET 70N  
**AGA 70N MISS BRIT DOM 62S**  
AGA 44C MISS SILVER 61G

AGA 4016D STANMORE 121G  
AGA 40E MISS STANMORE 80G  
C 18C GENERAL D LAD 80G  
PDHR MISS 40B DIAMOND 92E

FE 135D BRIT DOM 79H  
AGA 656U MISS STANDARD ET 17H  
SNS SILVER PRINCE 44C  
AGA MISS CENTENNIAL 62C

Born at only 66 lbs, here's a great **easy-calving** ET bull, rugged bone, deep, long & with a great quarter & top. He was sired by 47R & out of an elite cow 62S. She was deep & sound with a nice udder & teat placement with super productive dtrs & sons. (Her 5 sons avg'd 87 lbs BW, 120 WN indx & 114.5 YR indx. The 6 dtrs avg'd 80 lbs BW & 109 WN indx & 107 YR indx. 2 sons are excellent workers for Blaine Hudec of Jenner AB & Robert Simkins of Consort, AB. Don't miss the chance to get this Buddy 37C working 4 U! **Retaining semen interest.**



## 38

### AGA 47R STANMORE BUDDY ET 38C

C03028173 ALNK 38C MARCH 31 2015

BW:	91
205:	564
'17 EPDs	
CE:	+1
BW:	+3
WW:	+41.7
YW:	+66.1
MCE:	+1.4
Milk:	+23.5
TM:	+44.4

AGA 121G STANMORE 20J  
**PDHR 20J STANMORE 47R**  
PDHR 80G GENERAL LASS 91K

AGA 79H BRIT DOM ET 70N  
**AGA 70N MISS BRIT DOM 62S**  
AGA 44C MISS SILVER 61G

AGA 4016D STANMORE 121G  
AGA 40E MISS STANMORE 80G  
C 18C GENERAL D LAD 80G  
PDHR MISS 40B DIAMOND 92E

FE 135D BRIT DOM 79H  
AGA 656U MISS STANDARD ET 17H  
SNS SILVER PRINCE 44C  
AGA MISS CENTENNIAL 62C

Here's another Embryo Transplant (ET) from the Buddy Leachman bull, PDHR 20J STANMORE 47R sire (**trait leader** for both Milk (+29.9) and FMI (+151) and the elite donor dam, AGA 70N MISS BRIT DOM 62S (see production record in flushmate 37C's footnotes). 62S is a deep, thick cow, complete with soundness and an udder second to none - a classic case of production and class! This son, 38C, is another Buddy eagerly looking for work!



## 40

### AGA 203Y GREGORY PETE CASE 40C

C03012603 ALNK 40C APRIL 01 2015

BW:	93
205:	679
'17 EPDs	
CE:	+2.4
BW:	+2.2
WW:	+54.5
YW:	+90.3
MCE:	+3.3
Milk:	+26
TM:	+53.3

UPS DOMINO 3027  
**GCC PETE 203Y ET**  
LPG STANDARD 44B LASS 50H

AGA 4P RIBSTONE 81S  
**AGA 81S MISS RIBSTONE 126W**  
AGA 21M MISS STANMORE 76S

CL 1 DOMINO 9126J 1ET  
UPS MISS DIAMOND 1353  
96 STANDARD 6A 25E  
LPG COMMANDER 8080 LASS 59D

LCI 157K RIBSTONE 4P  
AGA 44K MISS OLD DOMINO 252M  
AGA 20J STANMORE 21M  
AGA 101J MISS STANDARD 140P

This is a really stout, deep, high capacity Case - a brick of a bull, with good feet, good heel, lots of performance and a great disposition! Don't overlook good balanced EPDs and above average RFI & PWG! He's a typical Pete son out of the 126W cow - a beautiful, voluminous mother with a top notch udder. This incredible dam avg'd 89 lbs BW, 106.3 WN index, 104.5 YR index for 3 sons, and 81 lbs BW, 112.3 WN index, 118 YR index for 2 daughters! Her mother (40C's granddam) is the dam of our herd sire Zoom 18Z - a great pedigree, a complete Case!



## 41

### AGA 105T CAT STAN GENERAL 41C

C03012599 ALNK 41C APRIL 01 2015

BW:	113
205:	714
'17 EPDs	
CE:	-4.8
BW:	+9.1
WW:	+55
YW:	+93.4
MCE:	-1.1
Milk:	+15.9
TM:	+43.4

AGA 13G GENERAL 114L  
**AGA 114L GENERAL 105T**  
AGA 4K MISS STANMORE 221N

CTY BRIGADIER 22B  
**AGA 22B MISS RED DOMINO 22R**  
AGA 10K MISS STANDARD 230M

GEM GENERAL 13G  
AGA 656U MISS STANDARD ET 17H  
AGA 4016D STANMORE 4K  
AGA 44C MISS SILVER 85G

BAR PIPE BRIGADIER 19Y  
LADY 66J B DOM 509  
AGA 34Z STANDARD ET 10K  
AGA 277D MISS STANDARD 830H

Don't let this Cat sneak away on you! He's really correct, long and quiet with tremendous maternal strength and performance. His weaning index was 116 and yearling index 109, and it's no wonder - his mom, 22R, was a super productive cow in our herd. Her 7 sons averaged 113 indx at WN, (6 sons 113.3 index at Yr) and her 2 daughters averaged 104.5 index at weaning and 106.5 at yearling. She was a beautiful elderly cow indeed with an immaculate udder to her final days.



# ULRICH HEREFORD RANCH COMING 2'S



46

## AGA 72S BERT'S ANDY 46C

C03013347 ALNK 46C APRIL 02 2015

BW:	103
205:	617
'17 EPDs	
CE:	-1.5
BW:	+5.4
WW:	+50.5
YW:	+73.9
MCE:	-2.1
Milk:	+16.3
TM:	+41.6

96 ANDY 7L  
**96 ANDY 72S**  
96 EVE 18N

CC 129D SUPERMAN 77J  
**AGA 77J MISS SUPERMAN 25U**  
AGA 335C MISS EXTRA 8G

96 ANDY 81F  
96 HANNA 9J  
DUNN'S 02C LAD 14E  
96 LADY 56E

FE 07Y SUPER 129D  
CC 42W JULIANA 66Z  
CTY EXTRA 335C  
AGA 67Z MISS CENTENNIAL 81D

The ultrasound wand revealed strong rib-eye (111 index), 1.18 REA/100 lbs, 113 Marbling index plus Lean Meat Yield (LMY) 65.5. All this meat was smothered by extra length, a wide top and thickness carried on excellent feet with a good heel! 25U is the proud dam, an impeccable cow with lots of volume, eye-appeal, a level udder with well-placed teats, and descended from a great cow family! (Her dam, 8G, is a Dam of Great Distinction!) 46C is ready to pass along his high yielding 72S genetics to serve many, many plates.



47

## AGA 48Y SUPER COACH 47C

C03012598 ALNK 47C APRIL 03 2015

BW:	97
205:	717
'17 EPDs	
CE:	-1.9
BW:	+5.3
WW:	+55.2
YW:	+91.8
MCE:	+0.4
Milk:	+18.1
TM:	+45.7

CC 129D SUPERMAN 77J  
**AGA 77J SUPERMAN 48Y**  
AGA 21M MISS STANMORE 88S

AGA 13G GENERAL 114L  
**AGA 114L MISS GENERAL 94T**  
AGA 53A MISS STANDARD ET 152M

FE 07Y SUPER 129D  
CC 42W JULIANA 66Z  
AGA 20J STANMORE 21M  
AGA 656U MISS STANDARD ET 75P

GEM GENERAL 13G  
AGA 656U MISS STANDARD ET 17H  
SGC 14X STANDARD LAD 53A  
AGA 22B MISS BRIGADER 511E

Be prepared to strike many bases with Super Coach 47C! Performance outstanding (2nd in both WN & YR), ultrasound too (124 REA index, 1.08 REA/100 lbs, 118 Marb index, #1 in RibFat (158 index), EPDs of course (+104 RFI, +36.6 PWG) & bright phenotype: yellow curly haircoat, well-marked, eye-appealing individual that stands correct & proud, deep with quarters extra-wide! Dam 94T raised 3 sons avg 94 lb BW, 109 WN & 107.7 YR indxs; 5 dtr avg 84 lb BW, 102.4 WN, (3 dtr) 105 YR indxs. Hit it out of the park with 47C! **Retaining semen interest.**



54

## AGA 39A BERT ANDY'S 54C

C03013363 ALNK 54C APRIL 04 2015

BW:	90
205:	569
'17 EPDs	
CE:	+1.1
BW:	+3.5
WW:	+40.9
YW:	+59.3
MCE:	+1.3
Milk:	+14
TM:	+34.5

96 ANDY 72S  
**AGA 72S BERT'S ANDY 39A**  
AGA 70N MISS BRIT DOM 62S

AGA 55C STANDARD 18Y  
**AGA 18Y MISS STANDARD 30Z**  
AGA 21M MISS STANMORE 19R

96 ANDY 7L  
96 EVE 18N  
AGA 79H BRIT DOM ET 70N  
AGA 44C MISS SILVER 61G

SILVER STANDARD 55C  
MISS 46E BRITISHER AGA 22L  
AGA 20J STANMORE 21M  
AGA 53L MISS RED DOMINO 218N

39A sired this correct, stout, well-balanced son, 54C! The ultrasound scan revealed a great 1.25 REA/100 lbs along with a really nice 64.3 Lean Meat Yield! (avg is 60 or so). Not only is 54C deep-bodied with a great disposition, but he also comes from a great cow family! The dam 30Z is a very pretty, moderate-sized cow with lots of volume & thickness & excellent tight udder with teats spaced just right. Her 2 sons avg'd 85 lbs BW and a dtr 71 lbs. The great-granddam (218N) is still here & produced an outstanding heifer this yr (49D's 205-day wt 700 lbs).



55

## AGA 1Y KING 55C

C03013364 ALNK 55C APRIL 05 2015

BW:	86
205:	607
'17 EPDs	
CE:	+2.6
BW:	+2.6
WW:	+37.1
YW:	+56.8
MCE:	+1.1
Milk:	+19.5
TM:	+38.1

SFL 565R KING LAD 80U  
**SFL 80U KING LAD 1Y**  
SFL 1T MISS STANDARD TANK 61W

JEN 56M SILVER 37T  
**SFL 37T PRIDE LADY 10Y**  
SFL 38E MISS SILVER PRIDE 50K

CFH 155N RB KING 565R  
SFL 86M MISS ROBIN 96R  
NGC 121P TANK 1T  
SFL 38R STANDARD PRINCESS 22T

LBH 20J STANMORE 56M  
JEN 124J SILVER LADY 10N  
MARG 50B SILVER PRIDE 38E  
SFL MISS REGULATOR 96D

The dam of 55C was purchased bred from Murray Stauffer's dispersal sale back in 2014. We really liked the line of cattle Murray had from his Silver Pride 38E bull. He had some really good cows from him, and this was our chance to obtain a 38E granddaughter. The result was 55C, lots of muscle, great top, and nice birthweight (86 lbs). In fact, he developed a thick top during his short time nursing, and has kept it to this day. Don't overlook this really red boy, with red hooded eyes and red testicles!



# ULRICH HEREFORD RANCH COMING 2'S



56

## AGA 203Y GREGORY PETE CHEF 56C

C03013365 ALNK 56C APRIL 05 2015

BW:	80
205:	667
'17 EPDs	
CE:	+5.6
BW:	-0.6
WW:	+38.4
YW:	+67.3
MCE:	+3.1
Milk:	+26
TM:	+45.2

UPS DOMINO 3027	CL 1 DOMINO 9126J 1ET
<b>GCC PETE 203Y ET</b>	UPS MISS DIAMOND 1353
LPG STANDARD 44B LASS 50H	96 STANDARD 6A 25E
	LPG COMMANDER 8080 LASS 59D
AGA 46E BRITISHER ET 2U	DP BRITISHER AGA 46E
<b>AGA 2U MISS BRITISHER 17A</b>	AGA 22B MISS BRIGADER 511E
AGA 72R MISS LADDIE 86U	KGA 33H LAD 72R
	AGA 70N MISS BRIT DOM 62S

Stout & deep, with lots of rib, Chef 56C starts with 80 lb BW & stirs in a reasonable WN & YR. A **fine choice for heifers** (-5.6 CE, -0.6 BW & +3.1 MCE (top 20% of the breed) he'd serve milk too! 140.8 MPI, 130.7 FMI, & +13 MARB are extra top-pings. Sire 203Y's avg BW record (78 lbs (F) & 81 lbs (M)) gives dam, 17A a great start (2 sons avg'd 108 WN indx). Her sire 2U, is a son of 46E, still a CE, BW, Stay, & MPI **Trait Leader** today. EPDs are finally catching up. Born 1973, 46E sired lots of milk, volume, substance, doing ability, nice udders & BWs long ago!



58

## AGA 203Y GREGORY PETE CHUB 58C

C03012605 ALNK 58C APRIL 05 2015

BW:	88
205:	674
'17 EPDs	
CE:	+2.1
BW:	+1.9
WW:	+42.8
YW:	+68.8
MCE:	+2.7
Milk:	+30.3
TM:	+51.7

UPS DOMINO 3027	CL 1 DOMINO 9126J 1ET
<b>GCC PETE 203Y ET</b>	UPS MISS DIAMOND 1353
LPG STANDARD 44B LASS 50H	96 STANDARD 6A 25E
	LPG COMMANDER 8080 LASS 59D
BANNERLANE 232 EXTRA GEN 60W	BBSF 6P SPORT 232S
<b>AGA 60W MISS BANNER SPORT 118A</b>	BANNERLANE GENSTAR LASS 27R
AGA 70S MISS EASYGOING 905W	CTY EASY 705T
	AGA 114L MISS STAR GENERAL 47S

Chub was sired by Pete, who produces these consistent, thick, good tops, medium-sized easy-calving bulls. This very sound 58C has lots of performance, 2 goggle eyes, good red testicles, 1.08 REA/100 lbs & is **recommended for heifers** (88 lbs act BW, +2.1 CE, +1.9 BW & +2.7 MCE EPDs). Dam 118A's 1st 2 sons BW avg'd 83 lbs & 104.5 WN indx. She's really red (so 58C has even more pigment than Pete!) & her nice tight udder mimics the numerous maternal cows before her with nice udders & rich milk. Chub should sire excellent mamas & papas!



63

## AGA 18Z CAPTAIN ZOOM STAN 63C

C03013639 ALNK 63C APRIL 07 2015

BW:	104
205:	716
'17 EPDs	
CE:	-3.1
BW:	+8
WW:	+51
YW:	+91.9
MCE:	+0.4
Milk:	+17
TM:	+42.5

AGA 55C STANDARD 18Y	SILVER STANDARD 55C
<b>AGA 18Y ZOOM STANDARD 18Z</b>	MISS 46E BRITISHER AGA 22L
AGA 21M MISS STANMORE 76S	AGA 20J STANMORE 21M
	AGA 101J MISS STANDARD 140P
AGA 13G GENERAL 114L	GEM GENERAL 13G
<b>AGA 114L MISS GENERAL 104W</b>	AGA 656U MISS STANDARD ET 17H
AGA 41F MISS HI STANDARD 90P	BANNERLANE HI STANDARD 41F
	AGA 22B MISS BRIGADER 23L

"Just call me Captain!" Here's a deep performance bull with a nice head, red hooded eyes, good bone, & extra length (LMY 65.1). 63C's dam, 104W, is a nice medium-sized cow with a beautiful back & a great flat udder with small correctly placed teats. Her 3 18Z sons (full sibs) avg'd 110 WN index, proving this combo (18Z x 104W) works really well. 63C ate little more than avg (RFI +99) but gained tremendously (+40.9 PWG & 142 FMI)! Commanding gain, while demanding efficiency is a noble goal for any cattleman. Yes, sir, Captain!



64

## AGA 72S BERT'S ANDY COMBAT 64C

C03013640 ALNK 64C APRIL 07 2015

BW:	98
205:	568
'17 EPDs	
CE:	-0.8
BW:	+4.1
WW:	+44.9
YW:	+61.3
MCE:	-0.4
Milk:	+16.7
TM:	+39.2

96 ANDY 7L	96 ANDY 81F
<b>96 ANDY 72S</b>	96 HANNA 9J
96 EVE 18N	DUNN'S 02C LAD 14E
	96 LADY 56E
AGA 46E BRITISHER 32T	DP BRITISHER AGA 46E
<b>AGA 32T MISS BRITISHER 108W</b>	AGA 6N MISS STANDARD 50R
AGA 21M MISS STANMORE 126T	AGA 20J STANMORE 21M
	AGA 656U MISS STANDARD 135J

Combat mediocrity! Here's a thick, really sound fellow who's ready to work! He stands wide with a wide top over a stout frame and is covered by a mossy hair coat! Under that, the ultrasound technician uncovered a 1.25 REA/100 lbs and a Lean Meat Yield (LMY) of 65.8. 64C also possesses strong maternal traits. His moderate-sized dam, 108W, is thick with a great udder. She's had two sons move on to Herd Sire status: One for Terri Pierson of Wardlow, AB and another for BenWyn Farms of Peace River country. Let 64C get his boots on for you!



# ULRICH HEREFORD RANCH COMING 2'S



67

## AGA 372A RUSTY 67C

C03016517 ALNK 67C APRIL 08 2015

BW:	89
205:	511
'17 EPDs	
CE:	-0.2
BW:	+4.7
WW:	+41
YW:	+69.3
MCE:	-1.2
Milk:	+12.7
TM:	+33.2

XTD 6T RUST TEMPEST ET 9A  
**WH 9A RUST TEMPEST 372A**  
WICHMAN LADY 06

AGA 79H BRIT DOM ET 70N  
**AGA 70N MISS BRIT DOM 13U**  
AGA 22B MISS BRIGADER 23L

FE 32P RUSTANDARD 6T  
JT 19P LADY 95U  
CHURCHILL DOMINO 6101S  
CHURCHILL LADY 04107  
FE 135D BRIT DOM 79H  
AGA 656U MISS STANDARD ET 17H  
CTY BRIGADER 22B  
AGA 191G MISS STANDARD 49J

Here's a son of 372A, a bull we purchased from Justin Wichman, of Montana, as a yearling in 2014. 67C has good curly hair, a long red body, sound and correct. Ultrasound scanned a 1.20 REA/100 lbs and a 65.8 LMY, so the genetics are there to produce excellent yielding calves. The dam, 13U, had 6 bull calves averaging 82 lbs at birth. She was a daughter of 70N, who sold to Errol Verbeek of Evansburg, AB, where he has done a fine job. Errol even sold herdsires from 70N - a strong grandsire in Rusty's pedigree.



69

## AGA 18Z ZOOM STAN CHOICE 69C

C03016518 ALNK 69C APRIL 08 2015

BW:	94
205:	561
'17 EPDs	
CE:	-0.6
BW:	+5.6
WW:	+40.3
YW:	+71.4
MCE:	+1.2
Milk:	+18.2
TM:	+38.4

AGA 55C STANDARD 18Y  
**AGA 18Y ZOOM STANDARD 18Z**  
AGA 21M MISS STANMORE 76S

AGA 13G GENERAL 114L  
**AGA 114L GEN'S X'S AND O'S 27X**  
AGA 97J MISS RED EXTRA 258P

SILVER STANDARD 55C  
MISS 46E BRITISHER AGA 22L  
AGA 20J STANMORE 21M  
AGA 101J MISS STANDARD 140P  
GEM GENERAL 13G  
AGA 656U MISS STANDARD ET 17H  
AGA 22B BRIGADER 97J  
AGA 141J MISS STANDARD 191M

Looking for red? Let 69C make the Choice easy for you! This deep 18Z son sports goggle eyes, a red neck, red testicles, & a red woolly coat all around! His great structure scores LMY 65+, & above avg RFI & above avg PWG! Your Choice is out of a wonderful, well-constructed mother, attractive (like mother, like son) with one goggle eye. She's a good cow, very feminine & deep, with a top-notch pedigree & good udder. The granddam, 258P, at 13 yrs old is still producing great & is one of the first through the gate to a new field! **Retaining semen interest**



70

## AGA 67X CYBER EXPRESS 70C

C03013691 ALNK 70C APRIL 08 2015

BW:	82
205:	667
'17 EPDs	
CE:	+0.5
BW:	+4.4
WW:	+44.8
YW:	+71.9
MCE:	+0.4
Milk:	+23
TM:	+45.4

CTY EASY 705T  
**AGA 705 EASYGOING EXPRESS 67X**  
AGA 21M MISS STANMORE 22T

AGA 4P RIBSTONE 34T  
**AGA 34T MISS RIBSTONE KIN 08X**  
AGA 41F MISS HI STANDARD 53S

AGA 10S STANDARD 137Y  
COURTNEY LASS J921  
AGA 20J STANMORE 21M  
AGA 207N MISS SILVER 9R  
LCI 157K RIBSTONE 4P  
AGA 101J MISS STANDARD 140P  
BANNERLANE HI STANDARD 41F  
AGA 335C MISS EXTRA 8G

Here comes the Cyber Express! 70C is an attractive, sound, stout bull, with an 82 lb BW, lots of performance, a +107 RFI, short-marked with red testicles & a great red haircoat! He scored 119 Marb indx (his sire 67X was very high on all ultrasound traits) & imitates 67X's style & way of travelling & knows it - head up to sniff the air! Both sons & dtrs of 67X excelled in performance, & the dam 08X did well too (2 sons WN avg 109, YR avg 104.5; 1 dtr 117 WN & 112 YR indexes) - a strong maternal cow, long-bodied & mossy coated. **Retaining semen interest.**



72

## AGA 372A RUSTY COOPER 72C

C03016520 ALNK 72C APRIL 10 2015

BW:	102
205:	704
'17 EPDs	
CE:	-1.5
BW:	+5.7
WW:	+49.4
YW:	+83.4
MCE:	-1.7
Milk:	+20.9
TM:	+45.6

XTD 6T RUST TEMPEST ET 9A  
**WH 9A RUST TEMPEST 372A**  
WICHMAN LADY 06

CTY EASY 705T  
**AGA 705 MISS EASYGOING 905W**  
AGA 114L MISS STAR GENERAL 47S

FE 32P RUSTANDARD 6T  
JT 19P LADY 95U  
CHURCHILL DOMINO 6101S  
CHURCHILL LADY 04107

AGA 10S STANDARD 137Y  
COURTNEY LASS J921  
AGA 13G GENERAL 114L  
AGA 22B MISS BRIGADER 511E

Cooper is a great son of Rusty with an excellent WN weight, stout frame, red testicles, good hair coat & great disposition! His great top & phenotype are typical of what Rusty leaves us. Rusty goes back to a 9A son that Templeton's sold in Calgary. We have been impressed with the offspring of that 9A bull. 72C also has tremendous maternal strength! The dam, 905W, has lots of red & weaned 2 sons with 110.5 avg index and 2 heifers with 103 index. Check out Cooper's 148.6 FMI, +.45 REA EPD & 65.6 LMY! Get more meat from the same weight!



# ULRICH HEREFORD RANCH COMING 2'S



73

## AGA 28Z CO-PILOT SPORT 73C

C03012597 ALNK 73C APRIL 10 2015

BW:	105
205:	704
'17 EPDs	
CE:	-2
BW:	+6.2
WW:	+49
YW:	+82.7
MCE:	-0.9
Milk:	+22.3
TM:	+46.8

BANNERLANE 232 EXTRA GEN 60W  
**AGA 60W BANNER SPORT ZEAL 28Z**  
 AGA 705 MISS EASYGOING 905W  
 BBSF 6P SPORT 232S  
 BANNERLANE GENSTAR LASS 27R  
 CTY EASY 705T  
 AGA 114L MISS STAR GENERAL 47S

AGA 4P RIBSTONE 81S  
**AGA 81S MISS RIBSTONE 120W**  
 AGA 41F MISS HI STANDARD 61S  
 LCI 157K RIBSTONE 4P  
 AGA 44K MISS OLD DOMINO 252M  
 BANNERLANE HI STANDARD 41F  
 AGA 22B MISS BRIGADER ET 11L

Built like a brick, this Co-Pilot will have a job to get liftoff! Really stout, this high capacity 28Z son has great structure, a yellow to med red mossy coat, 1 goggle eye, is rock sound & tame to boot! #1 YW from Cattleland crew, RFI (+99) declares all that bulk took just avg feed to get above avg PWG (33.7). See EPDs: FMI 130.8, MARB +0.13. See 28Z notes for stats. Dam 120W is a shapely, moderate-sized, great-coated, feminine, performance cow (4 sons avg'd 111.5 WN indx; 2 dtrs avg'd 103 WN indx). **Retaining semen interest**



77

## AGA 18Z ZOOM STAN CREDITOR 77C

C03012611 ALNK 77C APRIL 10 2015

BW:	92
205:	713
'17 EPDs	
CE:	+0
BW:	+4.1
WW:	+45
YW:	+65.4
MCE:	+2.4
Milk:	+22.1
TM:	+44.6

AGA 55C STANDARD 18Y  
**AGA 18Y ZOOM STANDARD 18Z**  
 AGA 21M MISS STANMORE 76S  
 SILVER STANDARD 55C  
 MISS 46E BRITISHER AGA 22L  
 AGA 20J STANMORE 21M  
 AGA 101J MISS STANDARD 140P

AGA 114L GENERAL WILEY 24W  
**AGA 24W MISS GEN WILEY 144Y**  
 AGA 70N MISS BRIT DOM 33U  
 AGA 13G GENERAL 114L  
 AGA 118L MISS STANDARD 2R  
 AGA 79H BRIT DOM ET 70N  
 AGA 97G MISS HOT SHOT 82J

We're really happy with this fancy sale bunch of 18Z offspring - Grow - they do! (7 sons avg WN indx 108; 6 avg YR indx 104) 77C holds his head high atop deep length, with pigmented eyes, red neck, red well-shaped testicles & lots of performance. We even used him on some young cows here. Dam, 144Y, is a good all-around med-sized cow with the udder we like - a typical dtr of 24W, she's producing really well! (avg WN indx 113 (M), 114(F)) Her '16 dtr topped 70 heifers in WN last yr. Surely, Creditor 77C will be doling out the dough! **Feature bull!**



80

## AGA 131Y HERMAN LAD CENSOR 80C

C03013750 ALNK 80C APRIL 11 2015

BW:	101
205:	678
'17 EPDs	
CE:	-0.6
BW:	+5.5
WW:	+45.4
YW:	+63.9
MCE:	+2.7
Milk:	+31.2
TM:	+53.9

LPG HERMAN LORD LAD 2W  
**CFH 2W HL LAD 131Y**  
 CFH 157K MISS HI TECH 309N  
 MHH 011H BRIT LAD 46R  
 LPG LANDLORD G44B LASS 50S  
 K 64H RIBSTONE LAD 157K  
 CFH 33B MISS HIGH TECH 114L

AGA 20J STANMORE 21M  
**AGA 21M MISS STANMORE 120S**  
 AGA 82K MISS KAPTAIN ET 50P  
 AGA 121G STANMORE 20J  
 AGA 5C MISS ENERLAD 68K  
 C 82F MICKS KAPTAIN 82K  
 AGA 85A MISS BRITISHER 74J

80C is a curly yellow bull with red testicles who indexed well at weaning. He's deep & sound like his sire, 131Y. Tho 80C was not RFI tested, 131Y has good RFI, PWG & MARB EPDs. The dam 120S has done an outstanding job of producing (4 sons avg'd 108.8 WN index; 5 dtrs avg'd WN 113.2). Her sire, 21M, sires just what we're after: low BWs with lots of growth & gain, beautiful nice udders full of rich milk to add lbs to youngsters. Note: He's **Trait Leader** (for BW, Milk, TM, Stay, MPI) and has good MARB. Censor 80C is ready to examine your herd!



86

## AGA 203Y GREGORY PETE 86C

C03013754 ALNK 86C APRIL 13 2015

BW:	78
205:	633
'17 EPDs	
CE:	+4.2
BW:	+1
WW:	+43.8
YW:	+74.8
MCE:	+3.8
Milk:	+24.7
TM:	+46.6

UPS DOMINO 3027  
**GCC PETE 203Y ET**  
 LPG STANDARD 44B LASS 50H  
 CL 1 DOMINO 9126J 1ET  
 UPS MISS DIAMOND 1353  
 96 STANDARD 6A 25E  
 LPG COMMANDER 8080 LASS 59D

BANNERLANE 232 EXTRA GEN 60W  
**AGA 60W MISS BANNER SPORT 2A**  
 AGA 114L MISS GENERAL 141X  
 BBSF 6P SPORT 232S  
 BANNERLANE GENSTAR LASS 27R  
 AGA 13G GENERAL 114L  
 AGA 53L MISS RED DOMINO 116R

Here's a really red, light birthweight **heifer bull**, who kept up through both WN & YR! 86C's a quiet, eye-appealing fella, deep & stout, with a big red eye patch & 80% pigment on the other, red testicles, a great top & good quarters! Credentials: MPI 155.6, FMI 135.9, BW 1.0, CE 4.2, MCE 3.8, and above avg in RFI & PWG, good MARB, 65.4 LMY & our top REA score 1.28/100 lbs. That's lots 'o meat! Mama 2A is a good young cow, thick, uniform, with good hair & good maternal strength. Papa Pete is a **Trait Leader** for BW (-2.7), Stay (+2.0) & MPI (183.3).



# ULRICH HEREFORD RANCH COMING 2'S



87

## AGA 203Y GREGORY PETE 87C

C03013837 ALNK 87C APRIL 14 2015

BW:	80
205:	641
<b>'17 EPDs</b>	
CE:	+4
BW:	+0.1
WW:	+38
YW:	+67.7
MCE:	+3.3
Milk:	+28.2
TM:	+47.2

UPS DOMINO 3027	CL 1 DOMINO 9126J 1ET
<b>GCC PETE 203Y ET</b>	UPS MISS DIAMOND 1353
LPG STANDARD 44B LASS 50H	96 STANDARD 6A 25E
	LPG COMMANDER 8080 LASS 59D
BANNERLANE 232 EXTRA GEN 60W	BBSF 6P SPORT 232S
<b>AGA 60W MISS BANNER SPORT 91A</b>	BANNERLANE GENSTAR LASS 27R
AGA 41F MISS HI STANDARD 87R	BANNERLANE HI STANDARD 41F
	AGA 44K MISS OLD DOMINO 252M

You can't help but like this fella - deep & red, stout, with goggle eyes, a red neck, red testicles, lots of pants & lots of meat under a wide top! While sound & correct, 87C is calm, eye-appealing with a small head, & only 80 lbs BW- a **heifer bull**. Stats: above avg RFI EPDs, MPI 157.7, FMI 130.6, Stay 1.8, BW +1 (top 5 % of the breed), CE 4.0, MCE 3.3, REA 1.11/100 lbs. He performed well on WN & YR too - a great example of Pete's work! The excellent dam has a super maternal background, a history of thick plentiful hair, nice level udders & sound feet!



89

## AGA 39A BERT ANDY'S CHIEF 89C

C03016554 ALNK 89C APRIL 14 2015

BW:	88
205:	667
<b>'17 EPDs</b>	
CE:	+0.9
BW:	+2.6
WW:	+42.6
YW:	+62.4
MCE:	+1.5
Milk:	+21.6
TM:	+42.9

96 ANDY 72S	96 ANDY 7L
<b>AGA 72S BERT'S ANDY 39A</b>	96 EVE 18N
AGA 70N MISS BRIT DOM 62S	AGA 79H BRIT DOM ET 70N
	AGA 44C MISS SILVER 61G
AGA 20J STANMORE 21M	AGA 121G STANMORE 20J
<b>AGA 21M MISS STANMORE 123S</b>	AGA 5C MISS ENERLAD 68K
AGA 97J MISS RED EXTRA 258P	AGA 22B BRIGADER 97J
	AGA 141J MISS STANDARD 191M

Chief 89C is another son of 39A - a bull Blaine Hudec bought as a herd sire. He comes from a great, great cow family & 39A also stamps great marbling (progeny avg'd 117 MARB indx)! 89C himself marbled #2 (123 indx) during ultrasound (MARB EPD +22) - sure to sire lots of tender beef for kitchens everywhere! His WN performance is no doubt the 21M factor - dam 123S is an elite 21M daughter with a great pedigree, great cattle standing behind her, & conformation correct in every way. Note: 21M is still a **Trait Leader** today for BW, Milk, TM, Stay, & MPI!



95

## AGA 19A ANDY ANCHOR 95C

C03016553 ALNK 95C APRIL 17 2015

BW:	91
205:	666
<b>'17 EPDs</b>	
CE:	-0.3
BW:	+3.5
WW:	+46.8
YW:	+67.6
MCE:	+0.4
Milk:	+15.6
TM:	+39

96 ANDY 72S	96 ANDY 7L
<b>AGA 72S BERT'S ANDY ANCHOR 19A</b>	96 EVE 18N
AGA 5T MISS STANMORE DOM 90W	AGA 26R STANMORE 5T
	AGA 114L MISS GENERAL 62T
CC 129D SUPERMAN 77J	FE 07Y SUPER 129D
<b>AGA 77J MISS SUPERMAN 17W</b>	CC 42W JULIANA 66Z
AGA 22B MISS BRIGADER ET 11L	CTY BRIGADER 22B
	AGA MISS 80S VOLTAGE ET 14X

95C was sired by 19A, a bull that went to White Lake Colony, but who we liked enough to keep an interest! It proved worthwhile in this very deep, thick son with good performance! 95C is a long, correct individual with lots of meat and lots of depth, hooded eyes, a small goggle eye and 70% pigment on the other eye. The dam, 17W, comes from a great maternal background and goes back to Superman 77J who has left lots of deep, thick, roomy cattle around the country.



100

## AGA 203Y GREGORY PETE 100C

C03029401 ALNK 100C APRIL 18 2015

BW:	70
205:	544
<b>'17 EPDs</b>	
CE:	+6.8
BW:	-2
WW:	+23.7
YW:	+41.1
MCE:	+3.2
Milk:	+21.1
TM:	+33

UPS DOMINO 3027	CL 1 DOMINO 9126J 1ET
<b>GCC PETE 203Y ET</b>	UPS MISS DIAMOND 1353
LPG STANDARD 44B LASS 50H	96 STANDARD 6A 25E
	LPG COMMANDER 8080 LASS 59D
MR MO LE 47F	DOUBLE MO LE 12B
<b>AGA 47F MISS DOMINO 80A</b>	D STANDARD LASS 88B
AGA 4R MISS STANDARD 10Y	AGA 53A STANDARD ET 4R
	AGA 114L MISS GENERAL 69S

Looking for a **heifer bull**? Check out this 203Y son, born only 70 lbs BW! (EPDs back him up: CE +6.8 (top 2%) & BW -2.0 (top 1% of the breed)). He's all decked out in red - red neck, red testicles & red right down to the toes. The maternal pedigree further reduced the BW (70 lbs is below even Pete's avg BW!). The moderate, well-marked dam, 80A, is a MR MO LE 47F daughter. He was really a heifer bull in his time - throwing good, well-marked, sound progeny who grew & cows who stayed in the herd for years & years with good hair & good udders.



# ULRICH HEREFORD RANCH COMING 2'S

## 103

### AGA 28Z SPORT CALIBER 103C

C03013999 ALNK 103C APRIL 20 2015

BW:	80
205:	638
'17 EPDs	
CE:	-0.1
BW:	+3.4
WW:	+35.9
YW:	+60
MCE:	-0.5
Milk:	+17.8
TM:	+35.8

BANNERLANE 232 EXTRA GEN 60W  
**AGA 60W BANNER SPORT ZEAL 28Z**  
 AGA 705 MISS EASYGOING 905W

BBSF 6P SPORT 232S  
 BANNERLANE GENSTAR LASS 27R  
 CTY EASY 705T  
 AGA 114L MISS STAR GENERAL 47S

AGA 55C STANDARD 18Y  
**AGA 18Y MISS AIDA STANDARD 42A**  
 AGA 6N MISS STANDARD 50R

SILVER STANDARD 55C  
 MISS 46E BRITISHER AGA 22L  
 AGA 656 STANDARD ET 6N  
 AGA 97J MISS RED EXTRA 9N

We should have called this one Copycat! Like father - like son: Both have two goggle eyes, lots of red, lots of depth and volume, good performance and excellent feet! And like 28Z, who we used on heifers with good results, we recommend 103C as a **heifer bull**! Born with a wonderful BW of 80 lbs, he still performed well and sports a MARB EPD of +0.17 to boot. The mother, 42A, is a beautiful cow from a beautiful cow family: nice, long, thick, great conformation, outstanding feet and level bags. Don't bypass this Caliber o' bull!

## 104

### AGA 87W HAMMER CATCH 104C

C03014000 ALNK 104C APRIL 20 2015

BW:	88
205:	582
'17 EPDs	
CE:	+1
BW:	+1.7
WW:	+19.6
YW:	+30.8
MCE:	+0.4
Milk:	+18.2
TM:	+28

LFF 5L JACK HAMMER 26R  
**AGA 26R WHAM HAMMER 87W**  
 AGA 44K MISS OLD DOMINO 252M

DIAMOND-T 25J LAD 5L  
 LFF 3B HI LITE EXTRA LASS 11E  
 AGA 1S OLD DOMINO 44K  
 AGA 102E MISS EXTRA 190K

CARLRAMS 48H HUGO 129S  
**CFH 129S LASS 153Y**  
 CFH 82N LASS 662S

CARLRAMS HUGO 48H  
 CARLRAMS LADY DOMINO 33L  
 MN 532 PRINCE DOMINO 82N  
 AGA 67Z MISS CENTENNIAL 504E

Hammer Catch is a sound and quiet son of Wham Hammer 87W (a birth weight **Trait Leader** with +1.7 EPD). The dam, 153Y, purchased from Conway Herefords, is a moderate-sized cow with good hair, a tight level udder & 4 uniform cups modeling nice teats. Her 3 sons averaged 80 lbs BW and 1 daughter 81 lbs BW. With this paternal and maternal influence and his own moderate birthweight of 88 lbs, this Catch is recommended as a **heifer bull**!

## 107

### AGA 15H BRIT CHAUFF ET 107C

C03029061 ALNK 107C APRIL 22 2015

BW:	80
205:	605
'17 EPDs	
CE:	+1.3
BW:	+2.7
WW:	+31.3
YW:	+58.6
MCE:	+0.3
Milk:	+12.7
TM:	+28.4

DP BRITISHER AGA 46E  
**46E BRITISHER AGA 15H**  
 MISS DP AGA 121E

DOMINO STANDARD DP LAD 45  
 BRITISHER WETMORE LADY AGA 5A  
 DOMINO STANDARD DP LAD 45  
 LADY BRITISHER AGA 29U

STANDRD LAD 656 4ET  
**AGA 656U MISS STANDARD ET 17H**  
 AGA MISS 80S VOLTAGE ET 14X

HI STANDARD LAD 20P  
 BELL L 60H DOMINO LASS 82K  
 LCI ET HIGH VOLTAGE 80S  
 MISS 51K BRITISHER AGA 61N

Here's a limo affectionately known as Chauff!: Depth, great length, great quarters & pants, moderate size, red testicles, solid bone, wide top, curly hair, short-marked, **heifer bull**, high volume, attractive ET son of great old Britisher 15H (**Trait Leader** in BW -2.2, Stay +2.1, & MPI +135.7), son of 46E (**Trait Ldr** of CE +8.1, BW -1.9, Stay +3.8, & MPI 169.4) Legendary dam 17H created many herdsires & excellent cows, backed by generations of our best milking, very sound, & excellent performing cattle, sought after by many! **Retaining semen interest.**

## 109

### AGA 18Z ZOOM STAN CABINET 109C

C03012610 ALNK 109C APRIL 23 2015

BW:	107
205:	675
'17 EPDs	
CE:	-2.1
BW:	+7.1
WW:	+52.8
YW:	+88.1
MCE:	-0.2
Milk:	+18.4
TM:	+44.8

AGA 55C STANDARD 18Y  
**AGA 18Y ZOOM STANDARD 18Z**  
 AGA 21M MISS STANMORE 76S

SILVER STANDARD 55C  
 MISS 46E BRITISHER AGA 22L  
 AGA 20J STANMORE 21M  
 AGA 101J MISS STANDARD 140P

CTY EASY 705T  
**AGA 705 MISS EASYGOING 18X**  
 AGA 65R MISS BRIT DOM 23T

AGA 10S STANDARD 137Y  
 COURTNEY LASS J921  
 AGA 70N BRIT DOM 65R  
 AGA 13G MISS GENERAL 141L

There's a whole lot packed into this Cabinet! Under the well-marked, yellow mossy haircoat is a striking bull who performed very, very well, sired by Zoom 18Z. (Zoom's 10 sons in 2015 avg'd 81 lbs BW, yet 8 did 108 WN indx, 7 did 104 YR indx) Check out that RFI+107, PWG +35.3, & MARB +0.17! (Ultrasound index 132 for Marbling, & #1 in Ribfat) Mom 18X is a curly coated, feminine, good-uddered cow: 2 dtrs avg BW 85 lbs, 3 sons avg'd BW 94 lbs, WN 107.2 index, YR 108.3 indx. You won't get the door shut on this one! **Retaining semen interest.**





## 112

### AGA 24W GENERAL WILEY'S 112C

C03014138 ALNK 112C APRIL 23 2015

BW:	95
205:	597
'17 EPDs	
CE:	+0
BW:	+3.8
WW:	+42.1
YW:	+77.5
MCE:	+3.6
Milk:	+25.1
TM:	+46.2

AGA 13G GENERAL 114L	GEM GENERAL 13G
<b>AGA 114L GENERAL WILEY 24W</b>	AGA 656U MISS STANDARD ET 17H
AGA 118L MISS STANDARD 2R	AGA 85J STANDARD 118L
	AGA 97J MISS RED EXTRA 203N
AGA 20J STANMORE 21M	AGA 121G STANMORE 20J
<b>AGA 21M MISS STANMORE 84T</b>	AGA 5C MISS ENERLAD 68K
AGA 53L MISS RED DOMINO 116R	AGA 22B BRIGADER 53L
	AGA 10B MISS BEAR 170M

Despite the dark photo here, 112C is actually very yellow, with a red neck and red testicles. He's a well-marked son of Wiley 24W, who has sired good offspring and really awesome females. Come on by - we can show you anytime! Let numbers do the talking for 112C: MPI 130.4 (Top 20%), FMI 131.2, RFI 103, PWG 35.4, & MARB +0.18 (top 20% of the breed). Don't forget the mother 84T - an easy-keeping, good fertility cow sired by 21M, who brought production, richer milk, and tighter udders (just like hers), to many herds.



## 114

### AGA 28Z SPORT COLLATERAL 114C

C03014191 ALNK 114C APRIL 24 2015

BW:	99
205:	656
'17 EPDs	
CE:	-1.9
BW:	+5.4
WW:	+47.5
YW:	+86.1
MCE:	+0.7
Milk:	+20.1
TM:	+43.9

BANNERLANE 232 EXTRA GEN 60W	BBSF 6P SPORT 232S
<b>AGA 60W BANNER SPORT ZEAL 28Z</b>	BANNERLANE GENSTAR LASS 27R
AGA 705 MISS EASYGOING 905W	CTY EASY 705T
	AGA 114L MISS STAR GENERAL 47S
CC 129D SUPERMAN 77J	FE 07Y SUPER 129D
<b>AGA 77J MISS YELLO SUPERMAN 5Y</b>	CC 42W JULIANA 66Z
AGA 101J MISS STANDARD 140P	AGA 656U STANDARD ET 101J
	AGA 22B MISS BRIGADER 511E

Looking for Collateral? Here he is! Long & correct, with a wide loin, quarters deep & thick, well-marked & pigmented eyes (one fully, the other partly), red necked, red testicles and a great performer! The older he gets, the more he performs in lbs and attractiveness! (FMI 147.8 (Top 15% of breed) and 1.07 REA/100 lbs) Dam 5Y is easy-fleshing yet maternally strong: 3 sons avg WN 106.7 index, 2 did YR 108 index, 1 dtr WN 104 index. Lonnie Kozlinski bought 114C's full brother last year, and he buys top-notch bulls!



## 115

### AGA 87W CENTURION HAMMER 115C

C03014192 ALNK 115C APRIL 24 2015

BW:	97
205:	609
'17 EPDs	
CE:	+1.1
BW:	+2.7
WW:	+29.2
YW:	+54.9
MCE:	+1.5
Milk:	+18.4
TM:	+33

LFF 5L JACK HAMMER 26R	DIAMOND-T 25J LAD 5L
<b>AGA 26R WHAM HAMMER 87W</b>	LFF 3B HI LITE EXTRA LASS 11E
AGA 44K MISS OLD DOMINO 252M	AGA 1S OLD DOMINO 44K
	AGA 102E MISS EXTRA 190K
AGA 21M STANMORE 26R	AGA 20J STANMORE 21M
<b>AGA 26R MISS STANMORE 108T</b>	AGA 91L MISS STANDARD 148N
AGA 114L MISS GENERAL 126R	AGA 13G GENERAL 114L
	AGA 97J MISS BRIGADER 75L

Here's a short-marked, curly, golden yellow son of Wham Hammer 87W, with red eyes and red testicles. The dam, 108T, is a curly, red-marked, moderate-sized cow with super production - no surprise there because she's a 21M granddaughter! So don't be surprised by 115C's very quiet demeanor - this Centurion will command results with his thickness and extra length, not to mention tremendous maternal strength!



## 122

### AGA 18Z ZOOM STAN CHAPLIN 122C

C03014357 ALNK 122C APRIL 27 2015

BW:	57
205:	534
'17 EPDs	
CE:	-0.3
BW:	+5.2
WW:	+41
YW:	+68.6
MCE:	-1.5
Milk:	+18.3
TM:	+38.8

AGA 55C STANDARD 18Y	SILVER STANDARD 55C
<b>AGA 18Y ZOOM STANDARD 18Z</b>	MISS 46E BRITISHER AGA 22L
AGA 21M MISS STANMORE 76S	AGA 20J STANMORE 21M
	AGA 101J MISS STANDARD 140P
BANNERLANE HI STANDARD 41F	MVF 656 65U STD DOMINO LAD 87D
<b>AGA 41F MISS HI STANDARD 87R</b>	BANNERLANE 56U DOM LASS 15Z
AGA 44K MISS OLD DOMINO 252M	AGA 1S OLD DOMINO 44K
	AGA 102E MISS EXTRA 190K

This Chaplin is all work & no play - he's learned to persevere! Not only was he born a twin, but his mom died suddenly 2 1/2 months later. You'd never know it now - he's a deep son of 18Z, red eyes, red neck, red testicles, & red all around. His dam, 87R, was a tremendous cow, with a spectacular udder & feet sublime. Ian Glass, of Chaplin SK bought her 1st son 83T as a herdsire, & Little Poplar Grove of Forestburg, AB bought her 66X son. The only levity you'll find here is a light BW - 122C is **recommended for heifers** - & anything else!



# ULRICH HEREFORD RANCH COMING 2'S



## 126

### AGA 19A ANDY ANCHOR 126C

C03014365 ALNK 126C APRIL 29 2015

BW:	106
205:	560
'17 EPDs	
CE:	-1.6
BW:	+5.7
WW:	+41.1
YW:	+66.6
MCE:	-1.2
Milk:	+14.8
TM:	+35.4

96 ANDY 72S	96 ANDY 7L
AGA 72S BERT'S ANDY ANCHOR 19A	96 EVE 18N
AGA 5T MISS STANMORE DOM 90W	AGA 26R STANMORE 5T
	AGA 114L MISS GENERAL 62T
AGA 13G GENERAL 114L	GEM GENERAL 13G
AGA 114L MISS GENERAL 54U	AGA 656U MISS STANDARD ET 17H
AGA 154F MISS BRITISHER 159H	AGA 37B BRITISHER 154F
	AGA 22B BRIGADER 83F

The grandsire of 126C was the 96 Andy 72S bull, owned by Bert Anderson of Sceptre, SK! He sired 19A, who in turn sired this well-put-together fellow with length, wide top, good quarters, and red testicles! The dam of 126C is very feminine with a neat level udder & comes from a great pedigree with a great maternal background. Combine that with a great Marbling score (127 index) by the ultrasound technician, and 126C will sire the kind of meat that will make meat-lovers everywhere anxious to pull out the BBQ!



## 133

### AGA 19A ANDY ANCHOR CYRUS 133C

C03015058 ALNK 133C MAY 13 2015

BW:	82
205:	537
'17 EPDs	
CE:	-0.9
BW:	+4.1
WW:	+43.2
YW:	+78.6
MCE:	+1.5
Milk:	+16.3
TM:	+37.9

96 ANDY 72S	96 ANDY 7L
AGA 72S BERT'S ANDY ANCHOR 19A	96 EVE 18N
AGA 5T MISS STANMORE DOM 90W	AGA 26R STANMORE 5T
	AGA 114L MISS GENERAL 62T
AGA 20J STANMORE 21M	AGA 121G STANMORE 20J
CFH 21M LASS 189Y	AGA 5C MISS ENERLAD 68K
CFH 699S LASS 965W	CFH 479P DANDY 699S
	BBSF 52G BONANZA LASS 263K

Looking to impress his sire 19A, 133C struts a wide top, thick & long build that very much resembles his papa! Cyrus has a great coat of hair, hooded eyes -one goggle eye and some pigment on the other - and red testicles. Add in some above avg #s to further amaze: 119.1 MPI, 147.2 FMI (top 15% of the breed) and 1.12 REA/100 lbs. 189Y was a 21M daughter that we purchased out of the Conway Dispersal sale. Conway's had purchased 21M from us, where the offspring did well for them, just like this 189Y mother of 133C.



## 135

### AGA 372A RUSTY COMRADE 135C

C03016527 ALNK 135C MAY 19 2015

BW:	103
205:	630
'17 EPDs	
CE:	-1.4
BW:	+6.3
WW:	+51.5
YW:	+93.7
MCE:	-0.6
Milk:	+21.2
TM:	+47

XTD 6T RUST TEMPEST ET 9A	FE 32P RUSTANDARD 6T
WH 9A RUST TEMPEST 372A	JT 19P LADY 95U
WICHMAN LADY 06	CHURCHILL DOMINO 6101S
	CHURCHILL LADY 04107
AGA 20J STANMORE 21M	AGA 121G STANMORE 20J
AGA 21M MISS STANMORE 110S	AGA 5C MISS ENERLAD 68K
AGA 41F MISS HI STANDARD 90P	BANNERLANE HI STANDARD 41F
	AGA 22B MISS BRIGADER 23L

Comrade will work together with you to build your herd! An excellent well-balanced bull, 135C is correct & sound, with excellent muscle, thickness, & strong performance - sired by a Justin Wichman bull, Rusty 372, which we purchased as a calf! Sire Rusty throws in a great pedigree plus milk! 135C's 145.7 FMI is top 15% of the breed, not to mention 42.2 PWG (top 6 % of the breed) with no extra feed (100 RFI EPD). Dam 110S, is sound as a kitten, and has an udder like a 1st-calver, tight with rich milk. This strong Rusty son demands a second look!



## 136

### AGA 19A ANDY ANCHOR 136C

C03016552 ALNK 136C MAY 25 2015

BW:	97
205:	577
'17 EPDs	
CE:	-0.6
BW:	+4.5
WW:	+42.7
YW:	+69.6
MCE:	+0.6
Milk:	+20
TM:	+41.4

96 ANDY 72S	96 ANDY 7L
AGA 72S BERT'S ANDY ANCHOR 19A	96 EVE 18N
AGA 5T MISS STANMORE DOM 90W	AGA 26R STANMORE 5T
	AGA 114L MISS GENERAL 62T
AGA 13G GENERAL 114L	GEM GENERAL 13G
AGA 114L MISS GENERAL 19Y	AGA 656U MISS STANDARD ET 17H
AGA 118L MISS STANDARD 2R	AGA 85J STANDARD 118L
	AGA 97J MISS RED EXTRA 203N

We're in the meat business, so ultrasound scanning should be important. It's nice to see scores like 136C's of 1.21 REA/100 lbs and above average Lean Meat Yield of 64.7. Phenotype is also important - a strong back for a long body with lots of muscle, yellow coat, hooded eyes with some red pigment and red testicles all have economic benefits. Throw in some tremendous maternal strength & udders from a complete & shining dam like 19Y, (sired by General 114L) and you've got a nice package for a beef-producing bull - 136C!



# ULRICH HEREFORD RANCH COMING 2'S



## 137

### AGA 28Z SPORT 137C

C03028709 ALNK 137C MAY 28 2015

BW:	95
205:	584
'17 EPDs	
CE:	+0.5
BW:	+2.6
WW:	+30.6
YW:	+55.5
MCE:	+0.7
Milk:	+17.7
TM:	+33

BANNERLANE 232 EXTRA GEN 60W  
**AGA 60W BANNER SPORT ZEAL 28Z**  
 AGA 705 MISS EASYGOING 905W  
 BBSF 6P SPORT 232S  
 BANNERLANE GENSTAR LASS 27R  
 CTY EASY 705T  
 AGA 114L MISS STAR GENERAL 47S  
 LLL 85A STANDARD 93D  
**AGA 93D MISS STANDARD 86R**  
 AGA 15H MISS BRITISHER 106L  
 LLL FE STD BRIT 85A  
 LLL 81R STD BRIT LASS 77W  
 46E BRITISHER AGA 15H  
 AGA 121G MISS STANMORE 134J

28Z has produced another outstanding specimen in this attractive, sound, very correct, deep son with a great haircoat & red testicles! Of course, the dam, 86R, has contributed too: Her 8 sons avg'd 105.6 WN index, 5 avg'd 105.6 YR index; 2 dtrs avg'd 114 WN index, 104 YR index. She nursed them all with an extremely nice level udder & plenty of rich milk. While getting older now, she's raised some tremendous bull calves over the years. Her maternal grandsire, 15H, produced volume & substance, udders & sound feet like 86R's, through to her son 137C.



## 138

### AGA 203Y GREGORY PETE 138C

C03028710 ALNK 138C MAY 30 2015

BW:	93
205:	579
'17 EPDs	
CE:	+4.1
BW:	+1
WW:	+39.3
YW:	+66.2
MCE:	+2.3
Milk:	+25.8
TM:	+45.5

UPS DOMINO 3027  
**GCC PETE 203Y ET**  
 LPG STANDARD 44B LASS 50H  
 CL 1 DOMINO 9126J 1ET  
 UPS MISS DIAMOND 1353  
 96 STANDARD 6A 25E  
 LPG COMMANDER 8080 LASS 59D  
 STANDRD LAD 656 4ET  
**AGA 656 MISS STANDARD ET 106M**  
 AGA 22B MISS BRIGADER 511E  
 HI STANDARD LAD 20P  
 BELL L 60H DOMINO LASS 82K  
 CTY BRIGADER 22B  
 AGA MISS 42X STANMORE 94Z

106M is the pretty mama of 138C. She's an embryo transplant with length and extra rib along with correctness. Her record is proving her well by raising 12 bull calves to above average performance at WN (avg 102 WN index) and a daughter that indexed 112 at WN! She's pretty proud of this 138C son of hers too. He's correct, with a curly haircoat, extreme muscling, quarters round and loin wide (compliments of his sire, Pete 203Y) - a stout and a half!



ALNK 22R – dam of Lot 41C



ALNK 144Y – dam of Lot 77





# ULRICH HEREFORD RANCH LONG YEARLINGS



## 501

### AGA 28Z CENTURY SPORT 501C

C03016528 ALNK 501C AUGUST 25 2015

BW:	92
205:	680
'17 EPDs	
CE:	-1
BW:	+5.2
WW:	+50.3
YW:	+82.8
MCE:	+1.7
Milk:	+23.5
TM:	+48.7

BANNERLANE 232 EXTRA GEN 60W BBSF 6P SPORT 232S  
**AGA 60W BANNER SPORT ZEAL 28Z** BANNERLANE GENSTAR LASS 27R  
 AGA 705 MISS EASYGOING 905W CTY EASY 705T  
 AGA 114L MISS STAR GENERAL 47S  
 AGA 20J STANMORE 21M AGA 121G STANMORE 20J  
**AGA 21M MISS STANMORE 76S** AGA 5C MISS ENERLAD 68K  
 AGA 101J MISS STANDARD 140P AGA 656U STANDARD ET 101J  
 AGA 22B MISS BRIGADER 511E

A Fall birth didn't phase 501C! He's got strong #'s: MPI 120.4, FMI 131.4, & feed efficiency (+103 RFI) while still gaining with the others (PWG 32.5)! That's what cattle in this Century should do! 501C is long & yellow with 1 pigmented eye, great performance, & red testicles. In 2015, the sire 28Z weaned 4 sons with avg 108.5 index, 3 with 104.3 YR index; 4 daughters with avg 113.8 WN index and avg 109 YW index. The elite, strong maternal dam, 76S, has a super udder, super feet & super cows many gens back. She's also the dam of 18Z (ref sire M)!



## 503

### AGA 18Z ZOOM STAN CHAMBER 503C

C03016530 ALNK 503C AUGUST 31 2015

BW:	60
205:	640
'17 EPDs	
CE:	+3.1
BW:	+1.9
WW:	+36.1
YW:	+53.7
MCE:	+1.6
Milk:	+21.5
TM:	+39.6

AGA 55C STANDARD 18Y SILVER STANDARD 55C  
**AGA 18Y ZOOM STANDARD 18Z** MISS 46E BRITISHER AGA 22L  
 AGA 21M MISS STANMORE 76S AGA 20J STANMORE 21M  
 AGA 101J MISS STANDARD 140P  
 AGA 22B BRIGADER 97J CTY BRIGADER 22B  
**AGA 97J MISS RED EXTRA 237M** AGA 335C MISS EXTRA 8G  
 AGA 3G MISS DON DANDY ET 135K DONORAH 412 DANDY LAD 3G  
 SNS GENERATOR'S LADY 21A

**Heifer bull** - yep, with a 60 lb BW, yet stout, correct, short-marked with mostly red eyes, red testicles, & good performance indeed! The iconic dam, 237M, now 15 yrs old has 12 calves & #13 on the way: 9 sons avg'd 109.8 WN indx, 8 avg'd 107.9 YR indx; 2 dtrs avg'd 117 WN indx & 110.5 YR indx. She's got volume & substance, curly, mossy haircoat, good markings, udder, & pigments, maternal power & pedigree (22B grandsire) & a dandy background. Robert Simkin bought her 407B son at last yr's sale. We used him 2016 & look forward to the offspring!



## 504

### AGA 28Z SPORT CHAPERONE 504C

C03016531 ALNK 504C AUGUST 31 2015

BW:	80
205:	538
'17 EPDs	
CE:	+1.3
BW:	+2.4
WW:	+35.1
YW:	+63.5
MCE:	+2
Milk:	+22.6
TM:	+40.2

BANNERLANE 232 EXTRA GEN 60W BBSF 6P SPORT 232S  
**AGA 60W BANNER SPORT ZEAL 28Z** BANNERLANE GENSTAR LASS 27R  
 AGA 705 MISS EASYGOING 905W CTY EASY 705T  
 AGA 114L MISS STAR GENERAL 47S  
 AGA 20J STANMORE 21M AGA 121G STANMORE 20J  
**AGA 21M MISS STANMORE 22T** AGA 5C MISS ENERLAD 68K  
 AGA 207N MISS SILVER 9R AGA 35J SILVER PRIDE 207N  
 AGA 53A MISS STANDARD ET 152M

Another great **heifer bull** from 28Z - 504C was 80 lbs at birth. Both parents pass red onto him - one goggle eye, red neck and red testicles, plus depth & thickness. The elite dam, 22T, comes from a pedigree of maternal strength (21M), easy-keeping, easy-finishing like her dam, 9R, yet feminine. 22T is nearly perfection. Her sons avg'd 90 lbs BW, dtrs 74 lbs. 5 sons avg'd 108.4 WN index; 2 dtrs avg'd 107.5 WN index. Her 67X son went to Bert Anderson, Sceptre, SK and 423B to Greg Barber, Leslie, SK, both purebred herds. Let 504C Chaperone your herd!





# HERD HEALTH

## CLARESHOLM VETERINARY SERVICES, LTD.

Box 2350, Claresholm AB T0L 0T0 (403) 625-3677

K. WRIGHT, DVM C. FANCY, DVM K. VANDERVALK, DVM K. MATTERS, DVM

### January 2017

Claresholm Veterinary Services Ltd. has been providing veterinary service and consultation for over 20 years to the Ulrich Hereford Ranch. The majority of the service consists of breeding soundness evaluations of the bulls and herd health consultation.

Health problems are minimized with a good vaccination program and excellent management. Calves are vaccinated with the Zoetis SelectVac Gold Plus vaccine program (the comprehensive program to protect against respiratory disease

and BVD) in the spring and fall. The replacement heifers and bulls receive Bovi-Shield Gold FP5-VL5 in the spring before breeding. The cow herd receives Bovi-Shield Gold FP5-VL5 prior to calving. Cows and heifers also receive a scour prevention vaccine annually.

*Claresholm Veterinary Services Ltd. is proud to be associated with the Ulrich Hereford Ranch and their cattle operation.*

## Thank You TO OUR SPONSORS!

### BUYER'S DRAW SPONSOR:



FOR ANIMALS. FOR HEALTH. FOR YOU.

16740 Trans-Canada Highway  
Kirkland, QC, H9M 4M7  
403.462.9972  
1.800.999.2857 Ext 2836  
steve.brander@zoetis.com  
Visit Us: zoetis.com

**Steve Brander**  
Senior Territory manager



Co-operative Limited

4424 - 2 Street E.  
P.O. Box 8  
Claresholm, Alberta T0L 0T0  
www..net

### SHELLEY O'NEIL

Agent  
Claresholm / Nanton Agency  
Skyline Petroleum Ltd.

Claresholm: (403) 625-3593  
Nanton: (403) 646-2424  
Cell: (403) 625-8952  
Fax: (403) 625-4791  
Home: (403) 625-3059



420 - 43rd Ave E, Box 667  
Claresholm, AB  
Canada T0L 0T0

Gord Lane CCA  
Crop Production Advisor

Office: 403-625-3329  
Toll Free: 1-800-661-5172  
Cell: 403-489-0407  
Fax: 403-625-4145  
E-mail: gord.lane@cpsagu.ca

### Dave Thorlakson

Business Development Manager  
Dairy/Beef



Landmark Feeds Inc

Phone : (403) 329-3192  
Cellular : (403) 308-3820  
Fax : (403) 329-8046  
Toll Free : (877) 750-2474

e-mail: dave.thorlakson@nutreco.ca

3102 - 12th Ave. N.  
Lethbridge, AB  
Canada T1H 5V1

## ALL-STAR BREEDER

We at Ulrich Herefords are pleased to have been awarded the status of Five-Star Breeder, the highest possible, and 1 of only 42 operations across Canada to do so! This simply means that we have completely & accurately reported 5 traits: Calving Ease, Birthweights, Weaning Weights, Yearling Weights and Ultrasound on our entire calf crop.





# BUYER'S NOTES

.....

.....

.....

.....

.....

.....

.....

.....

.....

.....

.....

.....

.....

.....

.....

*(important to understand is that zero is not "average")*

Hereford Breed AVERAGES EPDs for Calves born from 2015-2016	CE (%)	BW (lbs)	WW (lbs)	YW (lbs)	Milk (lbs)	TM (lbs)	MCE (%)	SC (cm)	CW (lbs)	Stay (%)	MPI	FMI	RFI	PWG (lbs)	REA (in2)	FAT (in)	MARB
	1.3	3.2	50.0	80.0	22.0	36.0	1.5	0.9	88.0	-0.3	111.4	124.0	101.4	30.7	0.34	0.005	0.09





## WHAT IS AN EPD?

**Expected Progeny Differences (EPDs)** are genetic predictions producers can use when making selection decisions. These values are available on performance animals from breed associations. ***It is important to understand you cannot compare EPDs between breeds, only within a breed.*** A buyer is always advised to use more than just the EPDs regardless of accuracy when making purchase decisions.

An Expected Progeny Difference (EPD) is a measure of the genetic merit of an animal using relevant performance and pedigree information. EPDs are expressed in the units of measure. For example, birth weight is expressed in pounds, and rib-eye area is expressed in square inches.

EPDs come from performance data. Producers submit data on their cattle. From this data, researchers look at the differences between animals raised in the same environment (contemporary groups) and ascertain the portion of that difference that is due to genetics (heritability). Also included in this is how the different traits relate to each other and interact together (correlations). They can then directly compare genetic differences among animals using the pedigree information contained in the CHA and AHA registries. The result is a value that can be directly compared between animals and across environments, an EPD.

### EPD'S USED IN THIS CATALOGUE

**Calving Ease EPD (CE)** - calculated using birth weight and calving ease score information. Calving ease EPDs represent the ease with which progeny of an animal are born to first calf heifers. The EPD is expressed as a percent probability, with a higher value representing calves with a higher probability of being born unassisted.

**Birth Weight EPD (BW)** - is an indicator of calving ease. Higher birth weight EPDs usually indicates more calving difficulty.

**Weaning Weight EPD (WW)** - reflects progeny growth differences up to 205-days.

**Yearling Weight EPD (YW)** - reflects progeny growth differences through to 365-days.

**Milk EPD (Milk)** - indicates the ability of a sire's daughters to provide their calves with an environment that encourages growth from birth to weaning, through mothering ability and milk production. This EPD is expressed in the expected difference in pounds of calf at weaning.

**Total Maternal EPD (TM)** - also known as Milk + Growth, this EPD combines the milk EPD plus 1/2 the Weaning Weight EPD. It is expressed in pounds of calf weaned at 205-Days and combines the genetics for pre-weaning growth and the influence of the maternal environment on the weaning weight of the daughter's progeny.

**Maternal Calving Ease EPD (MCE)** - represents the ease with which a sire's daughters will calve as first calf heifers, when compared to daughters of other sires. The EPD is expressed as a percent probability, with a higher value representing daughters with a higher probability of unassisted calving.

### COMPARABILITY OF EPD'S

EPDs from Hereford animals are directly comparable to other Herefords in North America and parts of South America, due to the inclusion of data from Canada, United States, Uruguay & Argentina. As well, it is important to remember that Hereford EPDs are NOT directly comparable to EPDs produced by different breeds, such as Angus or Simmental.



## • BALOG AUCTION SERVICES INC. •

PO Box 786, Lethbridge, Alberta, T1J 3Z6

Phone (403) 320-1980 Fax (403) 320-2660

*Welcome Cattlemen,*

*Wow - What a tremendous set of bulls to sell from Peter Ulrich!!*

*Uniformity plus! - Outstanding EPD numbers and like always a strong emphasis to the maternal traits of calving ease & milk.*

*The premier herd of performance testing*

*Don't miss this opportunity - buy an Ulrich bull and move your program up the ladder*

*Respectfully*

*R.C. (Bob) Balog*



*Coyote*  
PUBLISHING

Catalogue Design by  
**Coyote Publishing**  
Ph: 403.394.4481  
[www.coyotepub.com](http://www.coyotepub.com)



# ULRICH HEREFORD RANCH INC.

Box 843, Claresholm, AB T0L 0T0

CANADA POSTES  
POST CANADA



Postage paid  
Addressed  
Admail  
8412225

Port payé  
Médiaposte  
avec adresse



**WWW.ULRICHHEREFORDS.COM**

PRINTED IN CANADA / FOR FREE DISTRIBUTION